

Speed limiter

SPEED LIMITER OVERVIEW

⚠ WARNING

The speed limiters are driving aids only. It remains the driver's responsibility to drive with due care and attention, in a manner which is safe for the vehicle, its occupants and the other road users.

There are two Speed limiter systems: Automatic Speed Limiter (ASL) and Intelligent Speed Limiter (ISL).

When active, ASL allows a speed to be set that the driver does not wish to exceed.

When active, ISL restricts the vehicles maximum speed to the currently applicable road speed limit. The speed limit information is provided by the Navigation system and Traffic sign recognition.

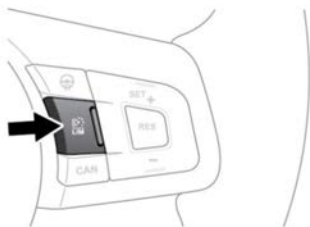

To switch between Speed limiter and Cruise control, press the **LIM** button on the steering wheel. These systems cannot be used simultaneously.

NOTICE

When the vehicle's ignition is switched on, the previous state, either Cruise control or a Speed limiter system, will automatically be selected.

When in Speed limiter mode, to select either system, press and hold the **CAN** button on the steering wheel. The ASL indicator lamp will illuminate when ASL is selected, see **54, AUTOMATIC SPEED LIMITER (AMBER)**. The ISL warning lamp will illuminate when ISL is selected, see **55, INTELLIGENT SPEED LIMITER (ISL) (AMBER)**.

Either system can also be selected via the Instrument panel menu (see **47, INSTRUMENT PANEL MENU**).

Note: *Dependent on the vehicle's specification, the speed limiter set-point will be displayed as a marker on the speedometer or a numeric display in the Message center. The limiter set-point can also be displayed in the Head-up display, if enabled. See **50, HEAD UP DISPLAY**.*

AUTOMATIC SPEED LIMITER (ASL) CONTROLS

⚠ WARNING

In certain conditions, such as a steep downhill gradient, the vehicle's speed may exceed the set-speed limit. This is because engine braking is unable to maintain or reduce the vehicle's speed.

Note: *Automatic Speed Limiter (ASL) only operates at speeds between 19 mph (30 km/h) and the vehicle's maximum speed. The speed limit can be set while the vehicle is moving or stationary.*

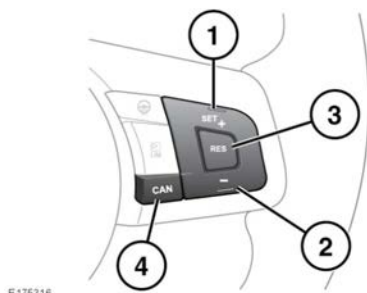

1. **SET+:** Press to set or increase the speed limit. The set-speed limit will be displayed in the Message center.
When a speed has been set, the engine will respond normally, up to the set-speed.
2. Press (-) to decrease the speed limit. The set-speed limit will be displayed in the Message center.
3. **RES:** Press to resume ASL assistance. ASL will only resume if the vehicle's speed is less than the set-speed or 19 mph (30 km/h) above the set-speed.
4. **CAN:** Press to suspend ASL assistance. ASL will be suspended until the **SET+** or **RES** button is pressed.

Note: ASL can also be temporarily suspended by pressing the accelerator pedal to the floor (kick-down). ASL will then be suspended until the vehicle's speed drops below the limiter set-point.

INTELLIGENT SPEED LIMITER (ISL) CONTROLS

⚠ WARNING

The ISL system is a driving aid only. It remains the driver's responsibility to drive with due care and attention, in a manner which is legal, safe for the vehicle, its occupants, and the other road users. The driver should still observe all other road signs, road markings and situations that are not detected or recognized by the Traffic sign recognition system.

⚠ WARNING

In certain conditions, such as a steep downhill gradient, the vehicle's speed may exceed the set-speed limit. This is because engine braking is unable to maintain or reduce the vehicle's speed.

ISL uses the speed limit information provided by the Traffic sign recognition system and the Navigation system. If a valid speed limit is not available, ISL will be deactivated and the limiter will default to ASL.

When ISL is active and limiting, and the speed limit detected is higher than the vehicle's current speed, the vehicle will immediately begin to accelerate to the new upper limit, provided there is sufficient accelerator pedal input from the driver. If the **RES** button is pressed before the vehicle reaches the new limit, the vehicle will accelerate at a faster rate.

When ISL is active and the speed detected is lower than the vehicle's current speed, the vehicle will immediately begin to decelerate to the new lower limit (within the limitations already mentioned on its ability to decelerate). If the **RES** button is pressed before the vehicle reaches the new limit, the vehicle will decelerate at a faster rate.

Speed limiter

Pressing the accelerator to the floor (kick-down) will override ISL.

If the vehicle's speed exceeds the speed limit by more than 2 mph (3.5 km/h) (for example, the vehicle gains momentum going down a hill) a warning will be displayed in the Message center. If the driver does not respond, when the vehicle's speed exceeds the speed limit by more than 5 mph (7 km/h) for 4 seconds, a chime will sound.

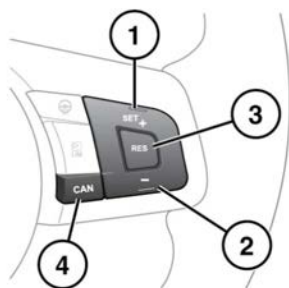

1. SET+: Press to increase the speed limit's set-point in increments, up to a maximum of 6 mph (10 km/h) over the legal speed limit.
Press and hold the button to set the maximum offset above the legal speed limit.

2. Press (-) to decrease the speed limit's set-point in decrements, by up to a maximum of 6 mph (10 km/h) below the legal speed limit.
Press and hold the button to set the maximum offset below the legal speed limit.

Note: *Adjustments made to the speed limit's set-point will be set until the ignition is switched off. Changing from ISL to ASL and back, will reset the applied offset settings.*

3. RES: Press to activate ISL for the first time in a driving cycle. ISL will be in stand-by mode until the **RES** button is pressed.

- When the vehicle is accelerating to a higher speed limit, press the **RES** button to increase the acceleration speed.
- When the vehicle is decelerating to a lower speed limit, press the **RES** button to increase the deceleration speed.
- Pressing the **SET+** button will also activate ISL.

4. CAN: Press to put ISL into stand-by mode.
ISL system limitations:

- Speed limiters are convenience features. This does not remove the driver's responsibility to adhere to the legal speed limit.
- The system can only be as accurate as the Traffic sign recognition/Navigation systems and is only available when Traffic sign recognition is sending out valid speed limit information. Always make sure the Navigation system information is up-to-date. See **159, NAVIGATION SD CARD**.
- When there is no valid speed limit information, the speed limit icon will be replaced with three dashes (- - -). ISL will be deactivated and the limiter will default to ASL. In this case, the driver has to reactivate ISL by pressing and holding the **CAN** button (4) or via the Instrument panel menu.
- Speed limits will be recognized a maximum of 98 ft (30 metres) before passing a speed limit sign.
- The vehicle's deceleration is limited to engine braking. When dropping the vehicle's speed to below a decreasing speed limit, the driver should also apply the brakes.

- ISL will only respond to a maximum speed limit of 80 mph (130 km/h). For any reported speed limits from Traffic sign recognition above 80 mph (130 km/h), ISL will set the limiter speed to unlimited.

Note: *The same limit is set for all markets.*

- The lowest possible speed limit set-point is 19 mph (30 km/h). Any speed limits below this speed will result in the vehicle's speed being set at 30 km/h (19 mph). A message in the Message center will state, **SETPOINT OUT OF RANGE**.

ISL will operate with a lowered performance/accuracy if:

- The visibility of the forward-facing cameras (located above the rear-view mirror) are obstructed, for example, with stickers, debris, mud, etc.
- The visibility of the forward-facing cameras is impaired due to severe weather conditions, for example, heavy rain, fog, snow, ice, etc.
- If the Navigation system is not operating correctly, due to a missing/broken SD card for example.
- The navigation/map data is not up-to-date.