

USING THE PARKING AID

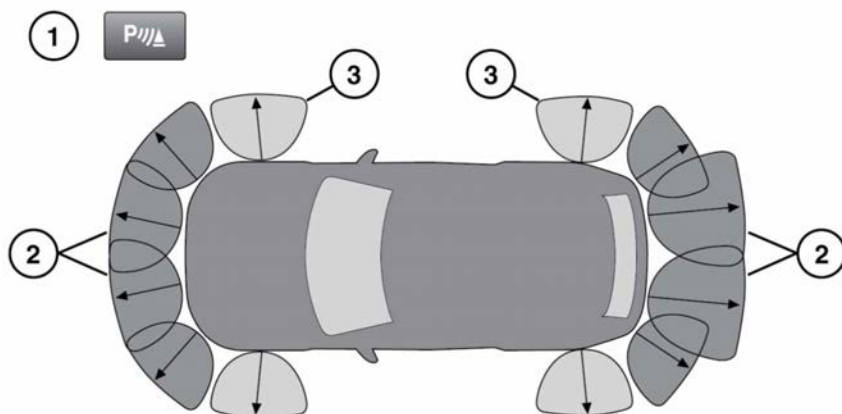

E174961

1. Parking aid switch. Located next to the Touch screen.
2. Parking aid sensor detection zones.
3. 360° Park Distance Control sensor detection zones.

⚠ WARNING

Parking aid and 360° Park Distance Control sensors will not detect moving objects, such as children and animals, until they are dangerously close. Always use extreme caution when maneuvering.

NOTICE

The Parking aid and 360° Park Distance Control sensors may not detect some obstructions, for example, narrow posts or small objects close to the ground.

NOTICE

If accessories, for example, a bicycle rack, are fitted to the rear of the vehicle, particular care must be taken when reversing. The rear sensors will indicate only the distance from the bumper to the obstacle.

The Parking aid and 360° Park Distance Control systems assist the driver while maneuvering the vehicle in confined spaces. When active, object tracking along the front, side, and rear of the vehicle are displayed on the Touch screen. The 4 corner sensors provide the 360° Park Distance Control monitoring along the vehicle sides. While the vehicle is passing an object that is within sensor range, the vehicle's integrated systems calculate its trajectory within the 360° Park Distance Control monitored area.

Parking aids

While the vehicle is stationary, the sensors will not detect an object/person approaching from the side. Also, at vehicle start-up, the vehicle has no sensor information about side objects/persons. In both of these situations, an X displays on the Touch screen in the vehicle's blind spots.

The front, side, and outer rear sensors monitor a 4 ft (1.2 m) area around the vehicle. The inner rear sensors monitor a 6 ft (1.8 m) area at the rear of the vehicle.

The Parking aid system automatically activates when Reverse (R) gear is selected, then the front, rear, and side sensors are activated. The sensors remain active until the vehicle's speed reaches 10 mph (16 km/h).

If a forward gear is subsequently selected, the front, rear, and side sensors remain active until the vehicle's speed reaches 10 mph (16 km/h).

By pressing and holding the Parking aid switch (1) for 3 seconds, the Parking aid system enters into an Auto-on mode, activating the front and side sensors when the vehicle's speed decreases to less than 6 mph (10 km/h), in a forward direction. The Parking aid switch LED lamp illuminates to confirm. Auto-on mode remains active after the ignition is switched off and on again. To disable the Auto-on mode, press and hold the Parking aid switch for three seconds. The Parking aid switch LED lamp flashes to confirm.

Note: The Parking aid system is always temporarily disabled if the vehicle's speed exceeds 10 mph (16 km/h).

When objects are detected, the system emits a warning tone, which increases in frequency as the vehicle gets closer to an object. The tone becomes constant when the object is within 12 in (300 mm) of the vehicle.

Note: The warning tone stops when the distance between the vehicle and the object remains constant.

Note: If the Parking aid system does not detect an object likely to come into contact with the vehicle, it does not display any tracking information on the Touch screen.

Note: The sensors must be kept clean to maintain accuracy and performance. See 195, **SENSORS AND CAMERAS**.

PARKING AID SYSTEM FAULT

If a system fault is detected, a long high-pitched tone is emitted and the switch indicator flashes. Also a graphic and the message **Parking Aid is not available. Please consult your dealer** is displayed on the Touch screen. Contact a Retailer/Authorized Repairer as soon as possible.

REAR CAMERA

WARNING

It remains the driver's responsibility to detect obstacles and estimate the vehicle's distance from them when reversing.

NOTICE

Some overhanging objects or barriers which could cause damage to the vehicle, may not be detected by the camera.

NOTICE

The camera must be kept clean and free from debris or obstructions, for example, stickers, debris, leaves, mud, snow, ice, frost, or insects. Failure to keep the camera clean may result in miscalculation or false indications.

The Rear camera, located above the rear license plate, provides a rear-view image to assist in reversing the vehicle.



E174962

When Reverse (R) gear is selected, the Touch screen automatically displays a wide-angle, color image from the rear of the vehicle.

Note: Vehicles with a Surround camera system can also split the screen's rear-view image, to also display a 360° view. See 120, **TOUCH SCREEN CONTROLS**.

The Rear camera provides a rear-view image to assist in reversing the vehicle. Overlaid on the image are reversing guide lines and an indication of which sensors are active.

Note: The Rear camera display has priority over the Parking aids display. To cancel the Rear camera display at any time, press the **Home menu** button or touch the back soft key.

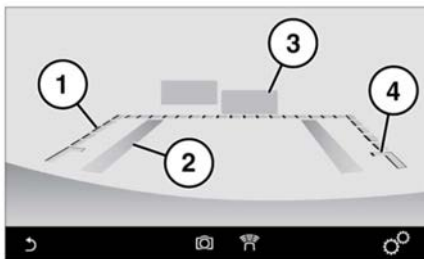

E164947

1. Dotted line: The safe working width of the vehicle (including the exterior mirrors).
2. Solid line: The projected path, based on the current steering wheel position.

3. Parking sensor activation: A colored area appears, to indicate which rear sensor(s) has been activated.
4. Luggage compartment access guide line: Do not reverse beyond this point if access is required for the luggage area

Note: The quality of the camera views may vary in different lighting conditions.

To adjust the Rear camera settings while in Reverse (R) gear, touch anywhere on the Touch screen to display the user options.

Note: The user options menu/icon selection differs for vehicles with a Rear camera only system, or a Surround Camera system.

For vehicles fitted with only a Rear camera, touch one of the user options, followed by the back icon:



Touch to enable/disable the Park assist guidance lines.



Touch to enable/disable the sensor/s active graphics.

For vehicles fitted with a Surround camera system:

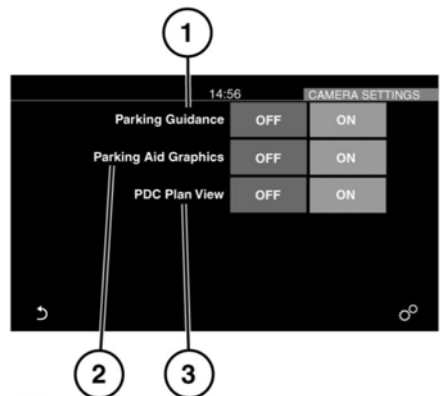

E176794

Parking aids

1. **Parking Guidance:** Select **OFF** or **ON**.
2. **Parking Aid Graphics:** Select **OFF** or **ON**.
3. **PDC Plan View:** Select **OFF** or **ON**.

The Rear camera display on the Touch screen will discontinue when either of the following apply:

- A forward gear is selected for longer than five seconds.
- A forward gear is selected and/or the vehicle's speed is greater than 11 mph (18 km/h).

REVERSE TRAFFIC DETECTION

⚠WARNING

The Reverse Traffic Detection (RTD) system is a supplement to, not a replacement for, safe driving, good observation and use of the exterior and rear-view mirrors.

Note: RTD is automatically disabled when a trailer is connected and when Park assist is active.

In addition to the functionality provided by the Rear camera, the RTD system provides a warning to the driver of any moving vehicle, at either side, that may pose an accident risk during a reversing maneuver.

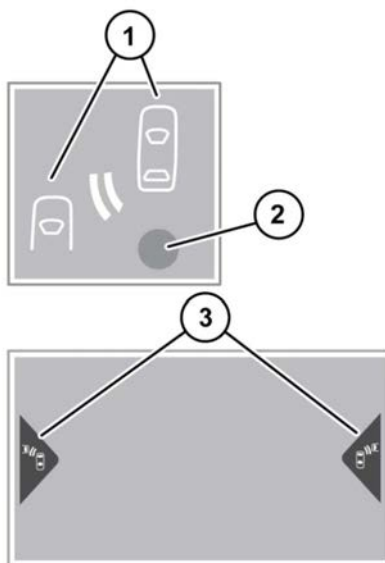

E 176268

1. The amber warning icon flashes in the relevant exterior mirror and an audible warning tone is emitted to indicate the presence of a moving vehicle.
2. When RTD is disabled, an amber dot displays in both exterior mirrors.
3. The Rear camera screen, or the Parking aid screen, displays a warning icon on the relevant side(s) of the screen.

To switch between the Rear camera and the Parking aid screen, touch the camera image or the **Cameras** icon, accordingly.

The system can be enabled or disabled via the Instrument panel menus. See **47, INSTRUMENT PANEL MENU**.

REVERSE TRAFFIC DETECTION SENSORS

The RTD system automatically disables if any of the sensors become partially or completely obscured. The amber warning indicator dot illuminates in the exterior mirrors and the message **Reverse Traffic Sensor Blocked** appears in the Message center.

Check that there is nothing obscuring the rear bumper and that it is clear from ice, frost, snow, mud, and dirt.

If a fault with a radar sensor is detected, an amber warning indicator dot illuminates in the exterior mirrors and the message **Reverse Traffic Detection System Not Available** displays in the Message center.

Note: *Even if the detected fault affects the radar sensor on only one side of the vehicle, the whole system is disabled. If the fault is temporary, the system operates correctly once the engine is switched off and then on again.*

If a fault occurs, consult a Retailer/Authorized Repairer.