

SINGLE LOCKING

WARNING

Before exiting the vehicle, always make sure that the correct gear for parking is selected, the engine is switched off, the Electric Parking Brake (EPB) is applied, and any relevant Smart key is removed from the vehicle.

Press the lock button on the Smart key briefly to lock the vehicle and activate the Perimeter alarm. The hazard warning lamps flash to confirm.

Single locking secures the vehicle and prevents the doors from being opened from the outside. The doors may still be unlocked and opened from inside the vehicle. In this state, only the Perimeter alarm is activated. See **15, PERIMETER ALARM**.

Note: *This setting should be used in circumstances, such as a ferry crossing, when pets are to be left in the vehicle, or if a window must be left open, etc.*

Note: *Always secure your vehicle when left unattended. Where possible, always secure your vehicle to the maximum available level of security.*

LOCK CONFIRMATION

If you are uncertain whether the vehicle is locked and armed, press either the Smart key lock button or, if Passive entry is fitted, touch an exterior door handle lock sensor. The hazard warning lamps flash once to indicate and confirm the current lock status.

Note: *If the vehicle is **not** already locked and armed, pressing the lock button locks the vehicle.*

AUTOMATIC RE-LOCKING AND RE-ARMING OF THE ALARM

If a door, the tailgate or the hood are not opened within 40 seconds of unlocking the vehicle via the Smart key, all of the doors will re-lock automatically to the previous locked state and the alarm will re-arm.

PERIMETER ALARM

NOTICE

No modifications or additions should be made to the anti-theft system. Such changes could cause the system to malfunction.

The Perimeter (exterior) alarm system is activated when the vehicle is Single locked. See **15, SINGLE LOCKING**.

Once activated, the alarm system will sound if:

- The hood, tailgate, or a door is opened.
- The engine **START/STOP** button is pressed without a valid Smart key present.
- The vehicle's battery is disconnected.
- An attempt is made to disconnect the alarm siren.

If the vehicle is fitted with a battery back-up sounder, the sounder will sound if the battery is disconnected, or an attempt is made to disconnect the sounder.

PASSIVE ARMING

In some markets, a Passive arming feature may be fitted. When it is enabled, it automatically arms the Perimeter alarm system 60 seconds after the driver's door is closed, provided that all of the other doors, the hood and the luggage area are also closed. The ignition must also be switched off with no valid Smart keys inside the vehicle.

Exiting the vehicle

Passive arming does not lock the vehicle, although access to the luggage area via the interior or exterior release switches is prevented.



Passive arming can be enabled/disabled by a Retailer/Authorized Repairer.

PASSIVE LOCKING

Note: The vehicle will not lock automatically.

Note: The Smart key may not be detected if it is placed within a metal container, or if it is shielded by a device with a back-lit LCD screen, such as a smart phone, laptop (including when inside a laptop bag), games console, etc. Keep the Smart key clear of such devices when attempting Passive entry, Passive locking or Keyless starting.

Note: Loose coins, in the same pocket as the Smart key, may also affect its detection.

Note: Passive locking activates only if the Smart key is detected outside of the vehicle. If no Smart key is present, no locking will occur.

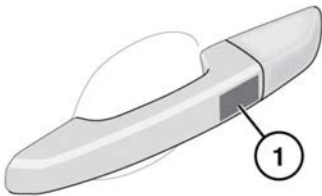

E174603

1. Lock sensor area: To lock the vehicle, touch only the lock sensor once without grabbing the door handle. The hazard warning lamps flash once to confirm locking.

Note: Do not place your fingers around the back of the handle while touching the sensor. Doing so will prevent the vehicle from locking.

Note: When locking the vehicle via Passive locking, if one or more of the doors, the hood or the tailgate is not fully closed, or the ignition is ON, the vehicle will NOT lock. There will be NO audible mislock error warning. The hazard warning lamps will NOT flash and the door mirrors (if enabled) will NOT fold in. Check that all of the doors, the hood and the tailgate are closed properly. Make sure the ignition is turned OFF and lock the vehicle again. If the mislock persists, consult a Retailer/Authorized Repairer.

BATTERY BACK-UP SOUNDER

In some markets, a separate battery back-up sounder is fitted. This device will sound the alarm if the vehicle's battery or the alarm sounder, is disconnected when the security system is armed.

DOOR LOCKS AND RELEASE LEVERS

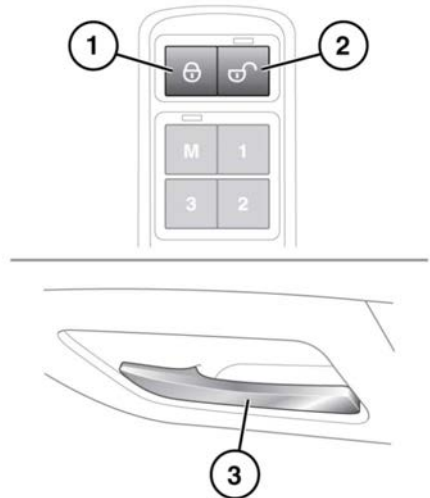

E175574

1. With all of the doors closed, press the master lock switch to lock all of the doors and the luggage area.

2. Press the master unlock switch to unlock all of the doors and the luggage area.
3. Pull the door lever to unlock/release the door. Operating the door lever on either front door unlocks all of the doors.

Note: If the vehicle is locked with the Smart key, operating an interior door release lever unlocks only that door. If the door is opened, the alarm sounds.

Note: The rear door Child safety locks inhibit the rear door lock and unlock switches, and the door release handles. See **34, CHILD SAFETY LOCKS**.

MISLOCK

When locking the vehicle with the Smart key, a mislock can occur if:

- One or more of the doors, the hood or the luggage area is not fully closed.
- The ignition is ON.
- A Smart key is left inside the vehicle.

If any of the above are present, the vehicle will NOT lock and there will be an audible mislock error warning. The hazard warning lamps will NOT flash and the door mirrors (if enabled) will NOT fold in. Check that all of the doors, the hood and the luggage area are closed properly. Make sure the ignition is switched OFF and lock the vehicle again. If the mislock persists, consult a Retailer/Authorized Repairer.

DEACTIVATING THE ALARM WHEN TRIGGERED

If the alarm has been triggered, it can be deactivated by any one of the following methods:

1. Pressing the unlock button on the Smart key.
2. Opening a door using Passive entry.
3. Pressing the **START/STOP** button with a valid Smart key positioned correctly. See **82, KEYLESS START BACKUP**.

The cause of the last alarm activation can be displayed in the Message center. See **47, INSTRUMENT PANEL MENU**.

EMERGENCY LOCKING

In the event of the battery discharging, or a fault with the locking system, each of the doors must be locked manually.

The emergency key blade is required for this procedure. See **7, UNLOCKING THE VEHICLE**.

Note: Do not leave the emergency key blade in the vehicle at any point during the emergency locking procedure.

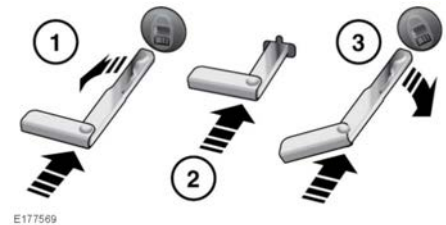

1. Open a door and locate the emergency lock access cover on the edge of the door. The cover has an embossed lock icon. Insert the emergency key blade into the cover slot, rotate the cover counter-clockwise to first release it, then pull to remove it from the door. Keep the lock access cover safe.
2. Insert the emergency key blade firmly into the emergency lock. A firm push activates the door locking mechanism. Remove the emergency key blade.
3. Refit the emergency lock access cover and rotate it clockwise to secure it firmly.
4. Close the door and check that it is locked.

Exiting the vehicle

Repeat the procedure for all other unlocked doors.