

Vehicle battery

BATTERY WARNING SYMBOLS



Do not allow open flames or other sources of ignition near the battery, as the battery may emit explosive gases.



Make sure when working near or handling the battery, suitable eye protection is worn, to protect the eyes from acid splashes.



To prevent risk of injury, do not allow children near the battery.



Be aware that the battery may emit explosive gases.



The battery contains acid which is extremely corrosive and toxic.



Consult the handbook for information, before handling the battery.

CALIFORNIA PROPOSITION 65 SECOND WARNING STATEMENT

⚠️ WARNING

Batteries, battery posts, terminals, and related accessories contain lead and lead compounds, and other chemicals known to the State of California to cause cancer and birth defects or other reproductive harm. Wash hands after handling.

BATTERY CARE

⚠️ WARNING

If battery electrolyte comes into contact with your eyes, skin, or clothes, you should remove the affected clothing and flush the skin/eyes with large amounts of clean water. Seek medical assistance immediately.

⚠️ WARNING

If swallowed, battery electrolyte can be fatal, seek medical assistance immediately.

⚠️ WARNING

Do not connect any 12 volt equipment directly to the battery terminals. Doing so may cause a spark, which can result in an explosion.

⚠️ WARNING

The cell plugs and vent pipe must be in place at all times when the battery is connected to the vehicle. Make sure the vent pipe is clear of obstructions and not kinked. Failure to do so may cause a pressure build-up in the battery, resulting in an explosion.

⚠️ WARNING

Do not expose the battery to an open flame or spark as the battery produces explosive, flammable gas.

⚠️ WARNING

Never jump start (boost), charge, or try to start a vehicle with a frozen battery. Doing so can result in an explosion.

WARNING

Remove all metal jewelry before working on, or near, the battery, and never allow metal objects or vehicle components to come into contact with the battery terminals. Metal objects can cause sparks, and/or short circuits, resulting in an explosion.

WARNING

Do not allow the battery posts or terminals to come into contact with your skin. They contain lead and lead compounds which are toxic. Always wash your hands thoroughly after handling the battery.

Your vehicle is fitted an Absorbed Glass Matt (AGM) battery.

Note: AGM batteries are sealed for life and require no maintenance.

NOTICE

Do not attempt to open or remove the top from an AGM battery.

CONNECTING JUMP LEADS

WARNING

Remove all metal jewelry before working on, or near, a battery or boost terminals. Never allow metal objects or vehicle components to come into contact with the battery or boost terminals. Metal objects can cause sparks, and/or short circuits, resulting in an explosion.

WARNING

Do not allow the battery posts or terminals to come into contact with your skin. They contain lead and lead compounds which are toxic. Always wash your hands thoroughly after handling the battery.

WARNING

Do not expose any battery to an open flame or spark, as the battery produces explosive, flammable gas.

WARNING

Do not connect the jump leads to any battery terminal on this vehicle. Doing so may cause a spark, which can result in an explosion. It may also result in damage to the charging system.

WARNING

Never jump start (boost), charge, or try to start a vehicle with a frozen battery. Doing so can result in an explosion.

WARNING

Rotating parts of the engine can cause serious injury. Take extreme care when working near rotating parts of the engine.

WARNING

Before attempting to start a vehicle, make sure that the Electric Parking Brake (EPB) is applied, or suitably chock the wheels. Make sure that Park (P) is selected.

WARNING

Suitable eye protection must be worn when working in the area of a battery.

WARNING

During normal use, batteries emit explosive gas sufficient to cause severe explosions and capable of causing serious injury - keep sparks and open lights away from the battery.

NOTICE

Make sure there is no physical contact between the donor and disabled vehicles, other than the jump leads.

Vehicle battery

NOTICE

Make sure that any battery or starting aid is a 12 volt device.

NOTICE

Disconnect the jump leads before operating any electrical equipment.

Note: Before connecting the jump leads to the disabled vehicle's boost point terminals, make sure that the donor vehicle's boost point connections are correct and that all electrical equipment has been switched off.

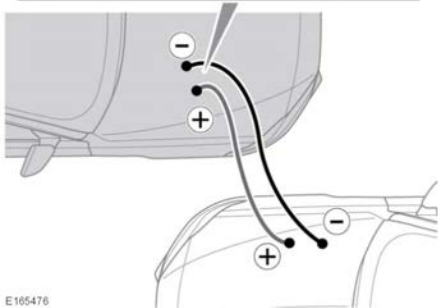
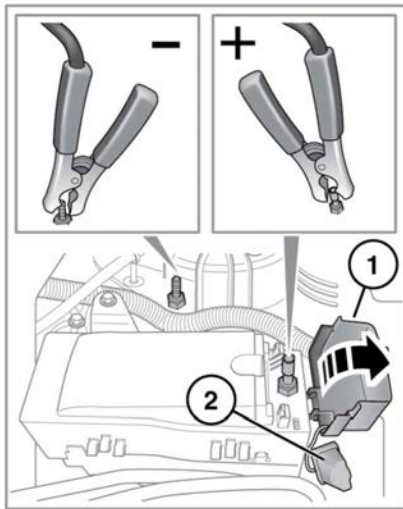

E165476

Open the hood and locate the engine compartment front fuse box. See **211, FUSE BOX LOCATIONS**.

1. Release the boost terminal lid, located on the end of the engine compartment fuse box.
2. Release the boost terminal cover, and set aside.

The following procedure should be used to connect and disconnect the jump leads:

1. Connect one end of the positive (Red) jump lead to the positive boost terminal on the donor vehicle.

Note: Refer to the donor vehicle's handbook for the recommended boost terminal location.

2. Connect the other end of the positive (Red) jump lead to the disabled vehicle's positive boost point terminal.
3. Connect one end of the negative (Black) jump lead to the negative boost terminal on the donor vehicle.

Note: Refer to the donor vehicle's handbook for the recommended boost terminal location.

4. Connect the other end of the negative (Black) jump lead to the disabled vehicle's negative boost point terminal.

Note: Check that all cables are clear of any moving components, and that all 4 connections are secure.

5. Start the engine of the donor vehicle, and allow it to idle for a few minutes.
6. Start the engine of the disabled vehicle.

Note: Do not switch on any electrical circuits on the previously disabled vehicle, until after the jump leads have been removed.

7. Allow both vehicles to idle for a few minutes.
8. Switch off the donor vehicle.
9. Disconnect the negative (Black) jump lead from the disabled vehicle.
10. Disconnect the negative (Black) jump lead from the donor vehicle.
11. Disconnect the positive (Red) jump lead from the disabled vehicle.
12. Disconnect the positive (Red) jump lead from the donor vehicle.

Refit the positive boost point terminal access covers and close the hood.

CONNECTING A STARTING AID

To start the vehicle using a starting aid or a slave battery, follow the instructions in the sequence given:

1. Connect the positive (Red) jump lead to the vehicle's positive boost point terminal.
2. Connect the negative (Black) jump lead to the vehicle's negative boost point terminal.
3. Switch on the starting aid.
4. Start the engine and allow it to idle.
5. Disconnect the negative (Black) jump lead from the vehicle's boost point terminal.
6. Switch off the starting aid.
7. Disconnect the positive (Red) jump lead from the vehicle's boost point terminal.

REMOVING THE VEHICLE BATTERY

Special tools are required to refit the battery after removal, therefore, battery removal and refit should be carried out only by qualified personnel. Consult your Retailer/Authorized Repairer.

CHARGING THE VEHICLE BATTERY

If the vehicle's battery should require charging, the battery must be removed from the vehicle. Consult a Retailer/Authorized Repairer.

WARNING

Battery disconnection, removal and replacement should be carried out only by qualified personnel. Consult a Retailer/Authorized Repairer.



Used batteries must be disposed of correctly as they contain a number of harmful substances. Seek advice on disposal from a Retailer/Authorized Repairer and/or your local authority.

REPLACING THE VEHICLE BATTERY

If the vehicle's battery should require replacing, the battery must be removed from the vehicle. Consult your Retailer/Authorized Repairer.

WARNING

Battery disconnection, removal and replacement should be carried out only by qualified personnel. Consult your Retailer/Authorized Repairer.



Used batteries must be disposed of correctly as they contain a number of harmful substances. Seek advice on disposal from your Retailer/Authorized Repairer and/or your local authority.

Vehicle battery

EFFECTS OF DISCONNECTING

Disconnecting the battery can affect a number of vehicle systems, especially if there is insufficient battery power before disconnection. For example, the alarm may trigger, depending on its state when the battery was disconnected. If the alarm does sound, use the Smart key, in the normal way, to disarm the security system. The windows may need recalibrating to operate correctly.

BATTERY MONITORING SYSTEM

The Intelligent Power System Management (IPSM) continuously monitors the condition of the main vehicle battery. If excessive battery discharge occurs, the system will begin to shut down non-essential electrical systems in order to protect the battery.

If the IPSM calculates that the battery's condition is not within the set parameters, there are 2 levels of action which can be taken. Both levels have an accompanying message on the Touch screen, and in the case of the low battery warning, in the Message center.

- **Energy Management:** Will be displayed on the Touch screen if the engine is not running, and if system features are causing excessive battery discharge. After 3 minutes, the IPSM will begin shutting down the vehicle's systems. Normal system operation will resume when the engine is started.
- **Low Battery - Please Start Engine:** Will be displayed on the Touch screen and in the Message center if the engine is not running. After 3 minutes, the IPSM will begin shutting down the vehicle's systems. Normal system operation will resume when the engine is started.

NOTICE

Only start the engine if it is safe to do so.

Note: *If the message **Low Battery - Please Start Engine** is displayed, drive the vehicle for at least 30 minutes in temperatures above 32°F (0°C), or at least 60 minutes if temperatures are below 32°F (0°C). This will allow the battery to recover to an acceptable level. If normal system operation is not resumed when the engine is switched back off, the battery may not have been sufficiently charged. If safe to do so, restart the engine. If problems still exist, contact your Retailer/Authorized Repairer.*