

# Rear seats

## EXECUTIVE CLASS SEATS

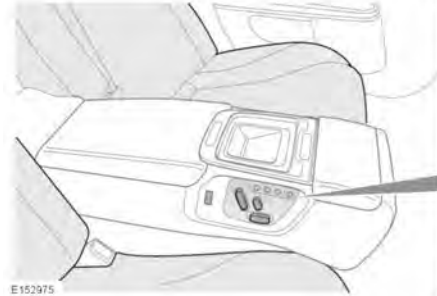

1. Lumbar support adjustment.
2. Forward and rearward seat adjustment.  
*Note: This is a 4-way switch when used to operate the front passenger seat. The switch is then used to adjust the forward and backward movement plus the raising and lowering of the seat. See item (4).*
3. Seatback angle adjustment.
4. Front passenger seat adjustment: Press to select and then use switches (2) and (3) to make the required adjustments.

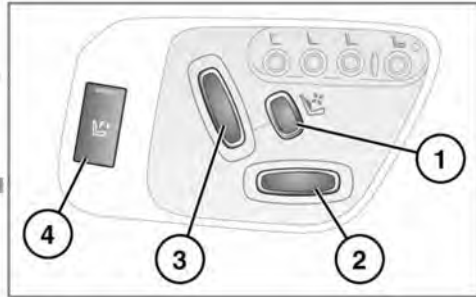

2. Memory set button.
3. Memory presets.

Once you have adjusted the rear seats (see **16, EXECUTIVE CLASS SEATS**) the vehicle can memorise these settings using the rear seat memory buttons.

1. Press the memory set button to activate the memory function.
2. Press one of the preset buttons within 5 seconds to memorise the current settings.

A seat position can only be memorised during the 5 second period.

Any existing settings for a memory preset will be over-written when programming a memory position.

## REAR SEAT POSITION MEMORY

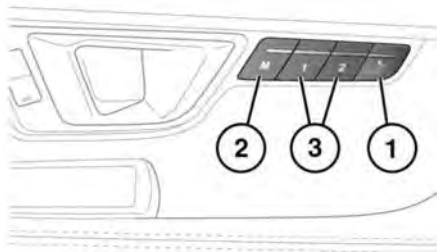

1. Press and hold the switch to return the rear seat to the home position to allow easier entry and exit.

## REAR SEAT MASSAGE

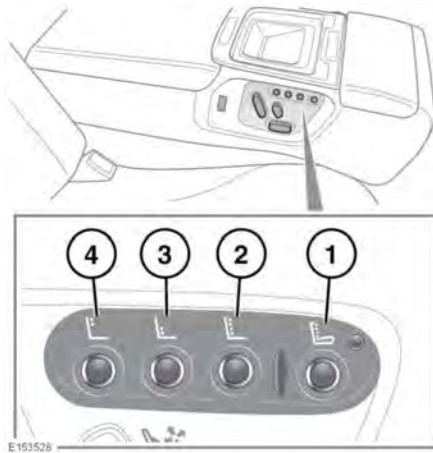

1. Massage: Press to switch the massage function on/off.
2. Press to select rolling wave.
3. Press to select lumbar wave.
4. Press to select shoulder wave.

**Note:** The massage programs have a 10 minute cycle, which will need to be re-selected for repeated use.

The Rear seat massage can also be set via the front Touch screen and rear seat screens. See **142, SEAT MASSAGE**.

## REAR SEAT SCREEN - SEAT COMFORT

The rear seat heating or cooling temperature and rear seat massage can all be controlled from the rear screens. See **141, SEAT COMFORT AND ADJUSTMENT**.

## FOLDING TABLE

**⚠** If the vehicle is involved in an accident, or subject to sudden braking or direction change, loose items on the table can cause serious injury.

**ⓘ** Stow the table when not in use.

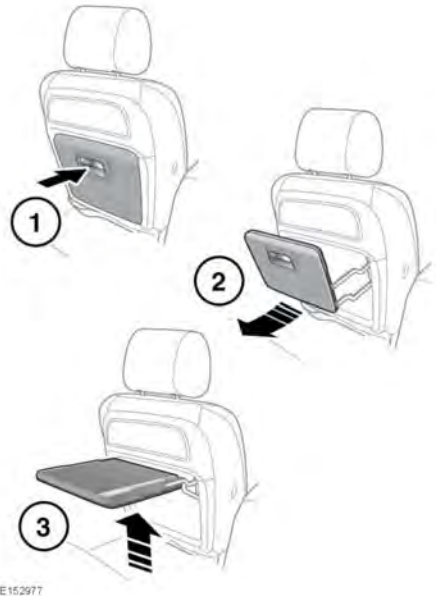

To open the table: Pull the table by the handle (1) and then pull the underneath front edge of the table (2) to guide it in to its final horizontal position (3).

To close the table: Pull the front edge underneath of the table down and then push the table into the closed position.

## REAR SEAT SAFETY

**⚠** Never allow passengers to travel in the luggage compartment under any circumstances.

## Rear seats



**All vehicle occupants should be seated correctly, and wear a seat belt at all times when the vehicle is in motion.**



Do not cover the ventilation vents located in the parcel shelf behind the rear head restraint.