

## REPLACING THE REMOTE BATTERIES

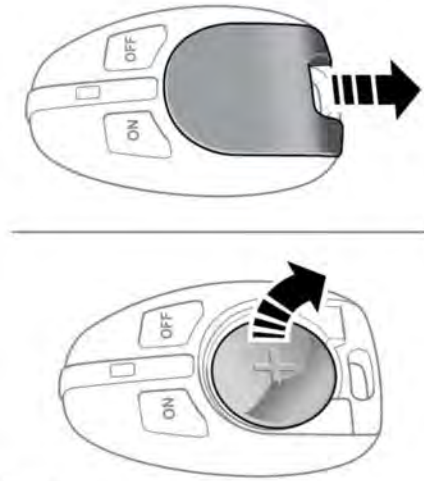

E164036

With the front of the remote control facing upwards, press down on the rear of the access cover and push completely off to reveal the battery compartment. Note that the battery should be inserted with the positive side facing upwards. Remove the old battery and making sure that the correct polarity is maintained, insert a new, unused 3 volt CR2032 battery. Align and push the cover back to the original position.