

REMOVING THE DETACHABLE TOW BALL

Remove the detachable tow ball as follows:

1. Insert the key and turn it counter-clockwise to unlock.
2. Remove the key, then supporting the tow ball, press and turn the locking lever away from you to release.
3. Remove the tow ball from the tow bar and stow it in the luggage compartment's stowage area.

POWERED TOW BALL

Before activating the powered tow ball, make sure that:

- Any trailer is unhitched.
- Any trailer electrical connections are disconnected.
- The vehicle is stationary.
- The luggage compartment lid is open.
- The vehicle's transmission is engaged in Park (P) or neutral.

Failure to comply with the above conditions will prevent the powered tow ball from operating. Also a short warning tone will sound if the powered tow ball button is pressed.

Note: If the powered tow ball does not function correctly, refer to a Retailer/Authorised Repairer.

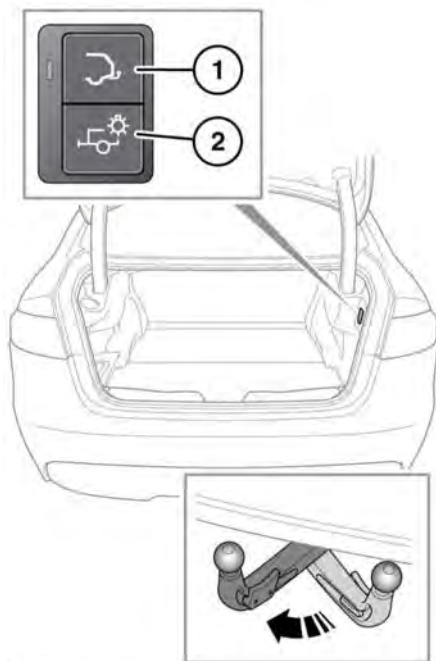

E176531

The powered tow ball can also be stowed/ deployed via the tow bar extra feature in the Touch screen. See **77, EXTRA FEATURES**. Follow the on screen instructions. This feature can also perform a trailer bulb check and calculate the current nose weight of a connected trailer.

1. Powered tow ball button: Press and release to deploy the powered tow ball. Press and release again to stow the powered tow ball.
 - The LED indicator lamp, by the side of the button, will flash slowly while the powered tow ball is being deployed or stowed. An audible tone will also sound.
 - Once deployed, the LED indicator lamp will stop flashing and will be solidly lit.