

# Entering the vehicle

## UNLOCKING THE VEHICLE

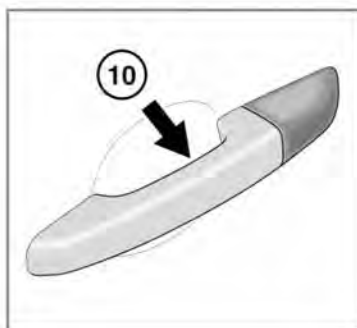
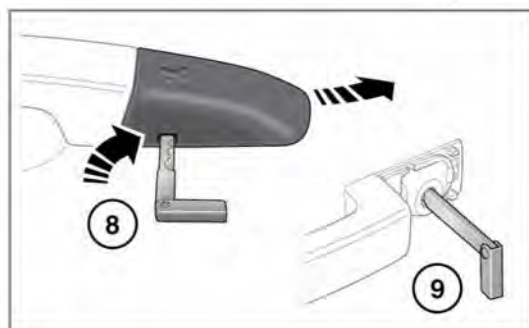
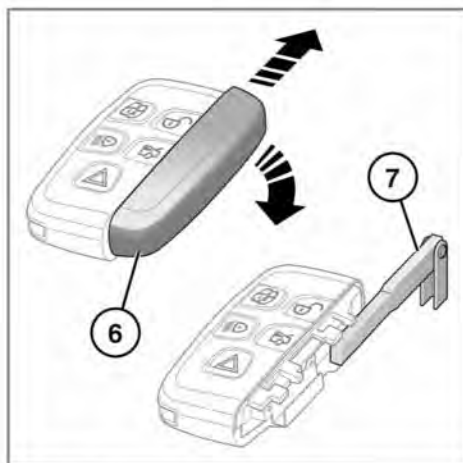
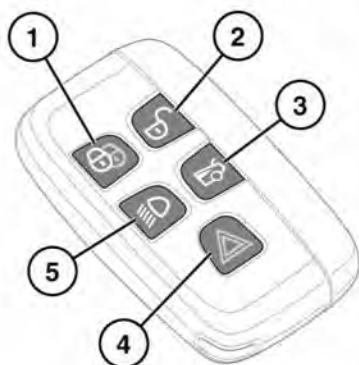

Any person fitted with an implanted medical device should make sure that the device is kept at a distance of at least 22 cm away from any transmitter mounted in the vehicle. This is to avoid any possibility of interference between the system and the device.

Interference may cause the implanted medical device to malfunction, causing serious injury or death. For more information on the locations of the security system transmitters, see 268, **SMART KEY TRANSMITTER LOCATIONS**.



To prevent accidental or unauthorised operation, never leave children or animals unattended in the vehicle. The vehicle can be operated when the Smart key is inside the vehicle.

**Note:** The operational range of the Smart key will vary considerably, depending on atmospheric conditions and interference from other transmitting devices.

**Note:** If any door, or the Luggage compartment, is unlocked 10 times within a short period, the latch is disabled for approximately one minute.

The vehicle is supplied with two Smart keys. The Smart keys act as remote controls for the locking and alarm system, and allow the vehicle to be locked, unlocked and driven without the use of a conventional key. See **9, KEYLESS ENTRY, 15, KEYLESS LOCKING**, and **102, STARTING THE ENGINE**. Each Smart key also has an emergency key housed behind a slide off cover.

1. Lock: Press to secure the vehicle. The vehicle Single locks. In some markets, a second press Double locks the vehicle. See **14, SINGLE LOCKING, 14, DOUBLE LOCKING**. If Power-fold mirrors are fitted and enabled, they fold in. See **65, EXTERIOR MIRRORS**. Press and hold to activate Global closing. See **17, GLOBAL CLOSING**.
2. Unlock: Press briefly to unlock the vehicle and deactivate the alarm. The hazard warning lamps flash twice to indicate that the vehicle is unlocked and the alarm is deactivated. The interior lamps illuminate to assist entry to the vehicle. If Power-fold mirrors are fitted and enabled, they unfold. Press and hold to activate Global opening. See **8, GLOBAL OPENING**.
3. Luggage compartment: Press briefly to release/open/close the Luggage compartment. If the vehicle is locked and armed, all other doors remain closed and the exterior alarm remains active while the vehicle is open, but intrusion and inclination sensing systems are disabled until the vehicle is closed again.

When closing, if the vehicle is already locked and armed, the hazard warning lamps flash after a few seconds to confirm that the full alarm system is reactivated. An audible sound is given when the vehicle is double locked. See **10, OPENING AND CLOSING THE LUGGAGE COMPARTMENT**.

**Note:** Make sure the Smart key does not remain in the vehicle prior to closure. It may not be detected if it is placed inside a metal container, if it is shielded by a device with a back-lit LCD screen, (e.g., laptop, smartphone, etc.), or if the vehicle is in an area of localised Radio Frequency (RF) interference. If the Smart key is not detected inside the vehicle, the vehicle allows locking to take place. The vehicle does NOT automatically unlock. The vehicle now unlocks only with another valid Smart key.

4. Panic alarm:
  - Press and hold for three seconds (or press three times within three seconds) to activate the horn and the hazard lamps.
  - Once active for more than five seconds, the alarm can be cancelled by pressing the button and holding for three seconds (or pressing three times within three seconds).
  - The panic alarm is also cancelled if a valid Smart key is present when the START/STOP button is pressed.
5. Approach illumination:
  - When approaching the vehicle during darkness, press to switch on the approach illumination. Press again to switch the approach lamps off.