

EMERGENCY LOCKING

In the event of the battery discharging, or a fault with the locking system, each of the doors must be locked manually.

The emergency key blade is required for this procedure. See **6, UNLOCKING THE VEHICLE**.

Note: Do not leave the emergency key blade in the vehicle at any point during the emergency locking procedure.

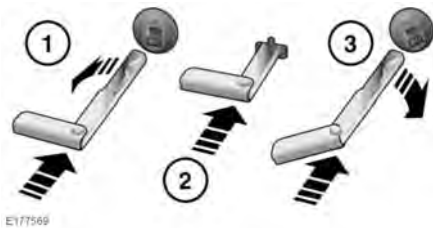

1. Open a door and locate the emergency lock access cover on the edge of the door. The cover has an embossed lock icon. Insert the emergency key blade into the cover slot, rotate the cover counter-clockwise to first release it, then pull to remove it from the door. Keep the lock access cover safe.
 2. Insert the emergency key blade firmly into the emergency lock. A firm push activates the door locking mechanism. Remove the emergency key blade.
 3. Refit the emergency lock access cover and rotate it clockwise to secure it firmly.
 4. Close the door and check that it is locked.
- Repeat the procedure for all other unlocked doors.