

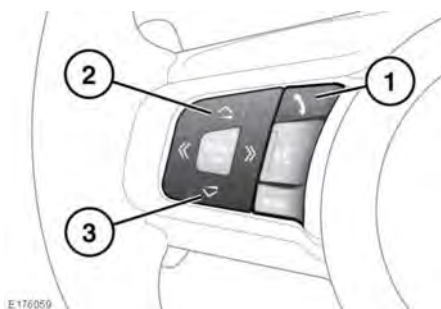

14. Settings: Touch to display the **General settings** menu. Select **PHONE**, for the following options:
 - **Announce incoming messages:** Turn on/off.
 - **Refresh phonebook:** Select to refresh the connected phone's Phonebook.
15. Touch to make or answer a call (green button), or touch to end a call (red button).

STEERING WHEEL CONTROLS



1. Press to answer an incoming call. Press to make or end a call.
2. Press to increase the volume when in a call.
3. Press to decrease the volume when in a call.

TELEPHONE SAFETY

-  **Even when using the Bluetooth hands-free feature, use of your mobile phone while you are driving is dangerous, as it diverts attention from the traffic situation. If you wish to use your phone, stop at an appropriate place where you are not endangering or inconveniencing other vehicles.**
-  **Drivers should talk on their mobile phones only when it is safe to do so and when such use will not distract the driver from the road.**



Drivers should never text message while driving. Texting while driving diverts attention from the road and can lead to accidents, causing serious injury or death.



Switch off your phone in areas with a high explosion risk. This includes filling stations, garages, fuel storage areas or chemical factories, as well as places where the air contains fuel vapour (such as an open vehicle bonnet), chemicals or metal dust. The phone could trigger an explosion, or cause a fire.



The functioning of cardiac pacemakers or hearing aids may be impaired when the phone is in use. Check with a doctor or manufacturer whether any such devices you or your passengers are using, are sufficiently protected against high-frequency energy. The Health Industry Manufacturers' Association recommends that a minimum separation of 15 cm (6 in) is maintained between a wireless phone antenna and a pacemaker, to avoid potential interference with the pacemaker. These recommendations are consistent with the independent research by, and recommendations of, Wireless Technology Research.



Always stow your phone securely. In an accident, loose items can cause injury.

CALL VOLUME

The phone call's volume is operated by the Audio system's volume control.

If the Audio system is in use when a phone call is active, the Audio system source is muted for the duration of the call.