

## TOW BALL OPTIONS

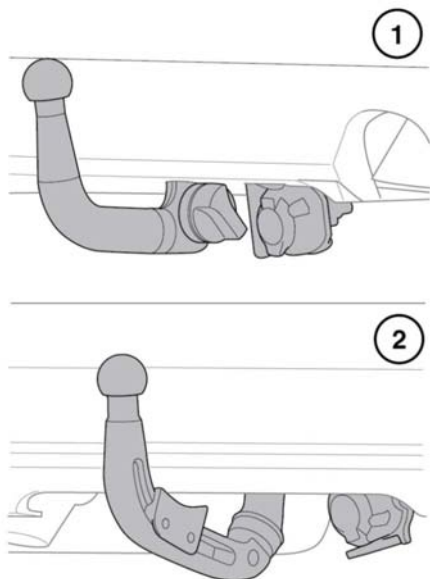

E167073

The available Tow ball options for this vehicle are:

1. Quick release, detachable tow ball. See **91, FITTING THE DETACHABLE TOW BALL.**
2. Electrically deployable, powered tow ball. See **92, POWERED TOW BALL.**

**Note:** The tow ball options are dependent on the market and the vehicle specification.

## TRAILER STABILITY ASSIST (TSA)

When a trailer is attached, TSA will automatically detect when trailer sway is developing. It will then gradually reduce the vehicle's speed, by cutting engine power and applying the brakes to help regain control.

- ⚠ The TSA will not operate in the event of the trailer jack-knifing.

- ⚠ The ability of TSA may be reduced when travelling on slippery surfaces.

**Note:** TSA will not operate when Dynamic Stability Control (DSC) is switched off.

## HITCH GUIDANCE

Hitch guidance is a user selectable Touch screen feature that can aid the process of guiding the vehicle to a trailer's tow hitch. Use Hitch guidance while reversing the vehicle to a trailer hitch.

Proceed, as follows:

1. Select reverse gear. Dependent on the vehicle's specification, the Touch screen will automatically display selectable icons or a menu list. See **124, SURROUND CAMERA SYSTEM** or see **117, REAR CAMERA.**
2. Touch the Rear camera system's **Hitch assist** icon, or for Surround camera's, tick **Hitch guidance** on the Touch screen to enable the guidance lines to be displayed.
3. Reverse the vehicle towards the trailer.
4. As the vehicle closes to within 600 mm (2 ft) of the trailer's tow hitch, an automated zoom feature is operated to enlarge the view.
5. Continue the manoeuvre carefully until the vehicle and trailer are as close as required.