

Telephone

14. Settings: Touch to display the **General settings** menu. Select **Phone**, for the following options:
 - **Announce incoming messages:** Switch on/off.
 - **Refresh phonebook:** Select to refresh the connected phone's phonebook.
15. Touch to make or answer a call (green button), or touch to end a call (red button).

STEERING WHEEL CONTROLS

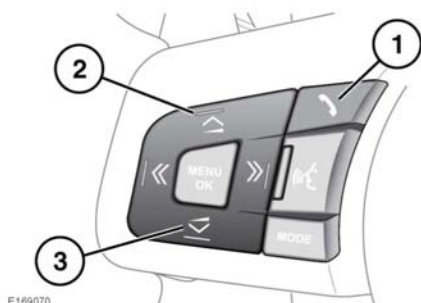

1. Press to make a call, or answer an incoming call. Press and hold to end a call.
2. Press to increase the volume when in a call.
3. Press to decrease the volume when in a call.

TELEPHONE SAFETY



Switch off your telephone in areas with a high explosion risk. This includes filling stations, fuel storage areas, or chemical factories, as well as places where the air contains fuel vapour, chemicals, or metal dust.



Always stow your mobile phone securely.



The functioning of cardiac pacemakers or hearing aids may be impaired when the phone is in use. Check with a doctor or manufacturer whether any such devices you or your passengers are using, are sufficiently protected against high-frequency energy.

The Health Industry Manufacturers' Association recommends that a minimum separation of 15 cm (6 in) is maintained between a wireless phone antenna and a pacemaker, to avoid potential interference with the pacemaker. These recommendations are consistent with independent research by, and recommendations of, Wireless Technology Research.

CALL VOLUME

The phone call's volume is operated by the Media system's volume control.

If the Media system is in use when a phone call is active, the Media system source is muted for the duration of the call.

RECEIVING TEXT MESSAGES

When a pop-up screen appears with an incoming text message, touch the **Show** button.

A screen will appear with the following options:

- **Reply:** Touch to select a screen where a reply can be entered and sent.
***Note:** This option is only available when the vehicle is stationary.*
- **Template:** Touch to select a list of replies (e.g., **Yes**, **No**, **Thank you!**, **I'll be arriving a little late**, etc.) Select the required reply.
- **Read Out:** Touch for the message to be read out as an audio message.
***Note:** Availability is dependent on the vehicle specification.*