

# Telephone

14. Settings: Touch to display the **General settings** menu. Select **Phone**, for the following options:
  - **Announce incoming messages:** Switch on/off.
  - **Refresh phonebook:** Select to refresh the connected phone's phonebook.
15. Touch to make or answer a call (green button), or touch to end a call (red button).

## STEERING WHEEL CONTROLS

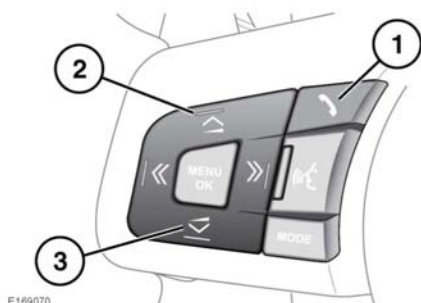

1. Press to make a call, or answer an incoming call. Press and hold to end a call.
2. Press to increase the volume when in a call.
3. Press to decrease the volume when in a call.

## TELEPHONE SAFETY



**Switch off your telephone in areas with a high explosion risk. This includes filling stations, fuel storage areas, or chemical factories, as well as places where the air contains fuel vapour, chemicals, or metal dust.**



**Always stow your mobile phone securely.**



**The functioning of cardiac pacemakers or hearing aids may be impaired when the phone is in use. Check with a doctor or manufacturer whether any such devices you or your passengers are using, are sufficiently protected against high-frequency energy.**

The Health Industry Manufacturers' Association recommends that a minimum separation of 15 cm (6 in) is maintained between a wireless phone antenna and a pacemaker, to avoid potential interference with the pacemaker. These recommendations are consistent with independent research by, and recommendations of, Wireless Technology Research.

## CALL VOLUME

The phone call's volume is operated by the Media system's volume control.

If the Media system is in use when a phone call is active, the Media system source is muted for the duration of the call.

## RECEIVING TEXT MESSAGES

When a pop-up screen appears with an incoming text message, touch the **Show** button.

A screen will appear with the following options:

- **Reply:** Touch to select a screen where a reply can be entered and sent.  
***Note:** This option is only available when the vehicle is stationary.*
- **Template:** Touch to select a list of replies (e.g., **Yes**, **No**, **Thank you!**, **I'll be arriving a little late**, etc.) Select the required reply.
- **Read Out:** Touch for the message to be read out as an audio message.  
***Note:** Availability is dependent on the vehicle specification.*