

# Entering the vehicle

## UNLOCKING THE VEHICLE

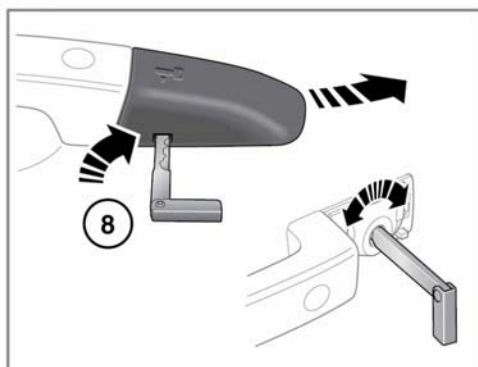
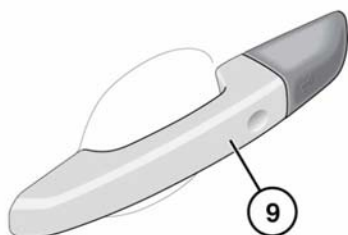
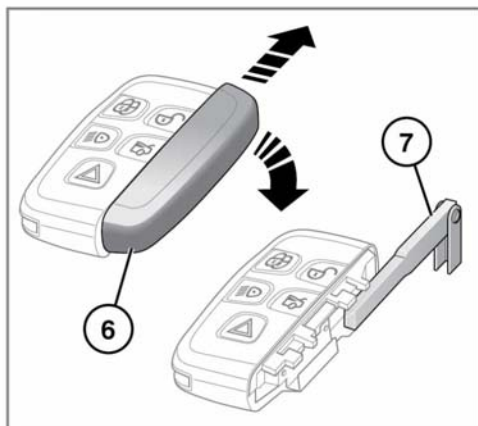
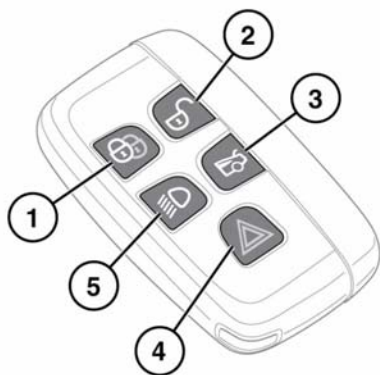

E170683

**⚠** Any person fitted with an implanted medical device, should make sure that the device is kept at a distance of at least 22 cm (8.7 inches) away from any transmitter mounted in the vehicle. This is to avoid any possibility of interference between the system and the device. Interference may cause the implanted medical device to malfunction, causing serious injury or death. See 255, SMART KEY TRANSMITTER LOCATIONS.

**⚠** To prevent accidental operation, never leave the Smart key in the vehicle if children or animals are also left in the vehicle.

**Note:** The operational range of the Smart key will vary considerably, depending on atmospheric conditions and interference from other transmitting devices.

**Note:** If any of the doors, or the luggage compartment, is unlocked 10 times within a short period of time, the latch will be disabled for approximately one minute.

The vehicle is supplied with 2 Smart keys. The Smart key acts as a remote control for the vehicle's locking/unlocking systems and the alarm system. It will also allow the vehicle to be started without the use of a conventional key. See **8, KEYLESS ENTRY, 14, KEYLESS LOCKING** and **100, STARTING THE ENGINE**. Each Smart key also has an emergency key housed in a slide-out compartment.

## 1. Lock:

- Press to secure the vehicle. The vehicle can be Single or Double locked. See **13, SINGLE LOCKING**. See **13, DOUBLE LOCKING**.

See also **14, GLOBAL CLOSING**.

The power-fold mirrors will fold (if enabled). See **65, EXTERIOR MIRRORS**.

## 2. Unlock:

- Press briefly to unlock the vehicle and deactivate the alarm. The hazard warning lamps will flash twice to indicate that the vehicle is unlocked and the alarm has been deactivated. The interior lamps and puddle lamps will illuminate to assist entry to the vehicle. The power-fold mirrors will unfold (if enabled).

## 3. Luggage compartment release:

- Press briefly to open the luggage compartment. If the vehicle is locked and armed, the security system will remain active while the luggage compartment is open, but intrusion and inclination sensing systems will be disabled.

When closing the luggage compartment again, if the vehicle is already locked and armed, the hazard warning lamps will flash after a few seconds to confirm that the full alarm system has been reactivated. There will also be an audible sound if the vehicle was Double locked.



Make sure the Smart key does not remain in the vehicle before closing the luggage compartment. If the vehicle is in an area of localised Radio Frequency (RF) interference or the Smart key is shielded by metal objects, the vehicle may close and lock with no means of opening again.

## 4. Panic alarm:

- Press and hold for 3 seconds (or press 3 times within 3 seconds) to activate the horn and the hazard lamps.
- Once active for more than 5 seconds, the alarm can be cancelled by pressing the button and holding for 3 seconds (or pressing 3 times within 3 seconds).
- The emergency alarm will also be cancelled if a valid Smart key is present when the START/STOP button is pressed.

## 5. Approach illumination:

- When approaching the vehicle during darkness, press to switch on the approach illumination. Press again to switch the approach lamps off.
- The approach illumination period, set at the factory, is 30 seconds. This delay period may be configured to provide illumination lasting between 0 and 240 seconds. See **47, INSTRUMENT PANEL MENU**.