

## CONNECTING JUMP LEADS

### WARNING

Always wear appropriate eye protection when working with batteries.

**WARNING:** Make sure both batteries are of the 12 volt type and that the jump leads have insulated clamps and are approved for use with 12 volt batteries.

**WARNING:** Do not disconnect the discharged battery.

**WARNING:** Do not connect a jump lead to any battery terminal on your vehicle.

**WARNING:** Make sure the bodywork of the donor and disabled vehicles do not touch.

**Note:** Before connecting jump leads, make sure that all electrical equipment on the disabled and donor vehicles have been switched off.

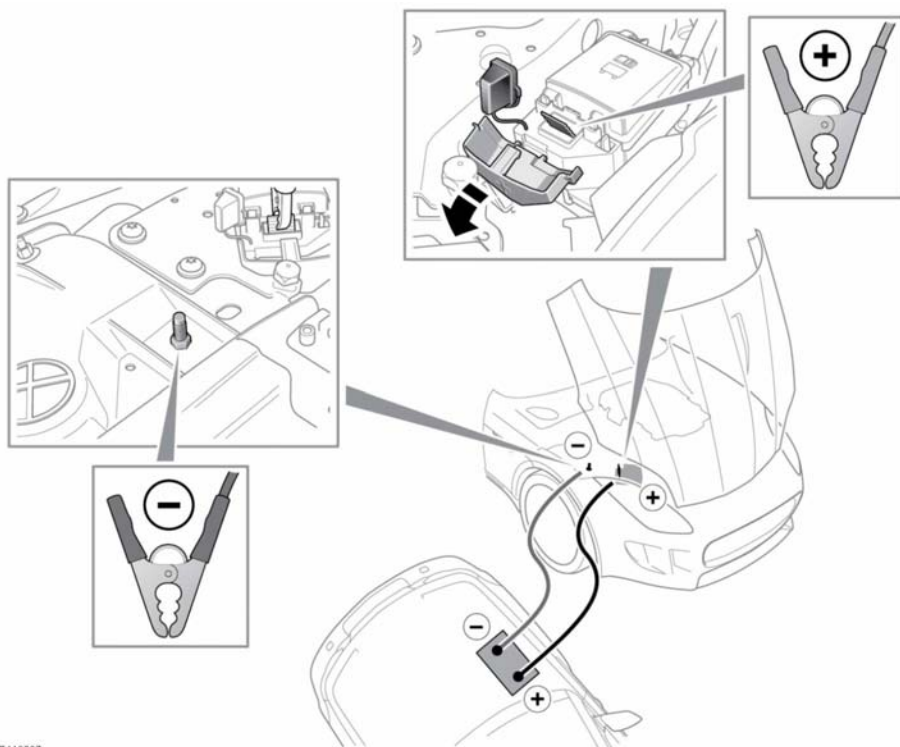

E 149267