

## **⚠ WARNING**

Brake fluid is highly flammable. Do not allow brake fluid to come into contact with open flames or other sources of ignition (e.g., a hot engine).

## **⚠ WARNING**

Do not drive the vehicle with the fluid level below the **MIN** mark.

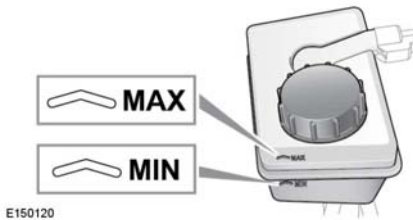

With the vehicle on level ground, check the fluid level at least every week (more frequently in high mileage or arduous operating conditions).

The brake fluid level should be between the **MIN** and **MAX** marks on the side of the reservoir.

The fluid level may drop slightly during normal use, as a result of brake pad wear, but should not be allowed to drop below the **MIN** mark.

## **TOPPING UP THE BRAKE/CLUTCH FLUID**

### **NOTICE**

*Brake fluid will damage painted surfaces. Soak up any spillage with an absorbent cloth immediately, and wash the area with a mixture of car shampoo and water.*

### **NOTICE**

*Only use new fluid from an airtight container. Fluid from open containers or fluid previously bled from the system, will have absorbed moisture, which will adversely affect performance and must not be used.*

1. Clean the filler cap with a clean, dry cloth before removing, to prevent dirt or moisture from entering the reservoir.
2. Remove the filler cap.
3. Top up the reservoir with the specified brake fluid to at least the **MIN** mark, see **217, LUBRICANTS AND FLUIDS**.

### **NOTICE**

*Do not top up the brake fluid to the **MAX** mark unless the brake pads have been replaced. If in doubt, seek qualified assistance.*

4. Replace the cap.
5. Refit the hood access cover. See **159, UNDER HOOD COVERS - REFITTING**.

## **CHECKING THE WASHER FLUID LEVEL**

## **⚠ WARNING**

Some windshield washer products are highly flammable, particularly if high or undiluted concentrations are exposed to sparking. Do not allow washer fluid to come into contact with naked flames or sources of ignition as this can cause a fire or explosion.

## **⚠ WARNING**

If the vehicle is operated in temperatures below 40°F (4°C), use a washer fluid with antifreeze protection. In cold weather, failure to use a washer fluid, with frost protection, could result in impaired vision and increase the risk of a vehicle crash.