

# Rear seats

## EXECUTIVE CLASS SEATS

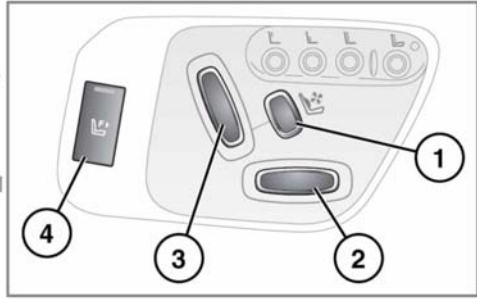
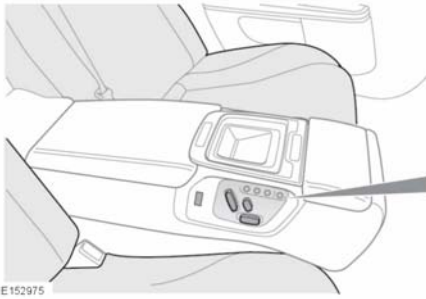

1. Lumbar support adjustment.
2. Forward and rearward seat adjustment.

**Note:** This is a 4-way switch when used to operate the front passenger seat. The switch is then used to adjust the forward and backward movement plus the raising and lowering of the seat. See item (4).

3. Seatback angle adjustment.
4. Front passenger seat adjustment: Press to select and then use switches (2) and (3) to make the required adjustments.