

AUDIO/VIDEO CONTROLS

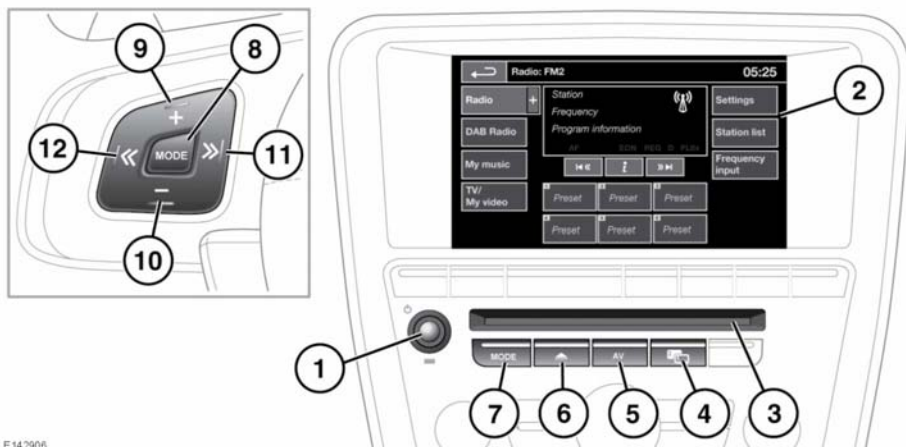

E 14 2906

⚠ In the interest of safety, only operate, adjust or view the system when it is safe to do so.

⚠ Sustained exposure to high sound levels (greater than 85 decibels) can damage your hearing.

1. On/off and volume control:

- Press to switch the system on/off.
- Rotate to adjust the volume level (displayed on the Touch screen).

Note: The audio system will operate with the ignition on or off, but will always switch off when the ignition is switched off. Switch the audio on again if required.

Note: If the volume is turned to zero while a Compact Disc (CD) is playing, the CD will pause play. Play will resume when a greater volume is selected.

2. Touch screen display.

3. CD/DVD loading slot: The player will accommodate 1 disc at a time, but up to 10 CDs can be uploaded into the CD store. Only Compact Disc Digital Audio (CDDA) discs can be uploaded into the CD store. Only discs with CDDA tracks and no other type, can be uploaded to the Stored CD store.

Insert a disc into the loading slot until resistance is felt. The player mechanism will complete the loading.

4. Press to select Dual view or Audio settings menu. See **121, DUAL VIEW CONTROLS** or **102, AUDIO SETTINGS**.

5. Press for direct access to the **Audio/Video** menu.

6. CD/Digital Versatile Disc (DVD) eject button.

7. MODE: Press repeatedly to scroll through all of the audio/video sources.

8. Steering wheel controls, **MODE:**

- Short press to scroll through all of the audio/video sources.