

CHILD SAFETY LOCKS

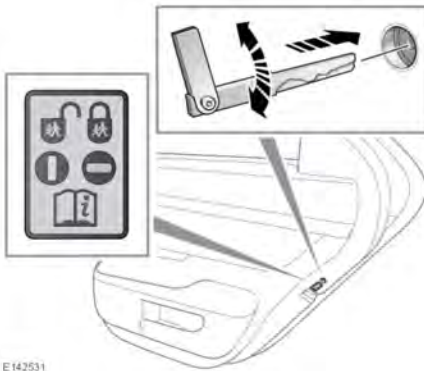

E142531

If children are to be carried in the rear seat positions, it is recommended that the rear door interior handles are disabled. To change the child lock settings:

1. Open the door to access the child safety lock.
2. Insert the emergency key into the slot and rotate a quarter of a turn, to enable or disable the interior door handle, as required. See 4, **UNLOCKING THE VEHICLE**.

CHILD SEATS

⚠ For optimum safety, children should travel in the rear of the vehicle at all times; front passenger seat travel is not recommended. However, if it is essential that a child travels in the front (not permitted in Australia), set the vehicle seat fully rearward and seat the child in an approved forward-facing child seat. Do not use a rear-facing child seat - an inflating airbag could impact with the seat and cause serious injury.



Do not use a forward-facing child seat until the child using it is above the minimum weight of 9 kg (20 lb.) and able to sit up unaided. Up to the age of two, a child's spine and neck are not sufficiently developed to avoid injury in a frontal impact.



Do not allow a baby or infant to be held or carried on the lap. The force of a crash can increase effective body weight by as much as thirty times, making it impossible to hold onto the child. At all times, children should be restrained in age and size appropriate child seats to reduce the risk of injury in a crash.



Children typically require the use of a booster seat appropriate to their age and size, thereby enabling the seat belts to be properly fitted, reducing the risk of injury in a crash. Children could be endangered in a crash if their child restraints are not properly secured in the vehicle.



Do not use a child seat that hooks over the seatback. This type of seat cannot be satisfactorily secured and is unlikely to be safe for your child.



Brazil only. Children under the age of 10 must not sit in the front seats under any circumstances, even if a child seat or booster seat is used.

The seat belts fitted to your vehicle are designed for adults and larger children. For their safety, it is very important for all infants and children under 12 years of age to be restrained in a suitable child safety seat appropriate to their age and size.