

# Front seats

## MANUAL SEATS

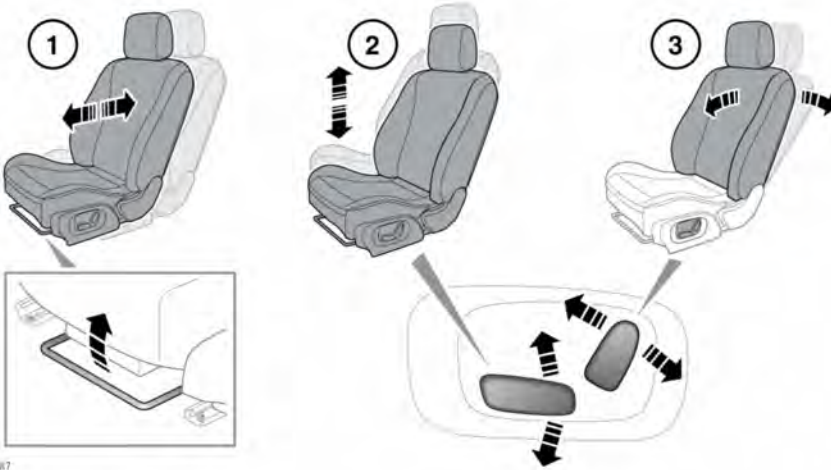

E134987

**⚠ Do not adjust the seat while the vehicle is moving. Doing so could cause loss of vehicle control and personal injury.**

1. Forward and rearward adjustment.
2. Height adjustment.
3. Seatback angle adjustment.

## DRIVING POSITION MEMORY

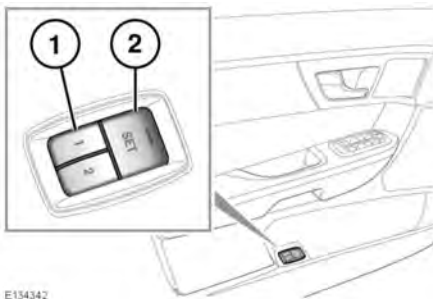

E134342

1. Memory presets.
2. Memory set button.

Once you have adjusted the driver's seat, steering column and exterior mirrors, the vehicle can memorise these settings using the driver memory buttons. See **26, ADJUSTING THE STEERING WHEEL** and see **54, EXTERIOR MIRRORS**.

Once the passenger seat has been adjusted as desired, these settings can be memorised using the passenger memory buttons.

1. Press the memory set button to activate the memory function.
2. Press one of the preset buttons within 5 seconds to memorise the current settings. For the driver's settings, **MEMORY 1 (or 2) SETTINGS SAVED** will be displayed in the Message centre, accompanied by an audible chime to confirm the settings have been memorised.

A seat position can only be memorised during the 5 second period.