

## RECOMMENDED CHILD SEATS

Child size/age	Recommended seat
Groups 0 and 0+	Britax/Römer Baby Safe Plus
Group I	Britax/Römer Duo Plus
Group II and III	Britax/Römer Kid Plus

## BOOSTER SEATS

In a situation where a child is too large to fit into a child safety seat, but is still too small to safely fit the 3-point belt properly, a booster seat is recommended for maximum safety. Follow the manufacturer's instructions for fitting and use, then adjust the seat belt to suit.

## ISOFIX ANCHOR POINTS

 Do not attempt to fit ISOFIX restraints to the centre rear seating position. The anchor bars are not designed to hold an ISOFIX restraint in this position.

 If the restraint is not correctly anchored, there is a significant risk of injury to the child in the event of a collision or emergency braking.

 If removing a head restraint in order to fit a child restraint, always secure the head restraint when storing it.

 **WARNING:** child restraint anchorages are designed to withstand only those loads imposed by correctly fitted child restraints. Under no circumstances are they to be used for adult seat belts, harnesses or for attaching other items or equipment to the vehicle.

Both of the outer rear seat positions are equipped to accept ISOFIX restraints.



This symbol is shown, on a label sewn into the seats, to indicate the position of the ISOFIX lower anchorages.

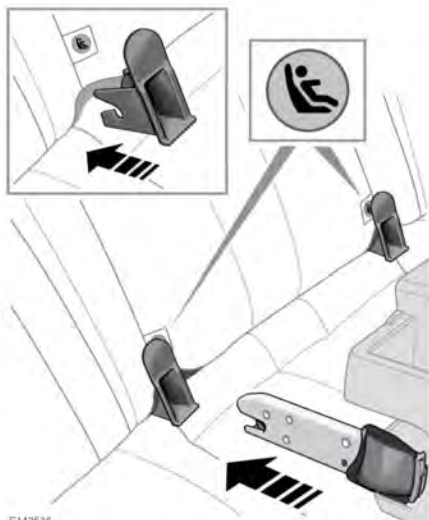

E142536

### To install an ISOFIX child seat:

1. Raise the head restraint on the relevant seat.
2. Locate the lower anchor bars, which are accessible through the gap between the seatback and the seat base. Insert the protective guides, supplied with the child seat, as shown. The insertion positions for the guides are identified by the ISOFIX labels.
3. Slide the child seat locking mechanism into the protective sleeves and onto the anchor bars.