

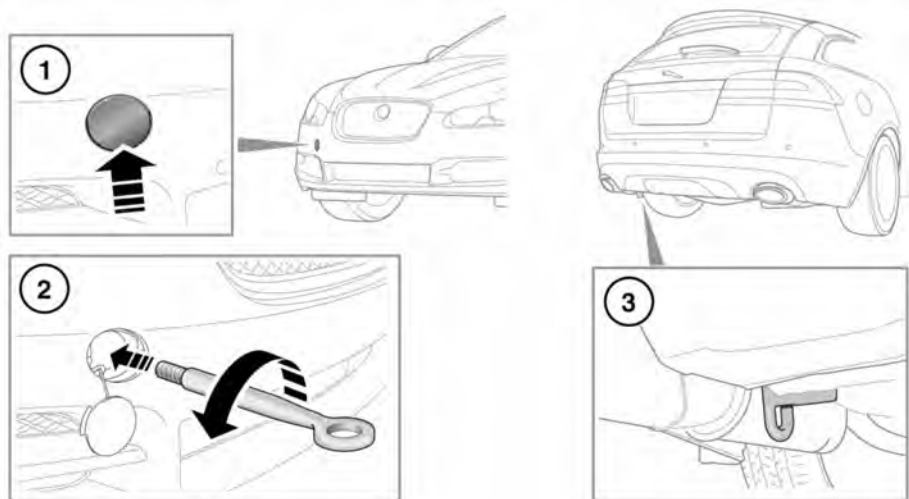

Vehicle recovery

TOWING EYES



E143954

 **The towing eyes at the front and rear of the vehicle are designed for on-road recovery only.**

 **Do not tow the vehicle on all four wheels.**

ATTACHING THE FRONT TOWING EYE

The front towing eye is included in the tool kit, located in the under-floor area of the Luggage compartment.

1. Pop out the cover in the front bumper.
2. Locate the towing eye through the bumper and screw the towing eye counter-clockwise into its fixing, until secure.
3. Rear towing eye.