

TRANSMISSION PARK RELEASE

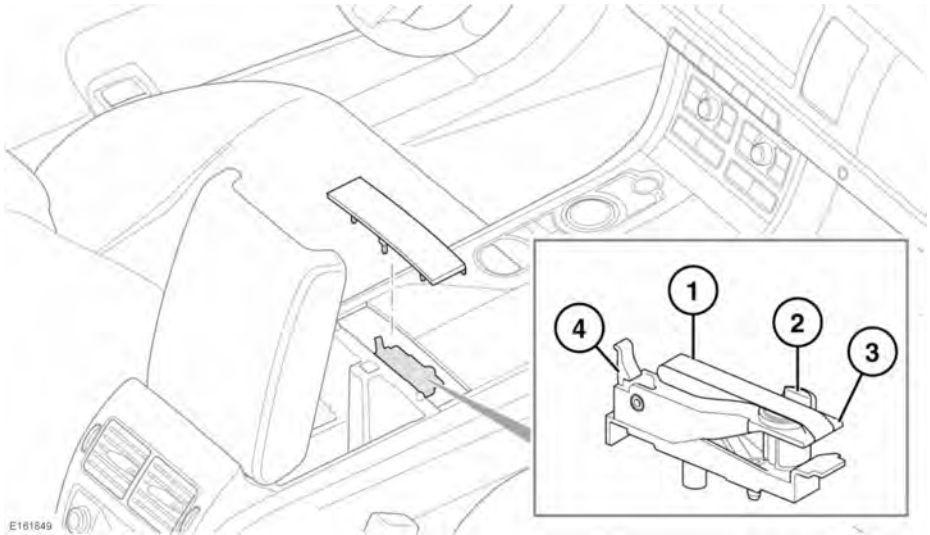

Make sure that the vehicle is secured with wheel chocks, apply the Electric parking brake, or firmly press the brake pedal. Failure to do so can result in unexpected movement of the vehicle causing serious injury or death.

When recovering your vehicle, it may be necessary to manually release the transmission from the Park (P) position to the Neutral (N) position. The Transmission park release is operated by a lever, located under the centre console between the drinks holder and the cubby box.



Lift up the cubby box lid and locate the trim panel just ahead of the cubby box. Prise up the panel and remove it.

To operate the Transmission park release:

1. Lift up the strap.
2. Rotate the locking device 90° counter-clockwise.
3. Pull up the operating lever with the strap, up to the vertical position.
4. The locking latch will retain the operating lever in this position.
The transmission is now in the Neutral position.

5. To re-engage the transmission park lock, hold the strap up.
6. Push the locking latch 4 outwards and return the operating lever 3 to the horizontal position. Rotate the locking device 2 90° clockwise.

Reinstall the trim panel and close the cubby box.

TRANSPORTING THE VEHICLE



Only use the lashing points indicated, or over-wheel lashings or wheel chocks. Use of any other lashing position may cause damage to the vehicle.

Vehicle recovery



During vehicle recovery, to make sure that the steering column remains unlocked, make sure the Smart key remains in the vehicle, transmission **N** is selected and the ignition is on.

Note: Do not attach or apply any loads to the rear spoiler (for example, bicycle carrier, luggage rack, signs, towing equipment, etc.).

The recommended method for recovery/transportation of the vehicle, is on a transporter or trailer designed for that purpose.

Make sure that transportation is carried out by suitably qualified persons and that the vehicle is secured correctly.