

## TELEPHONE SYSTEM OVERVIEW

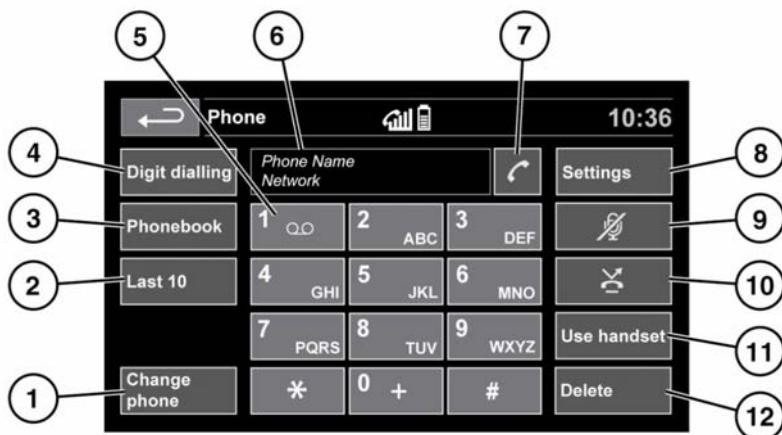

E151070

**Note:** Phone reception is dependent on the phone and network signal. Performance may be improved by changing your phone's settings (e.g., turning 3G off).

To access the **Phone** screen, see **59, TOUCH SCREEN HOME MENU**.

1. **Change phone:** Search new or change to another paired phone.
2. **Last 10:** Access the last 10 dialed, received, and missed calls.

**Note:** The vehicle will display the list in the order the calls were recorded. If this information is not available, they will be displayed as they are sent from the mobile phone. Some phones may arrange the list in reverse or other order.

3. **Phonebook:** Access the downloaded phonebook.
4. **Digit dialling:** Access Digit dialling mode.
5. Touch and hold to retrieve your Voicemail.
6. **Status display:** Displays the name and/or number dialed and call duration.

7. **Call Connect/Disconnect icons:** Touch to send/accept or end/reject a call.
8. **Settings:** Access Voicemail setup, Answer options, and Phone options.
9. **Mute microphone:** Initiate Privacy mode. While selected, the caller will not hear you talking.
10. **Auto reject:** When active, any incoming calls will be rejected or diverted to Voicemail (depending on the mobile phone settings).
11. **Use handset:** Switch the call to your mobile phone.
12. **Delete:** Touch to delete the last entered digit. Hold to delete the entire entry.

**Instructional video - Using the phone.**



E151490

## BLUETOOTH® INFORMATION



**Bluetooth®** is the name for short-range Radio Frequency (RF) technology that allows electronic devices to communicate wirelessly with each other.

The Jaguar Bluetooth wireless technology system supports **Bluetooth** Hands-Free Profile (HFP), Advanced Audio Distribution Profile (A2DP), and Audio Video Remote Control Profile (AVRCP).

**Note:** *HFP and A2DP/AVRCP profiles can be connected independently, so a phone can be connected via one, while a media device can be connected via the other, at the same time.*

Before making use of the vehicle's Bluetooth wireless technology phone system, your **Bluetooth** wireless technology device must be paired and connected to the vehicle's system. See **118, TELEPHONE COMPATIBILITY**.

Each time the ignition is switched on, the system will attempt to connect with the last connected phone.

As mobile phones have a wide range of audio and echo characteristics, it may take a few seconds for the vehicle's system to adapt and deliver optimum audio performance. To achieve this, it may be necessary to reduce the in-vehicle volume and ventilation fan speed slightly.

## TELEPHONE SAFETY



**Switch off your telephone in areas with a high explosion risk. This includes filling stations, fuel storage areas, or chemical factories, as well as places where the air contains fuel vapour, chemicals, or metal dust.**



**Always stow your mobile phone securely.**



**The functioning of cardiac pacemakers or hearing aids may be impaired when the phone is in use. Check with a doctor or manufacturer whether any such devices you or your passengers are using, are sufficiently protected against high-frequency energy.**

The Health Industry Manufacturers' Association recommends that a minimum separation of 15 centimetres (6 inches) is maintained between a wireless phone antenna and a pacemaker, to avoid potential interference with the pacemaker. These recommendations are consistent with the independent research by, and recommendations of, Wireless Technology Research.

## TELEPHONE COMPATIBILITY

For a list of compatible phones and pairing methods, on the Jaguar website ([www.jaguar.com](http://www.jaguar.com)), type 'Bluetooth' into the search area.

**Note:** *The Bluetooth® equipped phones listed, have been tested for compatibility with Jaguar vehicles. Performance will vary, based on the phone's software version, battery condition, coverage, and your network provider. Phones are warranted by their manufacturer, not Jaguar.*

If the mobile phone supports **Bluetooth** Hands-Free Profile 1.5 (HFP 1.5), additional features will be displayed on the vehicle's Touch screen, such as battery meter, signal strength, and network operator.

**Instructional video - Bluetooth connectivity website.**



E151510

## PAIRING AND CONNECTING USING THE PHONE

**Note:** The process of pairing and connecting your phone with the vehicle, using the mobile phone, will vary depending on the type of mobile phone used.

1. Make sure that the Touch screen is active.
2. From the **Home menu**, select **Phone**.
3. A menu will appear. Select **Search new**.
4. Select the **Device to vehicle** option.

**Note:** The vehicle's Bluetooth® wireless technology system is discoverable for only 3 minutes.

5. Using the mobile phone, search for **Bluetooth** devices.  
On some phones, this is referred to as a new paired device. See your phone's operating instructions for further information.
6. When the vehicle's Bluetooth wireless technology system is discovered, follow the on-screen instructions. Select **Yes** when prompted, to confirm the pairing. Either the phone or the vehicle's system will ask for a PIN (Personal Identification Number). When prompted, enter a PIN of your choice and select **OK** to confirm.
7. Enter the same PIN into the other device.
8. Once your phone is paired and connected to the system, a confirmation message will be displayed before switching to the **Digit Dialling** screen.

**Note:** Some mobile phones require the **Bluetooth** wireless technology pairing to be set as 'authorised' or 'trusted', in order to automatically connect. Please refer to your phone's operating instructions for further information.

Instructional video - Pairing a Bluetooth device to the vehicle.



E151511

## PAIRING AND CONNECTING USING THE TOUCH SCREEN

1. Switch on your mobile phone's **Bluetooth®** wireless technology connection. Make sure that your mobile phone is in **Bluetooth** wireless technology discoverable mode, sometimes referred to as find me mode (see your phone's operating instructions for more information).
2. Switch the ignition on and make sure the Touch screen is active.
3. From the **Home menu**, select **Phone**.
4. A menu will appear. Select **Search new**.
5. Select the **Vehicle to device** option.
6. Select your phone from the displayed list and select the corresponding **Pair and connect** option.  
**Note:** If more than 5 phones are detected, it may be necessary to use the scroll bar to see the entire list.
7. When prompted, enter the PIN code into your phone. See your phone's operating instructions for more information.
8. Once your phone is paired and connected to the system, a confirmation message will be displayed before switching to the **Digit dialling** screen.

# Telephone

**Note:** Due to the duration of a Bluetooth wireless technology search, it is advised that the **time out to home** screen feature is switched **off** before attempting to search for **Bluetooth** wireless technology devices. This setting can be changed via the Home menu screen, touch **Setup, Screen, Time out home**.

**Instructional video - Pairing the vehicle to a Bluetooth device.**



E151512

## CHANGING THE CONNECTED PHONE

Up to 10 mobile phones can be paired with the vehicle in the same way. However, only one can be connected and ready for use as a phone at any one time.

To connect a different paired phone to the vehicle, follow the steps below:

1. From the **Home menu**, select **Phone**.
2. A menu will appear. Select **Change phone**.
3. Identify and select your phone from the displayed list.
4. Once your phone is connected to the system, a confirmation message will be displayed before switching to the **Digit Dialling** screen.

## TELEPHONE SYSTEM ICONS



**Connect:** Use to send or accept a call and to access the Last 10 calls list.



**Disconnect:** Use to end or reject a call.



No phone connected.



Phone signal strength indicator.



Phone battery level indicator.



Bluetooth®: Indicates that a **Bluetooth** wireless technology device is connected.



Tick: Indicates that a **Bluetooth** wireless technology device is paired.



Voicemail: Press and hold to dial the stored Voicemail number.



Scroll bar up arrow: Use to scroll up lists of detected phones, calls, or phonebook entries.



Scroll bar down arrow: Use to scroll down lists of detected phones, calls, or phonebook entries.

## STEERING WHEEL CONTROLS

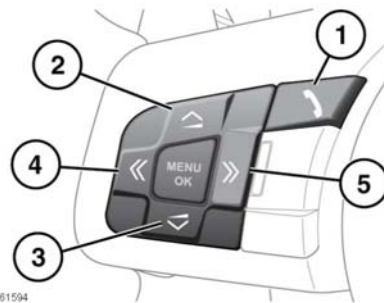

E161594

1. Press to answer an incoming call. Press to end a call. Press and release to dial a number/contact. Press and release to access the Last 10 dialled list. Press and hold to access the Phonebook list view.
  2. Increase the volume when in a call, scroll up a displayed list or a number listed for a stored contact.
  3. Decrease the volume when in a call, or scroll down a displayed list or a number listed for a stored contact.
  4. Press to scroll to the Last 10 list and received calls.
  5. Press to scroll back through received calls, the Last 10 list, and finally to exit the list.
- Note:** When scrolling through a phonebook or the Last 10 list, each contact is also displayed in the Message centre.

## CALL VOLUME

During a call, the phone call volume can be adjusted via the steering wheel buttons or the Audio system's volume control.

If the Audio system is in use when a phone call is active, the Audio system source is suppressed for the duration of the call.

## PHONEBOOK

Contacts stored in the memory of a paired phone can be automatically downloaded to the vehicle's phonebook each time the phone is connected to the system. See **118, TELEPHONE COMPATIBILITY**.

Certain mobile phones store the phonebook in two different areas, the SIM card and the phone's memory. The vehicle's system will access only those numbers stored in the phone's memory.

**To access contacts from the phonebook:**

1. From the **Phone** menu, select **Phonebook**.

2. Using the alpha keys, select the letter you wish to search under. Repeated selections of the same key, scrolls through the letters displayed on the keys.
3. Select **List** to view the Phonebook.
4. Identify the required contact from the displayed list and touch to call. If a contact has more than one number stored, select the required number from the list.

**Note:** It may be necessary to use the scroll bar to see the entire list.

There are also options to view more contact information, by selecting the corresponding **i** key.

If your phone supports contact type data, you will be able to see a contact type icon in the vehicle's phonebook directory. These can be seen on the right side of each contact in the directory and will indicate one of the following types:



Default.



Mobile.



Home.



Work.