

Cruise control

USING CRUISE CONTROL



In certain conditions, such as a steep gradient, the vehicle speed may exceed the set cruising speed. This is because engine braking is unable to maintain or reduce the vehicle speed. Driver intervention may be required.



Only use cruise control when conditions are favourable (e.g. straight, dry, open roads with light traffic).

Note: Do not use cruise control with transmission **S** mode selected.

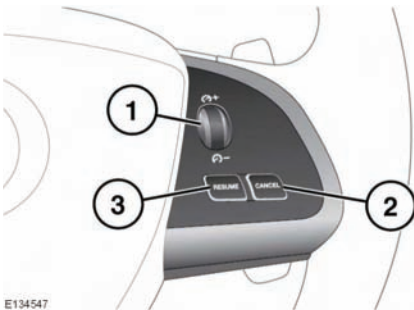

The system is operated by controls mounted on the steering wheel. The driver can also intervene at any time by use of the brake or accelerator pedals.

1. **SET (+/-):** Roll up or down to adjust the set speed. The set speed will be confirmed in the Message centre.

The cruising speed can also be increased using the accelerator. When the desired speed is reached, roll the control upwards to set and maintain the new speed. Release the accelerator.

Note: Cruise control can only be engaged at speeds in excess of 30 km/h (18 mph).

2. **CANCEL:** Press to cancel but retain the set speed in memory.

Cruise control will also be cancelled if; the brake pedal is pressed, the rotary drive selector is moved to Neutral (**N**), Dynamic stability control is activated, the difference between the set speed and the actual speed is too great, or if the vehicle reaches a speed of 192 km/h (120 mph).

3. **RESUME:** Press to resume the set speed.



RESUME should be used only if the driver is aware of the set speed and intends to return to it.



It is not recommended to resume set speed when a low gear is selected as excessive engine speeds will occur.

If the vehicle is accelerated above the set speed, then the set speed will be resumed when the accelerator pedal is released.

Note: If the accelerator pedal is pressed for more than 5 minutes, cruise control will be cancelled.

Cruise control will switch off and clear the memory when the ignition is switched off.