

## CHANGING THE CONNECTED PHONE

Up to 10 mobile phones can be paired with the vehicle in the same way. However, only one can be connected and ready for use as a phone at any one time.

To connect a different paired phone to the vehicle, follow the steps below:

1. From the **Home menu**, select **Phone**.
2. A menu will appear. Select **Change phone**.
3. Identify and select your phone from the displayed list.
4. Once your phone is connected to the system, a confirmation message will be displayed before switching to the **Digit Dial** screen.

## TELEPHONE SYSTEM ICONS



**Connect.** Use to send or accept a call and to access the last 10 calls list.



**Disconnect.** Use to end or reject a call.



**No phone connected.**



**Phone signal strength indicator.**



**Phone battery level indicator.**



**Bluetooth®.** Indicates that a Bluetooth® wireless technology device is connected.



**Tick.** Indicates that a Bluetooth® wireless technology device is paired.



**Voice mail.** Press and hold to dial the stored voice mail number.



**Scroll bar up arrow.** Use to scroll up lists of detected phones, calls or phonebook entries.



**Scroll bar down arrow.** Use to scroll down the lists of detected phones, calls or phonebook entries.

## STEERING WHEEL CONTROLS

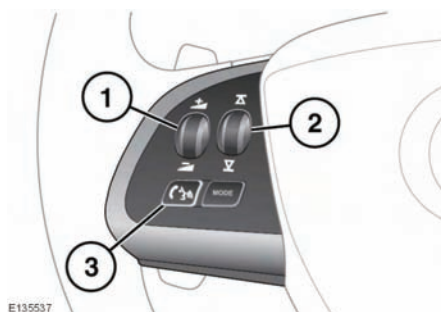

E139537

1. **Volume control.** Turn to increase/decrease call volume.
2. **Scroll control.** Turn to scroll up/down lists of calls or phonebook entries.
3. **Phone/Voice control.** Press and release to send, accept or end a call. If Voice control is not fitted, in addition to the above, press and release to access the Last 10 dialled list; press and hold to access the phonebook search view.

## CALL VOLUME

The phone call volume is operated by the audio system's volume control.

If the audio system is in use when a phone call is active, the audio system source is suppressed for the duration of the call.