

CHANGING THE CONNECTED PHONE

Up to 10 mobile phones can be paired with the vehicle in the same way. However, only one can be connected and ready for use as a phone at any one time.

To connect a different paired phone to the vehicle, follow the steps below:

1. From the **Home menu**, select **Phone**.
2. A menu will appear. Select **Change phone**.
3. Identify and select your phone from the displayed list.
4. Once your phone is connected to the system, a confirmation message will be displayed before switching to the **Digit Dial** screen.

TELEPHONE SYSTEM ICONS



Connect. Use to send or accept a call and to access the last 10 calls list.



Disconnect. Use to end or reject a call.



No phone connected.



Phone signal strength indicator.



Phone battery level indicator.



Bluetooth®. Indicates that a Bluetooth® wireless technology device is connected.



Tick. Indicates that a Bluetooth® wireless technology device is paired.



Voice mail. Press and hold to dial the stored voice mail number.



Scroll bar up arrow. Use to scroll up lists of detected phones, calls or phonebook entries.



Scroll bar down arrow. Use to scroll down the lists of detected phones, calls or phonebook entries.

STEERING WHEEL CONTROLS

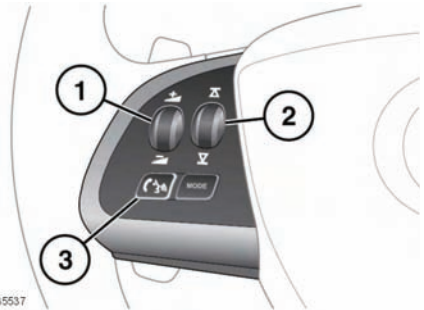

E139537

1. Volume control. Turn to increase/decrease call volume.
2. Scroll control. Turn to scroll up/down lists of calls or phonebook entries.
3. Phone/Voice control. Press and release to send, accept or end a call. If Voice control is not fitted, in addition to the above, press and release to access the Last 10 dialled list; press and hold to access the phonebook search view.

CALL VOLUME

The phone call volume is operated by the audio system's volume control.

If the audio system is in use when a phone call is active, the audio system source is suppressed for the duration of the call.