

Child safety

CHILD SAFETY LOCKS

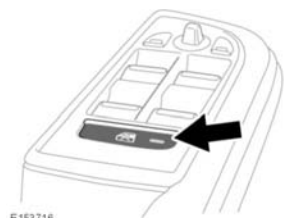

E153716



If children are to be carried in the rear seat positions, it is recommended that the rear door interior handles are disabled.

Press the switch to activate the child door locks and inhibit the rear windows, see **58, ELECTRIC WINDOWS**. The LED indicator will illuminate when active and a message will display in the Message centre.

To switch off, press the switch again. The LED will extinguish and a message will display in the Message centre.

CHILD SEATS



Crash statistics show that children are safest when properly restrained in a child or infant restraint system that is secured in a rear seating position.



For optimum safety, children should travel in the rear of the vehicle at all times; front passenger seat travel is not recommended. However, if it is essential that a child travels in the front, set the vehicle seat fully rearward and seat the child in an approved forward-facing child seat. Do not use a rear-facing child seat - an inflating airbag could impact with the seat and cause serious injury.



Do not use a forward facing child seat until the child using it is above the minimum weight of 9 kg (20 lb.) and able to sit up unaided. Up to the age of two, a child's spine and neck are not sufficiently developed to avoid injury in a frontal impact.



Do not allow a baby or infant to be held or carried on the lap. The force of a crash can increase effective body weight by as much as thirty times, making it impossible to hold onto the child.



Children typically require the use of a booster seat appropriate to their age and size, thereby enabling the seat belts to be properly fitted, reducing the risk of injury in a crash. Children could be endangered in a crash if their child restraints are not properly secured in the vehicle.



Do not use a child seat that hooks over the seatback. This type of seat cannot be satisfactorily secured and is unlikely to be safe for your child.

The seat belts fitted to your vehicle are designed for adults and larger children. It is very important for all infants and children under 12 years of age to be restrained in a suitable child safety seat appropriate to their age and size.

If it is essential that a child travels in the front passenger seat (and if national legislation permits this), Jaguar recommends that the following preparations are made before fitting the child restraint.

- Adjust the front passenger seat fully rearwards.
- Adjust the lumbar support to its minimum support position.

- Adjust the seat cushion to its highest position. If cushion front tilt adjustment is possible, adjust it to its lowest position.
- Adjust the seatback to the fully upright position.
- Adjust the seat belt adjustable upper anchorage to its lowest position.



Extreme hazard! Do not use a rearward facing child restraint on a seat protected by an airbag in front of it!



E132397

The symbol above, affixed to the front door post on the passenger side, and the label below affixed to the sun-visor warn against the use of a rear-facing child seat in the front passenger seat, when a front passenger airbag is fitted and operational.



E145193



NEVER use a rearward facing child restraint on a seat protected by an ACTIVE AIRBAG in front of it, DEATH or SERIOUS INJURY to the CHILD can occur.

CHILD RESTRAINT CHECK LIST

Every time a child travels in the vehicle observe the following:

- Use appropriate child restraints.
- Carefully follow the restraint system manufacturers instructions.
- Adjust the harnesses for every child on every trip.
- Make sure that all slack is removed from the adult seat belt.
- Always attach the top tether when installing an ISOFIX seat.
- Always check the security of the child restraint.
- Do not dress a child in bulky clothing, or place any objects/padding between the child and the restraint.
- Regularly check the fit and condition of child restraints. If the fit is poor, or wear/damage is visible replace the restraint immediately.
- Set a good example - always wear your seat belt.

CHILD SEAT POSITIONING



Information given within the table is correct at the time of going to press. However, availability of child restraints may change. Please consult your Dealer/Authorised Repairer for the latest recommendation.

Note: The information contained in the following table may not be applicable to all countries. If you are in any doubt regarding the type and fitment of child seats seek advice from your Dealer/Authorised Repairer.

Mass group	Seating positions			
	Front passenger*	Rear outboard	Rear centre	Rear centre**
0 = Up to 10 kg (22 lb.) 0 to 9 months	X	U	U	X
0+ = Up to 13 kg (29 lb.) 0 to 18 months	X	U	U	X
I = 9 to 18 kg (20 to 40 lb.) 9 months to 4 years	UF	U	U	X
II = 15 to 25 kg (33 to 55 lb.) 4 to 9 years	U	U	U	X
III = 25 to 36 kg (55 to 80 lb.) 8 to 12 years	U	U	U	X

U = Suitable for universal category restraints approved for this mass group.

UF = Suitable for forward facing Universal category restraints approved for this mass group.

X = Not suitable for child restraint fitment in this mass group.

* Jaguar recommend that the front passenger seat be positioned fully rearward, with the cushion adjusted to the highest position when installing child restraints.

** For vehicles fitted with Executive class rear seats, the centre position is unsuitable for both forward and rearward facing child seats.

Note: Ages given are approximate. In case of doubt, the child's weight, not age, should be used when considering an appropriate child seat.

ISOFIX ANCHOR POINTS



Do not attempt to fit ISOFIX restraints to the centre rear seating position. The anchor bars are not designed to hold an ISOFIX restraint in this position.



If the restraint is not correctly anchored, there is a significant risk of injury to the child in the event of a collision or emergency braking.



If removing the centre head restraint in order to fit a child restraint, always secure the head restraint when storing it.

Both of the outer rear seat positions are equipped to accept ISOFIX restraints.

For vehicles fitted with Executive class rear seats, before fitting an ISOFIX seat, adjust the seatback to the fully up-right position.



This symbol is shown on a label sewn into the seats to indicate the position of the ISOFIX lower anchorages.

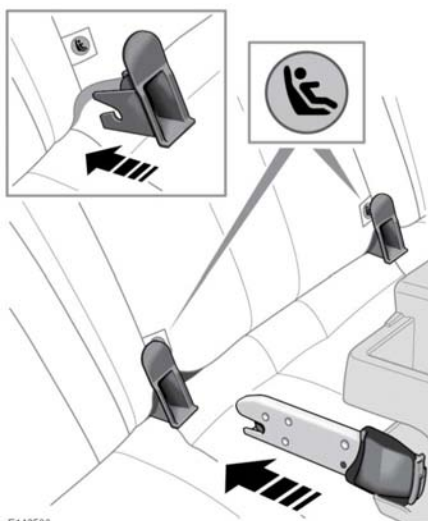

E142536

To install an ISOFIX child seat:

1. Raise the head restraint on the relevant seat.
2. Locate the lower anchor bars which are accessible through the gap between the seatback and seat base. Insert the protective guides supplied with the child seat as shown. The insertion positions for the guides are identified by the ISOFIX labels.
3. Slide the child seat locking mechanism into the protective sleeves and onto the anchor bars.
4. Test the security of the child restraint. To do this, attempt to pull the restraint away from the vehicle seat and twist the restraint from side to side. Even if the restraint appears secure you should always check the anchor points visually to make sure of the correct attachment.

Note: Always fit the upper tether anchorage and tightened correctly.

Note: The information contained in the following table may not be applicable to all countries. If you are in any doubt regarding the type and fitment of child seats seek advice from your Dealer/Authorised Repairer.

Mass group		Size classes	Fixtures	Rear outboard seats
Carrycot		F/G	ISO L1/L2	X
0 =	Up to 10 kg (22 lb.) 0 to 9 months	E	ISO R1	IL*
0+ =	Up to 13 kg (29 lb.) 0 to 18 months	C/D/E	ISO R1/R2/R3	IL*

Child safety

Mass group		Size classes	Fixtures	Rear outboard seats
I =	9 to 18 kg (20 to 40 lb.) 9 months to 4 years	C/D A/B1/B	ISO R2/R3 ISO F2/F2X/F3	X IUF
II =	15 to 25 kg (33 to 55 lb.) 4 to 9 years	-	N/A	N/A
III =	22 to 36 kg (49 to 80 lb.) 8 to 12 years	-	N/A	N/A

IUF = Suitable for ISOFIX forward child restraint systems of universal category approved for use in the mass group.

IL = These ISOFIX child restraint systems are of the specific vehicle, restricted or semi-universal categories.

X = Not suitable for child restraint fitment in this mass group.

***** = Child seat suitable for use in these locations is the Britax/Römer Baby Safe Plus.

N/A = Not available.

Note: Ages given are approximate. In case of doubt, the child's weight, not age, should be used when considering an appropriate child seat.



When fitting a child seat or restraint system, always pass the tether strap over the top of the seatback and beneath the head restraint.



If a child seat or restraint system is to be fitted to the centre seating position, the centre armrest must be in the stowed position (folded into the seat).



INSTALLING TETHER ANCHORAGE CHILD RESTRAINTS



WARNING: child restraint anchorages are designed to withstand only those loads imposed by correctly fitted child restraints. Under no circumstances are they to be used for adult seat belts, harnesses or for attaching other items or equipment to the vehicle.



Always follow the child seat or restraint system manufacturer's instructions when fitting tether straps.

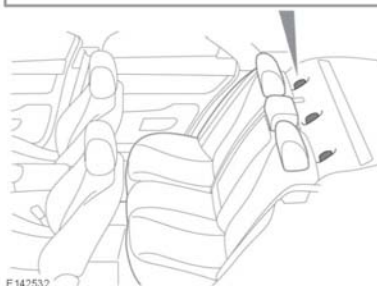

1. Install the child restraint securely in one of the rear seating positions.
2. Pass the tether strap over the seatback and beneath the head restraint*.

3. Attach the tether strap hook to the tether anchor point on the back of the seat. Make sure that the tether strap hook is facing the correct way (see graphic).
4. Tighten the tether strap according to the manufacturer's instructions.

Note: **On vehicles fitted with Executive class rear seats, raise the centre armrest to the up-right position and pass the strap over the top.*

BOOSTER SEATS

In a situation where a child is too large to fit into a child safety seat, but is still too small to safely fit the three point belt properly, a booster seat is recommended for maximum safety. Follow the manufacturer's instructions for fitting and use, then adjust the seat belt to suit.