

Fluid level checks

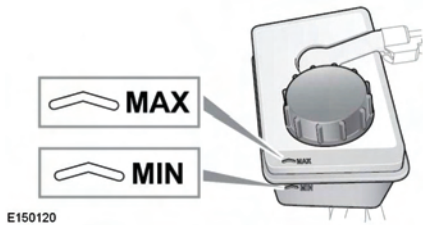

The brake fluid level should be between the **MIN** and the **MAX** marks on the side of the reservoir.

The fluid level may drop slightly during normal use, as a result of brake pad wear, but should not be allowed to drop below the **MIN** mark.

TOPPING UP THE BRAKE FLUID

- ⓘ Brake fluid will damage painted surface. Soak up any spillage with an absorbent cloth immediately and wash the area with a mixture of car shampoo and water.
 - ⓘ Only use new fluid from an airtight container (fluid from open containers or fluid previously bled from the system, will have absorbed moisture, which will adversely affect performance, and must not be used).
1. Clean the filler cap with a clean, dry cloth before removing, to prevent dirt or moisture from entering the reservoir.
 2. Remove the filler cap.
 3. Top up the reservoir with the specified brake fluid to at least the **MINIMUM** mark. See **177, LUBRICANTS AND FLUIDS**.
 - ⓘ Do not top up the brake fluid to the maximum mark unless the brake pads have been replaced. If in doubt seek qualified assistance.
 4. Replace the filler cap.

5. Refit the under bonnet cover. See **133, UNDER BONNET COVERS - REFITTING**.

CHECKING THE POWER STEERING FLUID LEVEL

- ⚠ **Power steering fluid is highly toxic. Keep containers sealed and out of reach of children. If accidental consumption of fluid is suspected, seek medical attention immediately.**
 - ⚠ **If the fluid comes into contact with the skin or eyes, rinse immediately with plenty of water.**
 - ⚠ **Power steering fluid is highly inflammable. Do not allow power steering fluid to come into contact with naked flames or other sources of ignition (e.g. a hot engine).**
- ⓘ The engine must not be started if the fluid level has dropped below the **MIN** mark.
 - ⓘ Seek qualified assistance immediately if there is a noticeable drop in the fluid level.
 - ⓘ If fluid loss is slow, the reservoir may be topped-up to the upper level mark to enable the vehicle to be driven to a repair facility for examination. However, it is recommended that you seek qualified assistance before driving the vehicle.

Check and top-up the fluid with the vehicle on level ground, with the engine switched off and the system cold. Ensure that the steering wheel is not turned after stopping the engine.

The level of fluid can be seen through the translucent body of the reservoir, see **140, FLUID FILLER LOCATIONS**.

The fluid level should be between the **MIN** and the **MAX** marks.