

# Fluid level checks

## TOPPING UP THE OIL

- ❗ Failure to use an oil that meets the required specification could cause excessive engine wear, a build up of sludge and deposits, and increase pollution. It could also lead to engine failure. Do not use low quality or obsolete oils.
- ❗ Your vehicle warranty may be invalidated if damage is caused by using oil that does not meet the required specification.
- ❗ Overfilling with oil could result in severe engine damage. Oil should be added in small quantities and the level re-checked to ensure that the engine is not overfilled.
- ❗ Do not use oil additives of any type as engine damage could occur. Use only specified lubricants.

1. Unscrew the oil filler cap.
2. Add oil as indicated by the Message centre display.
3. Wait 5 minutes for the oil level to stabilise then re-check.

It is essential to use the correct specification oil, and to ensure it is suitable for the climatic conditions in which the vehicle is to be operated, see **177, LUBRICANTS AND FLUIDS**.

Jaguar recommends:

**Castrol EDGE Professional**



## CHECKING THE COOLANT LEVEL

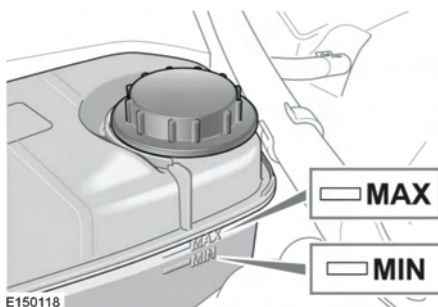

- ❗ Running the engine without coolant will cause serious engine damage.
- ❗ If persistent coolant loss is noticed, seek qualified assistance immediately.

The coolant level in the expansion tank should be checked at least weekly (more frequently in high mileage or severe operating conditions). Always check the level when the system is cold.

Make sure the coolant level is maintained between the maximum and minimum level indicator marks, as illustrated.

If the message **LOW COOLANT LEVEL** is displayed in the Message centre, stop the vehicle as soon as safety permits and top-up the coolant reservoir with the recommended antifreeze/water mix.

If the Message centre displays the message **ENGINE OVERHEATING**, pull off the carriageway and allow the engine to idle for 5 minutes and then switch off the ignition for 10 minutes. Switch on the engine and, provided that the warning does not occur, continue your journey, avoiding harsh acceleration. Seek qualified assistance as soon as possible.