

Maintenance



If the vehicle has been driven recently, do not touch exhaust system components until they have cooled.



If the lighting has just been switched off, give the bulbs time to cool. Handling them when hot may cause personal injury.



Always replace bulbs with the correct type and specification, see **180, BULB SPECIFICATION**. If you are in any doubt contact a Dealer/Authorised Repairer for advice.



Before attempting to replace a bulb, make sure that both the affected lamp and the vehicle's ignition are turned off. If the circuit remains live, a short circuit can occur which may damage the vehicle's electrical system.

Only the following bulbs can be replaced:

- Reversing lamp (3.0L vehicles only).
- Rear fog lamp (3.0L vehicles only).

Note: All other lamps should be repaired and serviced by qualified personnel only, contact a Dealer/Authorised Repairer.

XENON LAMPS



Replacement or maintenance of Xenon lamps should only be carried out by suitably qualified personnel.



High voltage is required to ignite the Xenon lamps.



Xenon lamp units operate at a very high temperature. Ensure that the lamp units have cooled before attempting to touch them.

REAR FOG LAMP BULB REPLACEMENT

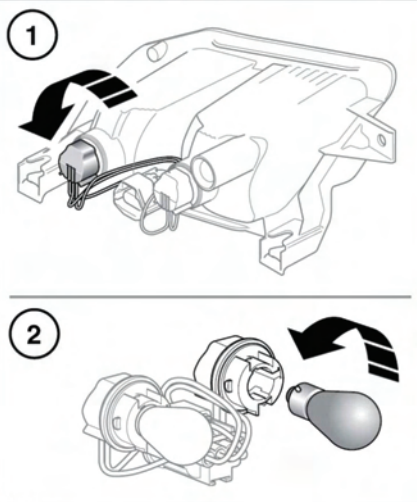

E149846

Access to the 3.0L vehicle's rear fog lamp housing is from underneath the rear bumper.

Note: The 5.0L vehicle has a light emitting diode (LED) bulb in the rear fog lamp. Removal of this lamp unit should only be attempted by a qualified technician. If in doubt, consult a Dealer/Authorised Repairer.