

## ELECTRIC PARKING BRAKE (EPB)

- ❗ The parking brakes operate on the rear wheels. Therefore, secure parking of the vehicle is dependent on being on a hard and stable surface.
- ❗ Do not rely on the parking brake to operate effectively, if the rear wheels have been immersed in mud or water.

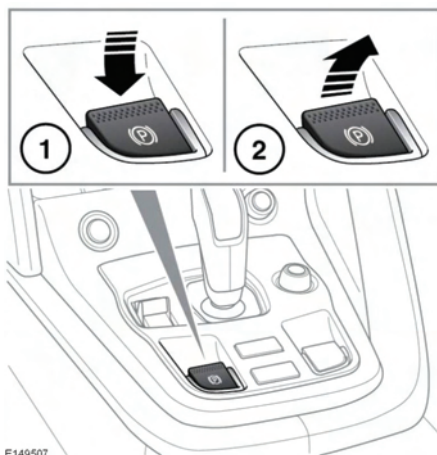

E149507

With the ignition switched on, depress the brake pedal and press down on the EPB switch (1). This will release the parking brake.

With the vehicle stationary, depress the brake pedal and pull up the EPB switch (2). This will apply the parking brake. A warning lamp (see **34, PARKING BRAKE (RED)**) illuminates to indicate that the parking brake is applied.

If the EPB switch is operated when the vehicle speed is less than 3 km/h (2 mph) the vehicle will be brought to an abrupt stop. The stop lamps will not be illuminated.

- ❗ Driving the vehicle with the parking brake applied, or repeated use of the parking brake to slow the vehicle, may cause serious damage to the brake system.

In an emergency, with the vehicle travelling more than 3 km/h (2 mph), pulling on the EPB switch and holding gives a gradual reduction in the speed. The brake warning lamp will illuminate accompanied by a warning tone and a warning message in the Message centre. The stop lamps will illuminate.

If the vehicle is stationary with the EPB applied and the transmission in **P**, selecting **D**, **N** or **R** will release the EPB and allow the vehicle to move off. See **70, AUTOMATIC TRANSMISSION**.

**Note:** Automatic release of the EPB is only possible when the driver's door is closed or the driver's seat belt is buckled.

If the system detects a fault with the EPB, the amber brake warning lamp will illuminate accompanied by a message in the Message centre.

If the system detects a fault while EPB is operating, the red parking brake warning lamp will flash, accompanied by a message in the Message centre.

**Note:** The red parking brake warning lamp will continue to be illuminated for at least 10 seconds after the ignition has been turned off.