

## AUDIO/VIDEO CONTROLS

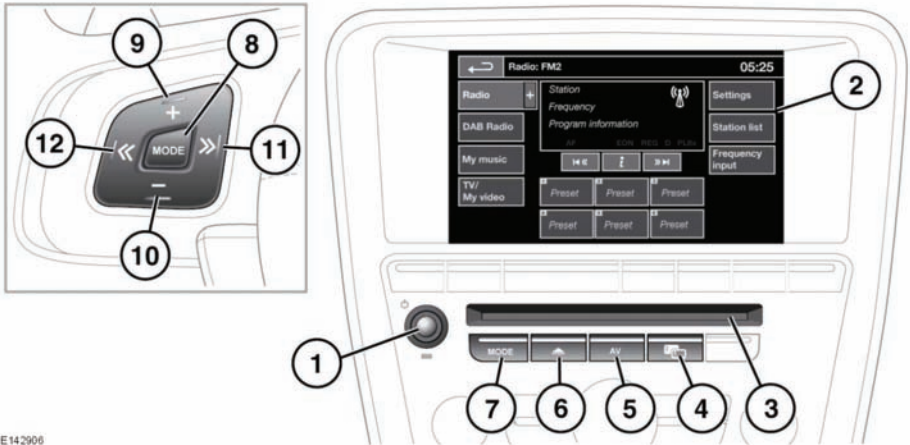

E142906



**In the interest of safety, only operate, adjust or view the system when it is safe to do so.**



**Sustained exposure to high sound levels (greater than 85 decibels) can damage your hearing.**

### 1. On/off and volume control:

- Press to switch the system on/off.
- Rotate to adjust volume level (displayed on the touch screen).

**Note:** The audio system operates with the ignition on or off but will switch off with the ignition and need to be switched on again.

### 2. Touch screen.

### 3. CD/DVD load and eject slot.

### 4. Press to select Dual view or Audio settings menu. See **115, DUAL VIEW CONTROLS** or **96, AUDIO SETTINGS**.

### 5. **AV**: Press to access audio/video menu.

### 6. Eject: Press to eject a CD/DVD.

### 7. **MODE**: Press repeatedly to scroll through all audio/video sources.

### 8. Steering wheel controls, **MODE**:

- Short press to scroll through all audio/video sources.
- Long press to scroll through audio/video source sub selections, e.g. In My music: iPod, Bluetooth®, stored CD and CD etc.

### 9. Press to increase volume.

### 10. Press to decrease volume.

### 11. Seek up:

- Short press to select the next radio preset, next preset TV channel, or next track on chosen audio source.
- Long press to seek to the next radio station or to select the next TV channel on the channel list.

### 12. Seek down:

- Short press to skip/move to the previous radio preset or previous preset TV channel, or previous track on list.
- Long press to seek to the previous radio station or to select the previous TV channel on the channel list.