

CHILD SEATS

⚠ DANGER

Make sure the child seat fits your child properly. Always check the seat manufacturer's instructions and labels for height and weight limits. For more specific guidance, consult your pediatrician.

There are three general types of child restraint systems: infant seats, toddler seats, and belt-positioning booster seats.

Infants: until at least 1 year of age and at least 20 lbs (9 kg).

Toddlers: until about age 4 and about 40 lbs (18 kg).

Boosters: belt-positioning booster until about age 8 or at least 4 ft 9 ins (145 cms) and seat belt fits properly.

⚠ DANGER

Do not allow a baby or infant to be held or carried on the lap. The force of a crash can increase effective body weight by as much as thirty times, making it impossible to hold onto the child. At all times, children should be restrained in age and size appropriate child seats to reduce the risk of injury in a crash.

⚠ WARNING

According to crash statistics, children are safer when properly restrained in the rear seats than in the front seat. Even with advanced air bags, children can be seriously injured or killed. Never place a child in any type of restraint or booster seat in the front passenger seat. Children under the age of 13 should always ride in the rear.

⚠ WARNING

Children could be endangered in a crash if their child restraints are not properly secured in the vehicle. Always follow the instructions that accompany the child seat carefully.

The seat belts fitted to your vehicle are designed for adults and larger children. It is very important for all infants and children under 12 years of age to be restrained in a suitable child safety seat appropriate to their age and size.

If it is essential that a child travels in the front passenger seat (and national legislation permits this), Jaguar recommends that the following preparations are made before fitting the child restraint.

- Adjust the front passenger seat fully rearwards.
- Adjust the lumbar support to its minimum support position.
- Adjust the seat cushion to its highest position. If cushion front tilt adjustment is possible, adjust it to its lowest position.
- Adjust the seat back to the fully upright position.



This symbol, affixed to the rear of the door aperture on the passenger side, warns against the use of a rear-facing child seat in the front passenger seat, when a front passenger air bag is fitted and operational.

⚠ WARNING

Extreme hazard! Do not use a rearward facing child restraint on a seat protected by an air bag in front of it.

SEAT BELT LOCKING MECHANISM

The front passenger and rear seat belts have a locking mechanism which improves the retention of child seats.

The procedure to install a child seat is as follows:

1. Place the child seat in the vehicle, attach the seat belt and secure the buckle in accordance with the manufacturer's fitting instructions.
2. Pull on the shoulder section of the belt to unreel all of the remaining webbing to the limit of its travel. This will engage the automatic locking feature which then acts as a ratchet, only allowing the webbing to retract.
3. Allow the seat belt to retract onto the child seat (a clicking sound will confirm that the ratchet has engaged), while firmly pushing the child seat into the vehicle seat.
4. Ensure that there is no slack in the seat belt, by pulling upwards on the shoulder belt immediately above the child restraint. The seat belt should now be locked and the child seat held firmly in position.

When the child seat is removed and all of the seat belt webbing is allowed to retract, the seat belt locking mechanism reverts to normal operation.

CHILD RESTRAINT CHECK LIST

Every time a child travels in the vehicle observe the following:-

Non-LATCH child restraints

- Carefully follow the instructions provided by the manufacturer of the restraint system.
- Always use the appropriate child restraints and adjust harnesses for every child, every trip.
- Avoid dressing a child in bulky clothing and do not place any objects between the child and the restraint system.
- Regularly check the fit of a child seat and replace seats or harnesses that show signs of wear.
- Ensure that you have removed all slack from the adult seat belt.
- No child seat is completely child-proof. Encourage a child not to play with the buckle or harness.
- Never leave a child unsupervised in the vehicle.
- Set a good example - always wear your seat belt.

LATCH child restraint

- Always attach the top tether when installing the LATCH seat (coupe vehicles only).
- Carefully follow the instructions supplied with the child seat. Always give the LATCH seat a final pull, to ensure that the lower anchors are secure.
- Always use the appropriate child restraints and adjust the harnesses for every child, every trip.

Child safety

- Make sure that a child falls into the correct weight range for the seat. Avoid dressing a child in bulky clothing and do not place any objects between the child and the restraint system.
- Regularly check the fit of a child seat and replace seats and harnesses that show signs of wear.
- No child seat is completely child-proof. Encourage children not to play with the buckle or harness.
- Never leave a child unsupervised in the vehicle.
- Set a good example - always wear your seat belt.

Note: *The legislation which governs how and where children should be carried when travelling in a vehicle, is subject to change. It is the responsibility of the driver to comply with all regulations in force.*

BOOSTER SEATS

In a situation where a child is too large to fit into a child safety seat (child is over 20 lbs or 7.5 kg), but is still too small to safely fit the three point belt properly (under 4 feet 9 inches or 145 cm), a booster seat is recommended for maximum safety. Follow the manufacturer's instructions for fitting and use, then adjust the seat belt to suit.

CHILD SEAT POSITIONING

PROPER CHILD SAFETY SEAT USE CHART Buckle Everyone. Children Age 12 and Under in Back.			
	INFANTS	TODDLER	YOUNG CHILDREN
WEIGHT	Birth to 1 year old and at least 20 lb. (9 kg).	Over 1 year and over 20 lb. (9 kg) to about 4 years and 40 lb. (180 kg) or child reaches highest weight or height allowed by child seat manufacturer.	Children who have outgrown their forward-facing toddler seat until vehicle seat belts fit properly, usually when a child is at least 4 ft 9 in. (145 cm) tall and 8 years old.
TYPE of SEAT	Rear-facing infant seat or convertible seat	Convertible seat or Forward-facing toddler seat.	Belt positioning booster seat.
SEAT POSITION	Rear-facing only.	Forward-facing.	Forward-facing.
ALWAYS MAKE SURE	Harness straps should be at or below shoulder level.	Harness straps should be at or below shoulder level.	Use booster seat with vehicle's lap and shoulder belt. Keep lap portion low and tight across the pelvis and upper thigh area to avoid abdominal injuries. Keep shoulder portion snug crossing the chest and shoulder. Never across the neck or face and never let a child place the shoulder belt behind their back.
CHILDREN RIDE IN REAR	Even with advanced air bags, children can be seriously injured or killed. Never place a child in any type of child restraint or booster seat in the front passenger seat. Children under the age of 13 should always ride in the back seat.		

When installing a child seat in the rear, the front seat must be moved forward and upwards to install any rear-facing child seat.

- Adjust the seat cushion to its highest position. If cushion front tilt is possible, adjust it to its lowest position.
- Adjust the seat back to the fully upright position.
- Adjust the seat belt adjustable upper anchorage to its lowest position.

⚠ WARNING

Extreme hazard! Never place a rearward facing child restraint on the front passenger seat. The infant could be seriously injured or killed if the air bag deploys.

Child safety

LATCH CHILD RESTRAINT ANCHOR POINTS

⚠️ WARNING

If the restraint is not correctly anchored, there is a significant risk of injury to the child in the event of a collision or emergency braking.

⚠️ WARNING

Child restraint anchorages are designed to withstand only loads imposed by correctly fitted child restraints. Under no circumstances are they to be used for adult seat belts, harnesses or for attaching other items or equipment to the vehicle. Doing so will greatly increase the risk of serious injury or death in the event of an accident.

⚠️ WARNING

If removing a head restraint in order to fit a child restraint, always secure the head restraint when storing it. In the event of an accident, unrestrained objects can potentially become deadly missiles.

Both of the outer rear seat positions are equipped to accept LATCH restraints.

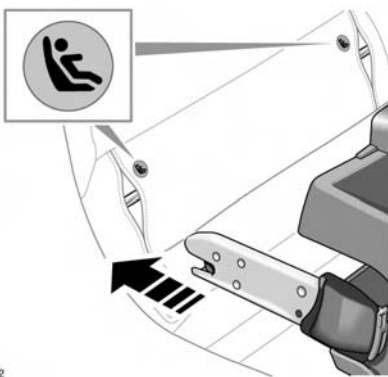

SJ1732

To install a LATCH seat:

1. Push the adult seat belts buckles into their stowage recesses.
2. Locate the lower anchor bars which are accessible through the gaps in the seat back.
3. Slide the child seat locking mechanisms through the trimmed apertures to engage with the anchor bars.
4. Test the security of the child restraint. To do this, attempt to pull the restraint away from the vehicle seat and twist the restraint from side to side. Even if the restraint appears secure you should always check the anchor points visually to ensure correct attachment.

Note: Always ensure that if an upper tether is provided, it is fitted and tightened correctly.

INSTALLING TETHER ANCHORAGE CHILD RESTRAINTS

(Coupe vehicles only)

⚠️ WARNING

Child restraint anchorages are designed to withstand only those loads imposed by correctly fitted child restraints. Under no circumstances are they to be used for adult seat belts, harnesses or for attaching other equipment or items to the vehicle. Doing so will greatly increase the risk of serious injury or death in the event of an accident.

⚠️ WARNING

Always follow the child seat or restraint system manufacturer's instructions when fitting tether straps. Failure to do so can greatly reduce the effectiveness of the child seat or restraint system in the event of an accident.

⚠ WARNING

Forward facing LATCH child seats cannot be secured in convertible vehicles using an upper tether anchorage.

Your vehicle is equipped with tether anchorage points behind the rear seat head restraints. These should be used to attach straps from child seats or restraint systems.

Note: *Convertible vehicles are not equipped with upper tether anchorages. It is not possible to install a forward facing child seat that requires an upper anchorage.*

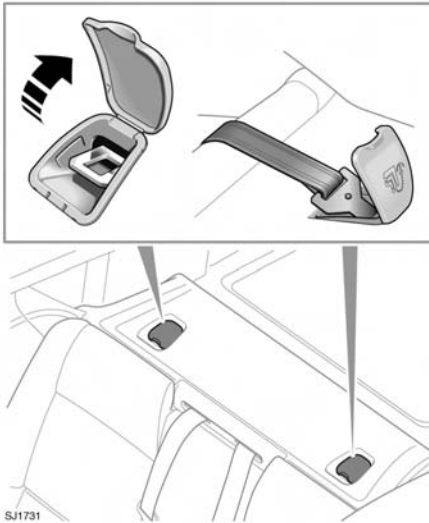

1. Install the child restraint securely in one of the rear seating positions.
2. Pass the tether strap over the seat back.
3. Attach the tether strap hook to the tether anchor point on the back of the seat. Ensure that the tether strap hook is facing the correct way.
4. Tighten the tether strap according to the manufacturer's instructions.