

# Seat belt

## SEAT BELT SAFETY

### **⚠️ WARNING**

Seat belts should be worn by all vehicle occupants, for every trip, no matter how short. Failure to do so will greatly increase the risk of serious injury or death in the event of an accident.

### **⚠️ WARNING**

It is essential to replace the entire assembly after it has been worn in a severe impact even if damage to the assembly is not obvious. Damage to the seat belt can greatly reduce its effectiveness in reducing the risk of serious injury or death in the event of an accident.

### **⚠️ WARNING**

The belt should be replaced if webbing becomes frayed, contaminated or damaged. Damage to the seat belt can greatly reduce its effectiveness in reducing the risk of serious injury or death in the event of an accident.

### **⚠️ WARNING**

Care should be taken to avoid contamination of the webbing with polishes, oils and chemicals, and particularly battery acid. Cleaning may safely be carried out using mild soap and water. Damage to the seat belt can greatly reduce its effectiveness in reducing the risk of serious injury or death in the event of an accident.

### **⚠️ WARNING**

Do not carry hard, fragile or sharp items between your person and the seat belt. In an impact, the pressure on such items can cause them to break, which in turn may cause serious injury or death in the event of an accident.

### **⚠️ WARNING**

When using seat belts to restrain items other than occupants, take care to ensure that the belts are not damaged, or exposed to sharp edges. Damage to the seat belt can greatly reduce its effectiveness in reducing the risk of serious injury or death in the event of an accident.

### **⚠️ WARNING**

Do not use comfort clips or other devices that create slack in the seat belt system.

## SEAT BELT CHECKS

*Note: If the vehicle is parked on an incline, the seat belt mechanism may lock. This is a safety feature and the belt should be gently eased out from the upper anchorage.*

The seat belts should be inspected regularly to check for fraying, cuts or wear to the webbing, and the condition and security of the mechanism, buckles, adjusters, and mounting points.

- With the seat belt fastened, give the webbing near the buckle a quick upward pull. The buckle must remain securely locked.
- With the seat belt unfastened, unreel the seat belt to the limit of its travel. Check that it unreels smoothly with no snatches or snags. Allow the belt to fully retract, again checking for smooth operation.
- Partially unreel the seat belt, then hold the tongue plate and give a quick forward pull. The mechanism must lock and prevent any further unreeling.

If any of the seat belts fail to meet these criteria, immediately contact your Dealer/Authorized Repairer.

## USING SEAT BELTS

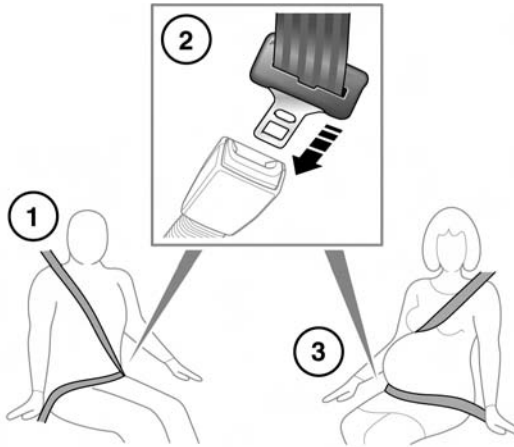

SJ1728

1. Draw the belt out smoothly, ensure that the seat, and your position on the seat are correct.

### **⚠️ WARNING**

Seat belts are designed to bear upon the bony structure of the body, and should be worn low across the front of the pelvis, chest and shoulders, as applicable; wearing the lap section of the belt across the abdominal area must be avoided. Never wear the seat belt as just a lap belt.

### **⚠️ WARNING**

Seat belts should be adjusted as firmly as possible, consistent with comfort, to provide the protection for which they have been designed. A slack belt will greatly reduce the protection afforded to the wearer.

### **⚠️ WARNING**

Belts should not be worn with the straps twisted.

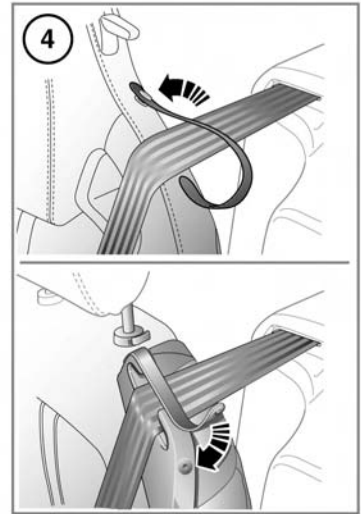

### **⚠️ WARNING**

Each belt assembly must only be used by one occupant. Never let children share a seat or seat belt.

### **⚠️ WARNING**

Riding with a reclined seatback increases your chance of serious or fatal injuries in the event of a collision or sudden stop. The protection of your restraint system (seat belts and air bags) is greatly reduced by reclining your seat. Seat belts must be snug against your hips and chest to work properly. The more the seatback is reclined, the greater the chance that an occupant's hips will slide under the lap belt or the occupant's neck will strike the shoulder belt. Drivers and passengers should always sit well back in their seats, properly belted, and with the seatbacks upright.

# Seat belt

## **⚠ WARNING**

**Never place anything between you and the seat belt in an attempt to cushion the impact in the event of an accident.**

2. With the seat belt correctly positioned, place the metal tongue into the buckle nearest to you. Press it in until a click is heard. Ensure that all slack has been taken up by the retractor and the belt fits tightly across the hips.

To release the seat belt, press the red button.

*Note: When releasing the seat belt it is advisable to hold the belt before pressing the release button. This will prevent the belt from retracting too quickly.*

3. **Use of seat belts during pregnancy:**

Position the lap strap comfortably across the hips beneath the abdomen. Place the diagonal part of the seat belt between the breasts and to the side of the abdomen.

## **⚠ WARNING**

**Position the seat belt correctly for the safety of the mother and unborn child. Never wear just the lap strap, and never sit on the lap strap while using just the shoulder strap. Both of these actions are extremely dangerous, and may increase your risk of serious injury in the event of an accident or during emergency braking.**

## **⚠ WARNING**

Ensure that the seat belt is not slack or twisted.

## **⚠ WARNING**

**Never place anything between you and the seat belt. It can be dangerous and reduce the effectiveness of the seat belt in preventing injury.**

4. To gain access to the rear seats, release the seat belt guide retainer strap.

Replace the seat belt guide retainer strap over the belt when the seat is back in the upright position.

## **SEAT BELT WARNING LAMP**



The warning lamp in the instrument panel stays illuminated when the driver's or front passenger's seat belt is not fastened (if the passenger seat is occupied). The lamp should extinguish when the seat belt is fastened.

The warning lamp will also flash in conjunction with the Beltminder warning chime.

## **SEAT BELT PRE-TENSIONERS**

The seat belt pre-tensioners activate in conjunction with the Supplementary Restraint System (SRS) to provide additional protection in the event of a severe frontal impact. They automatically reduce any slack in a seatbelt to reduce forward movement of a front seat occupant.

## **⚠ WARNING**

**The seat belt pre-tensioners will activate only once and then must be replaced. Failure to replace them will reduce the effectiveness of the SRS in reducing the risk of serious injury or death in the event of an accident.**

## **⚠ CAUTION**

**After any impact, have the seat belts and pre-tensioners checked and, if necessary, replaced by a Dealer/Authorized Repairer.**

## BELTMINDER

The belt minder system warns the driver (using the seat belt warning lamp) when the seat belt of an occupied front seat is not fastened or is unfastened during a journey.

If the vehicle is moving at or above 10 mph (16 km/h) and the seat belt of an occupied front seat is not fastened, the warning lamp will flash.

The flashing lasts for 10 seconds and repeats every 10 seconds for approximately 5 minutes or until the belt(s) is fastened or the vehicle stops.

If the warning lamp remains illuminated after the seat belt(s) fastened, seek qualified assistance as soon as possible. The vehicle can still be driven with the warning lamp illuminated, provided the seat belt(s) is properly fastened.

**Note:** *If a heavy object is placed on the front passenger seat, it may activate the Beltminder feature. It is recommended that the object be placed in the luggage compartment or secured using the seat belt.*

**Note:** *Although not advisable, it is possible to disable the Beltminder function. Please see your Dealer/Authorized Repairer to disable or re-instate the function.*