

Parking aids

PARKING AID OPERATION

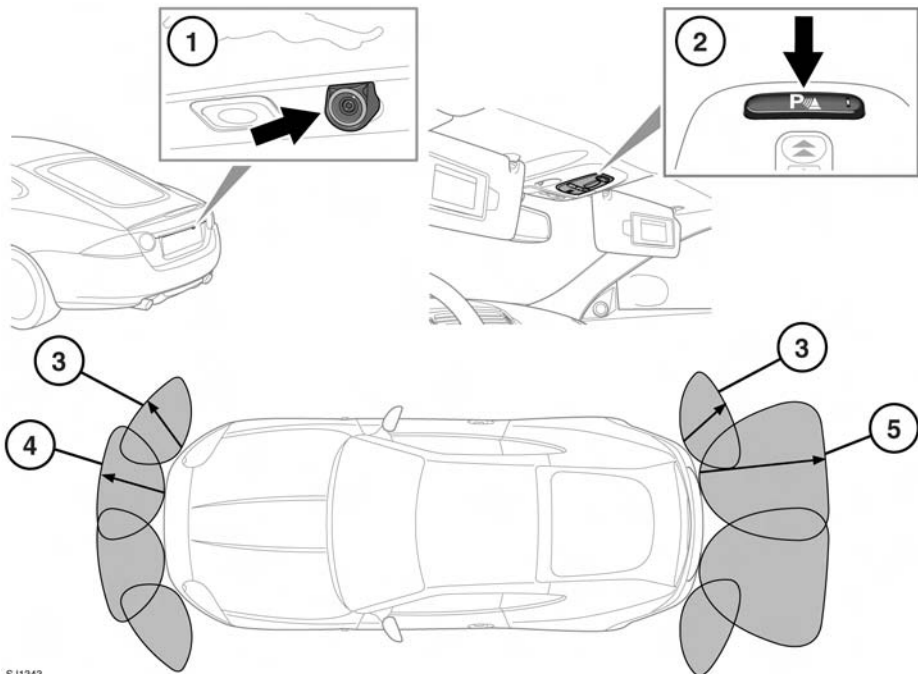

SJ1343

1. Rear view camera. See **94, REAR VIEW CAMERA**.
2. Parking aid switch: Press to turn the parking aid on and off.
3. Approximately 24 inches (600 mm).
4. Approximately 31 inches (800 mm).
5. Approximately 71 inches (1800mm).

⚠ WARNING

The parking aid system is not a substitute for driving safely, with due care and attention. Drivers should not assume that this feature will correct errors of judgement while driving.

⚠ WARNING

The parking aid system may not function under all speeds, weather and road conditions.

⚠ WARNING

Parking aids may not detect moving objects, such as children and animals until they are dangerously close. Always use extreme caution when maneuvering, turn and look and use your mirrors.

⚠ WARNING

It remains the driver's responsibility to detect obstacles and estimate the vehicle's distance from them. Some overhanging objects, barriers, small children, animals, thin obstructions or painted surfaces may not be detected by the system.

NOTICE

The parking aid sensors may not detect some obstructions (e.g. narrow posts, small objects close to the ground and some objects with dark, non-reflective surfaces). Parking aids are for guidance only and are not intended to replace the driver's visual checks for obstructions or objects when maneuvering.

NOTICE

Systems using the same frequency band as the front parking sensors, may cause irregular tones to be emitted.

Note: *The sensors are active when the gear selector is in neutral, and in drive after moving from reverse. Therefore, if an obstacle is detected an audible warning tone will sound.*

REAR FITTED ACCESSORIES

Particular care must be taken when reversing with rear fitted accessories, as the rear parking aid will only indicate the distance from the bumper to the obstacle.

CLEANING THE SENSORS

For reliable operation, the sensors in the front and rear bumpers should be kept free from ice, frost and grime.

NOTICE

Do not clean the sensors with abrasive or sharp objects or materials.

NOTICE

When using a high pressure spray, only spray the sensors briefly, from a distance greater than 8 inches (200 mm).

PARKING AID SYSTEM FAULT

If the system has a fault when engaging reverse gear or turning on the ignition, then a single, 3 second tone will be heard and a pop-up warning will appear on the touch screen. If both front and rear parking aids are fitted, the warning indicator in the parking aid switch will flash for 3 seconds and then switch off.

If a fault is detected, the system is automatically disabled.

Note: *The parking aid may emit spurious tones if it detects a frequency tone using the same band as the sensors (e.g. air brakes).*

Parking aids

REAR VIEW CAMERA

⚠ WARNING

Always turn and look before reversing. It remains the driver's responsibility to detect obstacles and estimate the vehicle's distance from them when reversing.

NOTICE

Some overhanging objects or barriers which could cause damage to the vehicle may not be detected by the camera.

When Reverse (R) is selected, the system uses a camera to provide a wide-angle color rear view image on the touch screen.

The camera display has priority over the parking aid display. To view the parking aid display instead, or to cancel camera display at any time, touch the display.

The display also incorporates graphic overlays, indicating vehicle direction, width and proximity to surrounding objects.

The camera image will not be displayed;

- If Drive (D) is selected and the vehicle speed is greater than 16 km/h (10 mph).
- If Drive (D) is selected for longer than 2 seconds.

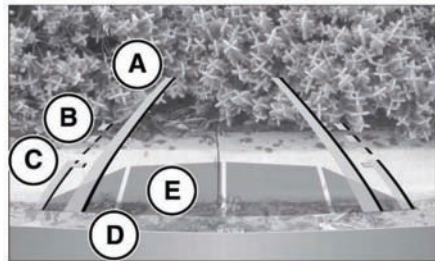
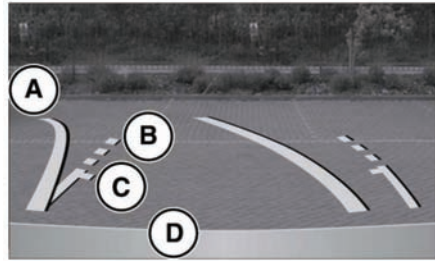

E132516

- A. Solid line: The projected wheel trajectory.
- B. Dotted line: The safe working width of the vehicle (including exterior mirrors).
- C. Boot access guideline: Do not reverse beyond this point if boot access is required.
- D. Bumper inclusion.
- E. Parking sensor activation: A colored area appears, to indicate which rear sensor(s) has been activated.