

ELECTRIC WINDOWS

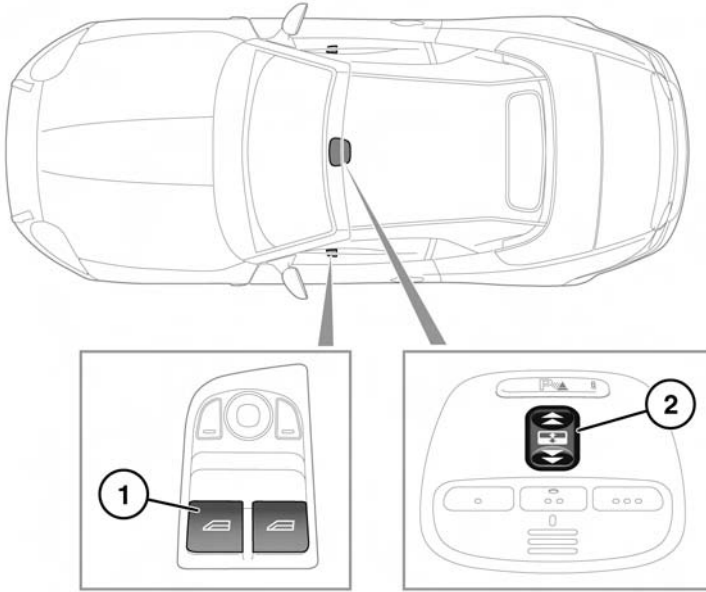

SJ1684

⚠ WARNING

To prevent accidental operation, never leave the Smart Key in the vehicle if children or animals are also left in the vehicle.

1. Window switches:

The windows will operate for 5 minutes after the engine is switched off, as long as none of the doors are opened.

Each window has a one-touch facility enabling the occupant to fully open or close the window in one quick movement.

Press (or pull) the switch briefly to open (or close) the window. Window travel can be stopped at any time by operating the switch again.

NOTICE

Any ice must be removed from the windows prior to operation.

2. Rear quarter window switch (convertible only).

To operate the windows independently of the convertible roof when the convertible roof is closed:

- Press the rear of the switch for less than a second and the rear quarter windows will fully open.
- Press the front of the switch and hold and the rear quarter windows will raise as long as the switch is held.

Note: *When the convertible roof is opened, the rear quarter windows are automatically lowered and cannot be operated until the roof is closed. When the roof is closed, the rear quarter windows raise automatically.*

WINDOW ANTI-TRAP PROTECTION

⚠ WARNING

Before closing a window, ensure that no occupants have any part of their body in a position where it could be trapped. Even with an anti-trap system death or serious injury could occur.

⚠ WARNING

If the battery is disconnected or discharged the window anti-trap protection feature is lost. When the battery is reconnected or recharged the window anti-trap protection system must be reset.

Anti-trap protection is designed to stop window movement if an obstruction or resistance is detected. Check the window and its aperture and remove any obstructions.

The override procedure is as follows:-

1. Attempt to close the window. Anti-trap will prevent closure and lower the window.
2. Within 10 seconds, attempt to raise the window again. Anti-trap will prevent closure and lower the window.
3. Attempt to close the window for a third time, this time holding the switch in the close position. The window will raise while the switch is held. Hold until closed.

Note: *If this procedure fails to remove the blockage, or if the windows do not operate correctly, the window operation may need to be reset. See 152, **WINDOW RESET**.*