

Navigation system

THE NAVIGATION SYSTEM

Navigation instruction is by map and turn information displayed on the touch screen and can be complemented by voice guidance if required. The system uses signals from Global Positioning System (GPS) satellites combined with information from vehicle sensors and the Navigation DVD, to establish the true vehicle position.

Using this combination of data sources the vehicle navigation computer enables you to plan and follow a route map to your desired destination.

The touch screen is used to control navigation via menus, text screens and map displays.

⚠ In the interest of safety, only operate, adjust or view the system when it is safe to do so.

The requirements of national Road Traffic Regulations (RTR) always apply.

Observation of traffic signs and local traffic regulations always take priority.

GPS signals may occasionally be interrupted due to physical barriers such as tunnels and roads under raised highways.

However, direction and speed sensors on the vehicle will minimise any adverse effect on the navigation system. Normal operation will resume once the obstruction has been passed.

Under certain conditions it is possible for the vehicle position shown on screen to be incorrect. This may happen when:

- Driving on a spiral ramp in a building.
- Driving on or beneath elevated roads.
- Two roads are close and parallel.
- The vehicle is transported to another destination.
- After the vehicle is rotated on a turntable.
- After vehicle battery disconnection.

LOADING THE NAVIGATION DVD

Note: Before using the navigation system, ensure that the DVD that contains the correct country mapping information is loaded in the navigation DVD player.

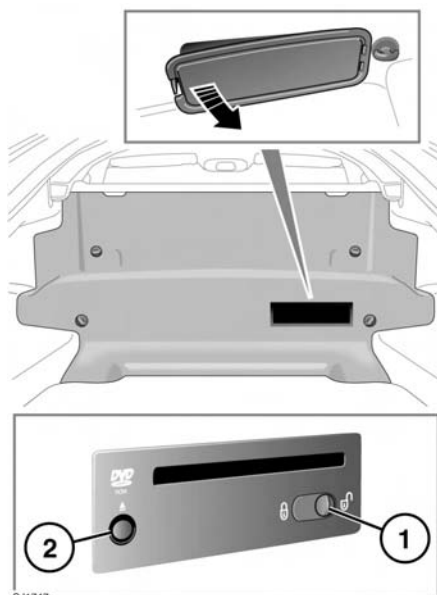

The navigation DVD player is located in the luggage compartment.

- Turn on the vehicle ignition.
- Remove the trim panel (as shown) to access the DVD player.
- Move the slider to the unlock position (1).
- Press the unload button (2) to eject a DVD, if one is installed in the DVD player.
- Load the correct Navigation System DVD with the printed side upwards. Do not allow moisture or foreign objects to enter the slot.
- Move the slider to the locked position.