

## OPENING THE CONVERTIBLE ROOF

- ⚠ **Before opening or closing the convertible top, ensure that all occupants have moved their hands, fingers, hair, etc. clear of moving parts.**
- ⚠ **Do not place items on the tonneau panel or over the Rollover Protection Device covers.**
- ⓘ The convertible roof will not operate unless the luggage separator is correctly located in the deployed position in the luggage compartment (see, **60, LUGGAGE SEPARATOR**) and that the luggage compartment lid is firmly closed.
- ⓘ Do not at any time during the opening or closing of the convertible roof press the engine START/STOP button as all movement will cease and the convertible top will have to be manually re-set.
- ⓘ Check that there is nothing in the rear area which could interfere with the convertible roof when folding down, e.g. ensure that the battery cover trim is fitted and secure.
- ⓘ Do not attempt to operate the convertible top at temperatures below  $-15^{\circ}\text{C}$  ( $5^{\circ}\text{F}$ ). This may cause damage to the fabric.
- ⓘ If the convertible top is operated above 24 km/h (15 mph), there is a risk of damage to the convertible roof.
- ⓘ Do not attempt to open the convertible roof manually, as damage to the linkage mechanism may occur.

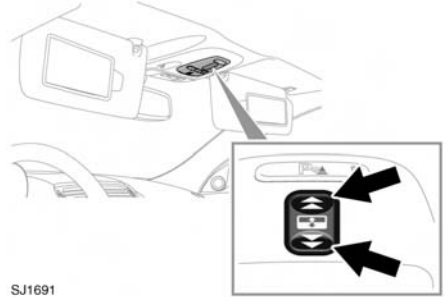

SJ1691

The power operated convertible roof and rear quarter windows, are controlled by the switch located on the overhead console. The ignition system must be on. The roof will latch and unlatch automatically.

The top can be operated at speeds below 24 km/h (15 mph). However, for safety it should not be opened or closed when the vehicle is being driven.

1. Ensure that the ignition is on.
2. Ensure that the luggage separator in the luggage compartment is in the fully deployed position. If it is not positioned correctly the proximity switches will not operate and the convertible roof will not open.
3. Press and hold the rear of the overhead console switch (do not release the switch until the roof is fully open).

**Note:** *If the convertible roof ceases to operate while opening, see **62, CONVERTIBLE ROOF MANUAL RE-SET.***

4. The rear quarter windows open, an audible warning sounds and the top unlatches and starts to move. The tonneau closing panel opens (the front windows will fully open. The door window switch will require to be pressed to close the windows).