

Entering the vehicle

UNLOCKING THE VEHICLE

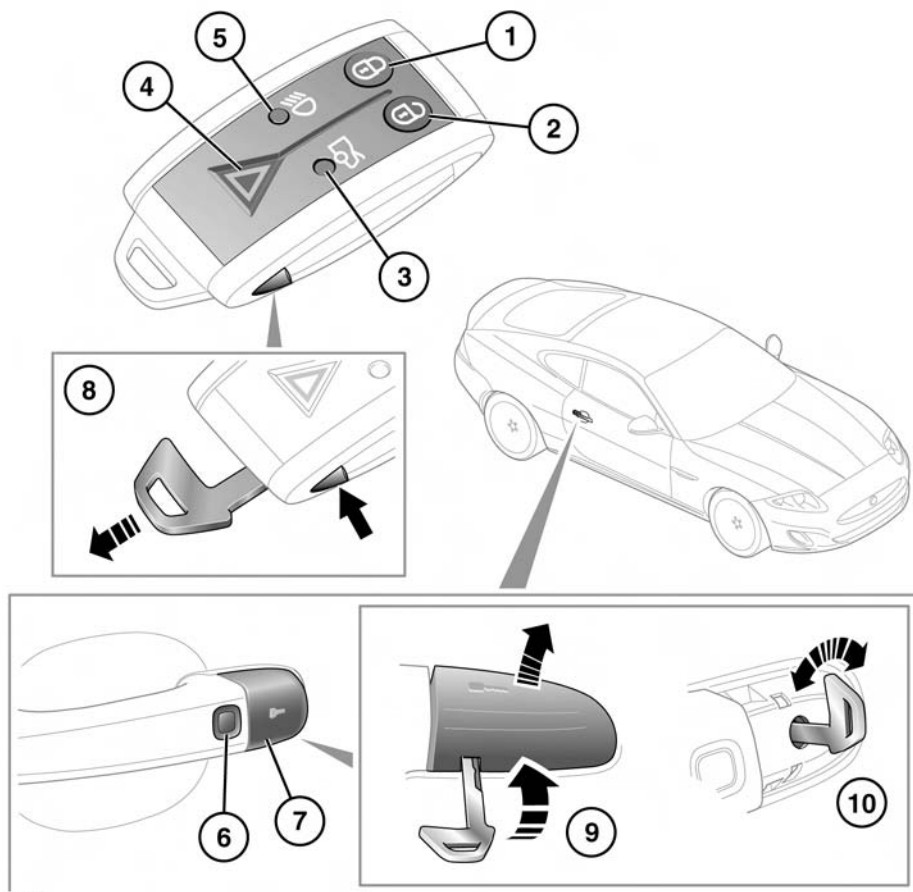

1. Press the lock button to secure the vehicle. The vehicle can be Single or Double locked. See **9, SINGLE LOCKING** and **9, DOUBLE LOCKING**.
2. Your vehicle can be unlocked using either Single or Multi-point entry. When single point entry is enabled the first press unlocks the driver's door and enables the other doors to be opened from

the inside. The hazard warning lamps will flash twice, to indicate that the vehicle is unlocked and the alarm has been disarmed.

A second press unlocks the passenger door and the luggage compartment.

If multi-point entry is enabled, press briefly to unlock all the doors and luggage compartment and to disarm the alarm. The

hazard warning lamps will flash twice to indicate that the vehicle is unlocked and the alarm has been disarmed.

To change from Single to Multi-point entry (or vice versa), press both the lock and unlock buttons simultaneously for 3 seconds. The hazard warning lamps will flash twice to confirm the change.

The change can also be achieved using the touch screen. See **52, VEHICLE SETTINGS**.

3. Press to open the luggage compartment. The vehicle security system will remain active for the period the luggage compartment is open, but the intrusion and inclination sensing systems will be inhibited. Door and bonnet security will remain active.

The security system will re-arm to its previous state when the luggage compartment is closed.

4. Panic alarm: Press and hold for 3 seconds, or press three times within 3 seconds, to activate the horn, siren and hazard lamps. After 5 seconds, the alarm can be cancelled by pressing the button and holding for 3 seconds, or pressing 3 times within 3 seconds.

The emergency alarm will also be cancelled if the vehicle detects a valid Jaguar Smart Key when the START/STOP button is pressed.

5. Press to switch on the approach illumination for up to 120 seconds. The illumination time is set using the exit delay switch, see **30, LIGHTING CONTROL**. Pressing the button again or operating the starter button, will turn the approach lamps off.
6. Keyless locking button. See **10, KEYLESS LOCKING**.
7. Door lock cover.

8. Press and hold the emergency key release button, while pulling the emergency key from the Jaguar Smart Key body.
9. Insert the emergency key blade into the slot at the base of the door lock cover. Then gently lever the key blade upwards to lever the cover off the retaining clips.
10. Insert the key blade into the exposed lock to operate.

To lock: Ensure all the doors are closed, then turn the key blade towards the front of the vehicle and release. This will lock all doors but will not arm the alarm.

To unlock: Turn the key blade towards the rear of the vehicle and release. If the security system is disarmed, all doors and the luggage compartment will be unlocked. If the security system is armed, only the front left-hand door will unlock.

If the vehicle is unlocked using the emergency key blade with the security system armed, the alarm will sound when a door is unlocked. To deactivate the alarm, press the unlock button on the Jaguar Smart Key or press the engine START/STOP button with the Smart Key inside the vehicle.

Replacing the door lock cover:

1. Align the cover to engage the bottom 2 clips.
2. Push the top of the cover to engage the upper clip.