

SJ1732

To install an ISOFIX seat:

1. Push the adult seat belts buckles into their stowage recesses.
2. Locate the lower anchor bars which are accessible through the gaps in the seat back.
3. Slide the child seat locking mechanisms through the trimmed apertures to engage with the anchor bars.
4. Test the security of the child restraint. To do this, attempt to pull the restraint away from the vehicle seat and twist the restraint from side to side. Even if the restraint appears secure you should always check the anchor points visually to ensure correct attachment.

**Note:** Always ensure that if an upper tether is provided, it is fitted and tightened correctly.

## INSTALLING TETHER ANCHORAGE CHILD RESTRAINTS



Child restraint anchorages are designed to withstand only those loads imposed by correctly fitted child restraints. Under no circumstances are they to be used for adult seat belts, harnesses or for attaching other items or equipment to the vehicle.

### Coupe vehicles

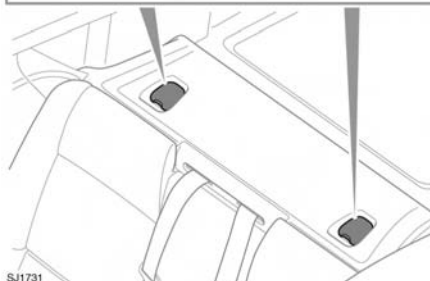
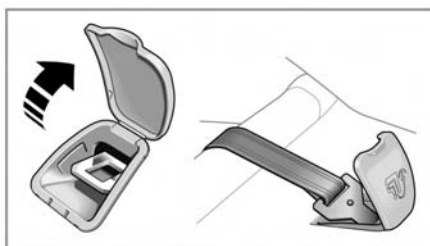

SJ1731

1. Install the child restraint securely in one of the rear seating positions.
2. Pass the tether strap over the seat back.
3. Attach the tether strap hook to the tether anchor point on the back of the seat. Ensure that the tether strap hook is facing the correct way.
4. Tighten the tether strap according to the manufacturer's instructions.

## Convertible vehicles (Australia only)

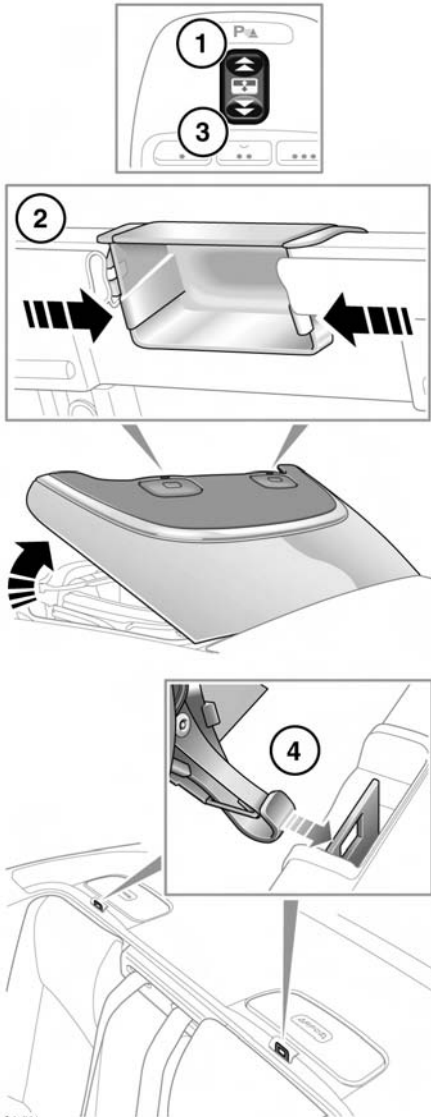

SJ1730

1. Open the tonneau panel by briefly pressing and holding the front of the convertible roof switch.
2. Remove the appropriate top tether cover and stow it in the glove box.
3. Close the tonneau panel by briefly pressing and holding the rear of the convertible roof switch.
4. Attach the child restraint top tether clip to the top tether anchorage bracket as shown.