

Wipers and washers

WIPER OPERATION

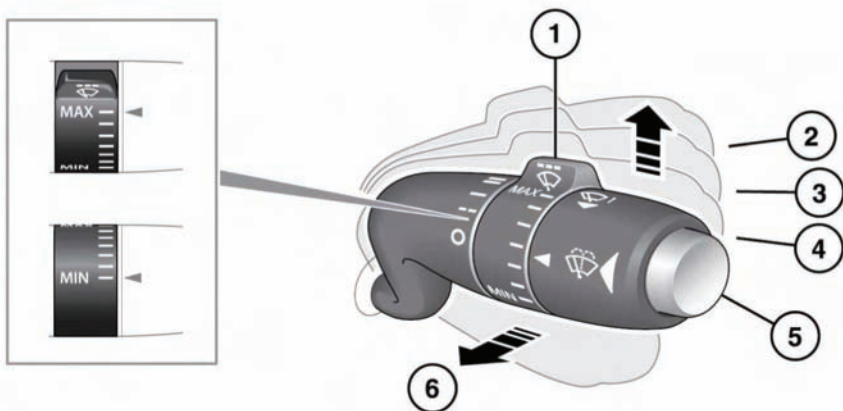

E132404

1. Rotate control to adjust sensitivity.
 - Rain sensor maximum sensitivity.
 - Rain sensor minimum sensitivity.
2. Fast speed wipe.
3. Normal speed wipe.
4. Rain sensor activated wipe (AUTO).
5. Windscreen washer button.
6. Single wipe.

- ⓘ Do not operate the windscreen wipers on a dry screen.
- ⓘ In freezing or very hot conditions, ensure that the wipers have not stuck to the windscreen before operating.
- ⓘ Remove any snow, ice or frost from the windscreen, around the wiper arms and blades, and the screen scuttle, before operating the wipers.

Note: If the wiper blades become stuck or jammed, an electronic cut-out may temporarily halt wiper operation. If this happens, switch off the wipers and the ignition. Clear any obstructions and free the wiper blades, before attempting to switch on the ignition.

SPEED-DEPENDENT MODE

If vehicle comes to a stop with the wipers operating, the wipers will switch to the next lowest speed. When vehicle speed increases to over 10 km/h (6 mph), the original wiper speed settings are restored.



This function can be configured by your Dealer/Authorised Repairer.

RAIN SENSOR

- ⓘ Ensure that the wipers are switched off before entering a car wash. If the rain sensitive wipers operate during the car washing process damage may occur to the wiper mechanism.
- ⓘ During frosty conditions ensure that **AUTO** is not selected before operating the ignition system as damage to the wiper blades can occur when the windscreen is frozen.