

FUSE BOX LOCATIONS

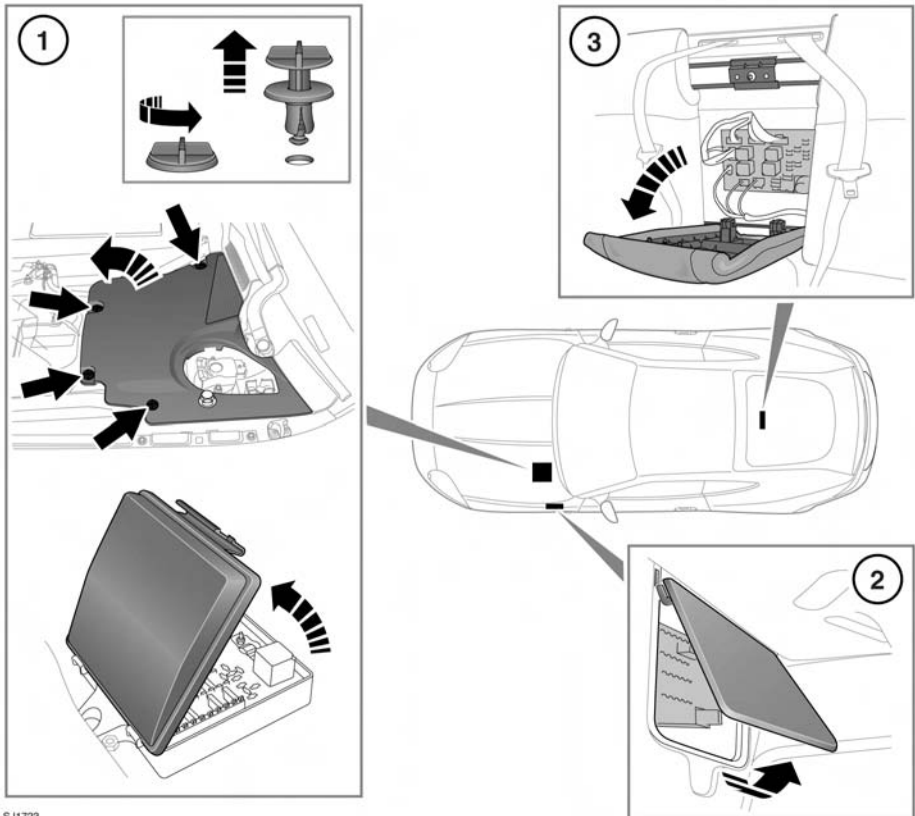

SJ1723

- !** When a fuse box lid is removed, take care to protect the box from moisture, and refit the lid at the earliest opportunity.

There are three separate fuse boxes fitted to the vehicle, each one containing fuses protecting a different group of circuits.

1. The engine compartment fuse box.

- Release the turnbuckles and remove engine cover.
- Press the release catches and remove fuse box cover.

2. The passenger compartment fuse box.

- Remove the side trim panel.

3. The rear seat compartment fuse box.

- Remove the rear seat centre section, grasp the sides of the section and pull sharply.
- When refitting the rear seat centre section, ensure that the locating/securing holes are aligned with their respective holes before pushing the section fully home.