

REAR FOG LAMPS

CAUTION

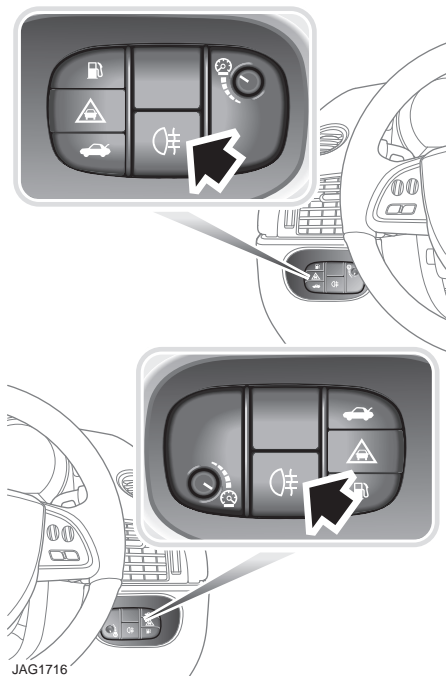

Only use the fog lamps when visibility is severely restricted by fog.



The rear fog lamps can only be switched on if the low beam headlamps are on.

Press the switch to turn on the rear fog lamps. Press the switch again to turn the lamps off.

Note: The fog lamps will be turned off when the ignition system is turned off, but will need to be reselected when the ignition system is turned on again.

HAZARD WARNING FLASHERS



Press the switch to turn the hazard warning lamps on. When the hazard warning flashers are operating, the indicator warning lamps will flash in time with the hazard warning flashers.

Press again to turn the hazard warning flashers off.

Hazard warning flashers should only be used in an emergency, to warn traffic of a vehicle breakdown or approaching danger.

Note: Hazard warning flashers can be used when the ignition is on or off.