

## Introduction

The navigation system will guide the driver to a specific location on a map. The location can be selected in a number of ways, from entering an address to touching the location on the touch-screen map.

The area covered by the navigation system depends on which version of the Navigation System DVD is loaded. The driver is directed to the destination by voice guidance and/or the on-screen instructions.

## How the System Works

The system uses signals from the Global Positioning System (GPS) satellites, which allow the approximate position of the vehicle to be calculated. This is combined with information from vehicle sensors and data from the Navigation System DVD to establish the true vehicle position.

## Declaration of Conformity



This navigation system conforms to the above standard, Directive 99/5/EC.

## Using the System

**Caution: If the system is used for an extended period of time with the vehicle stationary, ensure that the engine is running, to avoid draining the battery.**

For best results, always use the latest version of the Navigation System DVD (navigable map database). Map information is regularly updated, but all areas are not necessarily covered to the same level of detail. Some areas, in particular private roads, may not be included on the database (non-digitised roads).

While driving under route guidance, follow an instruction only when it is safe to do so, as the system cannot be aware of changing conditions, for example turn restrictions, roadworks or diversions. Use voice guidance as much as possible, and only view the display when driving conditions permit.

## In-car telephone features

In this handbook, some features shown are only available when the vehicle is fitted with the Jaguar in-car telephone installation. These features include the display of the telephone button, the end call button and one-touch dialling of POI (point of interest) numbers or memory points.

## 4-2 Navigation System – Overview

---

### Using the System (continued)



JOL1516

#### Safety Information

**IMPORTANT: Do not use the system until you have familiarised yourself with its operation.**

The road safety caution is displayed each time the ignition is switched on, and the navigation system is selected.

The caution screen gives the following information:

**Most functions are inhibited whilst the vehicle is in motion.**

**Please read the handbook for operating instructions.**

**Always obey traffic regulations.**

- To use the system, read the caution and touch **Agree**.

#### Time and Distance to Destination

When a route is calculated, the estimated time required to drive the route and the total distance to the destination are determined. The time is based on the vehicle travelling at the current speed settings for each type of road (residential, main road and motorway). The distance is based on the current route preference settings, e.g. Use Toll Roads Yes/No, see **Route preferences** on page 7-2.

While driving under guidance, the estimated time (if selected) and distance remaining to the end of the route are shown on the screen.

#### Reception of GPS Signals

GPS signals are highly directional and reception may occasionally be interrupted. Some examples of situations likely to cause problems are shown below:

- Inside tunnels.
- Inside buildings.
- Roads under raised highways.
- Densely tree-lined roads.
- Forest roads between mountains.
- Between tall buildings.
- Roads under cliffs.
- Metal objects placed on the rear parcel shelf.

Having the vehicle windows tinted using metal oxide tinting. Non-metal tinting should be used.

## Using the System (continued)

### Errors in Vehicle Position

Under certain driving conditions, it is possible that the vehicle position shown may be incorrect. Some examples are shown below:

- When the vehicle is transported by ferry or train.
- Driving on steep roads.
- After vehicle battery removal or supply fuse failure.
- When using snow chains.
- After the tyres have been replaced.
- After the vehicle has been rotated on a turntable.
- Where there are two roads parallel to each other.
- Elevated roads in proximity to other roads.
- Driving up or down circular ramps in car parks.

The position will usually be corrected automatically. If the problem persists, see **Calibration** on page 7-7, or consult your Jaguar Dealer.

### Route Guidance Precision

Under certain driving conditions, it is possible that the route guidance may be inaccurate. Some examples are shown below:

- Deviation from a route may cause incorrect guidance until the route has been recalculated.
- Route guidance may occasionally be given where no turn is required.
- If there is no road or only a narrow track to the final destination, guidance will be given to the nearest point possible.
- No guidance is given while reversing.
- If driving at high speed or on very dense road networks, it may not be possible to recalculate the route in time for the next instruction.
- On familiar roads, personal route preferences may not always be followed.

### Alternative Routes

- During route calculation, up to three possible routes are calculated. The first route is calculated using the current route preference settings. The second route is also calculated using the preference settings, except that for Minimise Time/Dist., the alternative setting is used. For example, if Minimise Time is currently selected, then the second route will be calculated based on Minimise Distance, with the other settings as selected. For the third route, the system tries to find another alternative using different combinations of the preference settings. If a suitable alternative is not possible, only the first and second routes will be shown.

## 4-4 Navigation System – Overview

---

### Using the System (continued)

#### Languages and Distance Units

The screen text and voice guidance are available in a number of different languages. For the list of available languages, see **Changing the Display Language** on page 12-1.

Distances are shown on the screen and given in voice guidance, either in Metric units (kilometres and metres) or in Imperial units (miles). For information on changing the selection, see page 1-7.

#### Town Name Lists

After entering a street name, the matching town entries found in the database are shown. Each entry includes some or all of the following: district name, town name, and county name.

#### Road Junction Layouts

The layout of complex road junctions may sometimes be shown in a simplified form. Some small roundabouts may not be shown.

#### Navigation System DVD

A navigation system DVD can cover many countries, or for larger countries, contain several search areas. To ensure you are using the correct country or search area, see **Search Area/Country Change** on page 12-1.

#### Screen Cleaning

For approved screen cleaners, see your Jaguar Dealer.

## Using the System (continued)

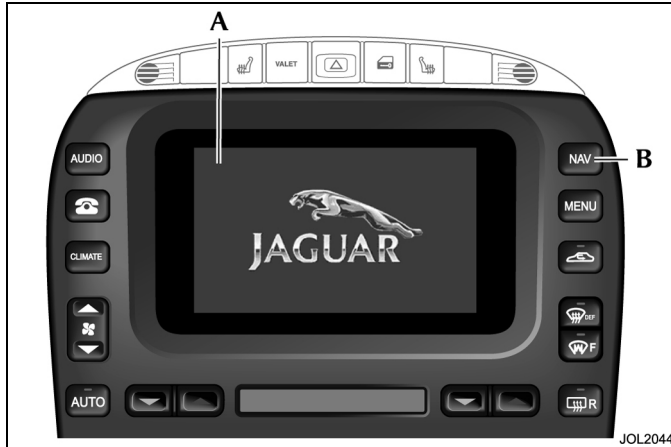

### Control Panel (The XJ shown)

A. Touch-screen.

B. NAV button.

Navigation forms part of the overall vehicle telematics system, having a combined front panel and LCD screen (A). Navigation is selected by pushing the NAV button (B). The ignition must be switched on (position 'I').

**Note:** The navigation system is operated by using the buttons displayed on the screen. For an explanation of the basic navigation buttons, see **Function of On-screen Control Icons** on page 5-7.

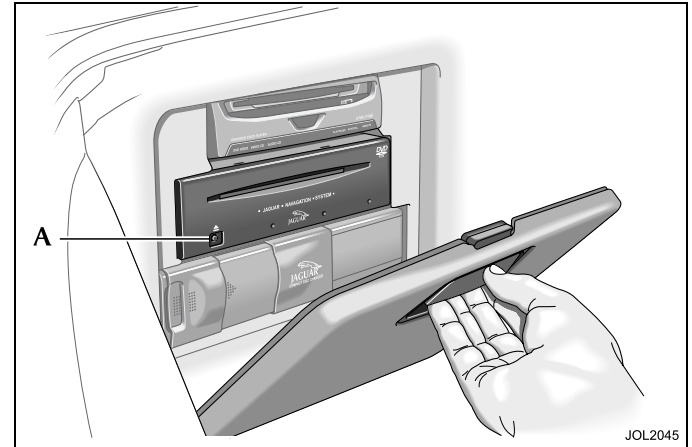

### Loading the Navigation System DVD

**Note:** The ignition must be switched on (position 'I').

1. Pull the top of the access cover forward and fold it down to the fully open position.
2. Identify the navigation unit (highlighted above) which is positioned above the sound system CD player (where fitted).
3. If a DVD is already loaded, push the eject button (A).
4. Load the Navigation System DVD with the printed side upwards. Do not allow moisture or foreign objects to enter the slot.
5. Fold the access cover to the fully closed position.

## 4-6 Navigation System – Overview

---

### Getting Started

#### NAV button



- Press the **NAV** button to select the navigation system.

The road safety caution will be displayed. Touch **Agree** to acknowledge this information (see page 4-2).

**Note:** While the navigation system is selected, the **NAV** button has the following additional functions:

- Selects the initial map display from any other screen.
- After scrolling, returns the map display to show the current vehicle position again.

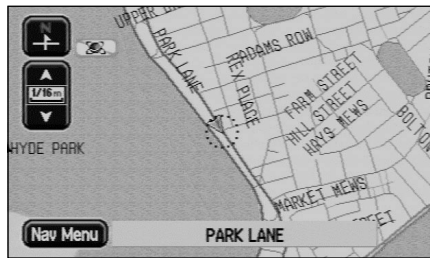

JOL2046

### Initial Map Screen

After touching **Agree**, the initial map screen showing the vehicle location is displayed, with the current road name shown in the text area at the bottom of the screen.

Section 6 gives a basic example of how to use the system to navigate to your chosen destination.

## Advanced Features of the System

### Memory Points

These are map locations (memory points) that you can store in the system memory with a personalised nametag, e.g. Doctor, or Office, for subsequent selection as a route destination or way point.

When the vehicle is fitted with

JaguarVoice, voice nametags can be used as well.

There are several methods you can use to create a memory point, e.g. entering an address, or selecting a point of interest (POI) from the database (see Section 10).

### Way Points

Way points can be used to divide a route into a number of sections, and are entered in a similar manner to the destination. As way points are entered, they are added to a list, up to a maximum of five way points.

Way points are visited in the order in which they appear in the way points list, and the order can be changed if required. After each way point has been visited, it is deleted from the way points list automatically.

### Avoid Areas

An area on the map can be selected as an avoid area, for example, a known area of heavy traffic. Up to 10 areas can be selected. Routes will then be calculated avoiding the area(s) selected, except where an alternative is not possible.

### Points of Interest (POI)

This is a database of useful names and addresses held on the Navigation System DVD, e.g. airports, hotels and restaurants. The information can be displayed and sorted by category. A POI can be selected from the list and used as a route destination or way point. Where the POI information includes a telephone number, this can be called by touching the telephone button (see Section 9).

### Quick points of interest

When this feature is selected, the map screen shows the location of all the POI's in a selected category. Each POI location is indicated by the appropriate POI icon. The category to be displayed is selected from a list of six popular categories. These can be changed to categories of your own choice.

### Voice Guidance

One or more audible instructions and/or chimes will be heard as the vehicle approaches each manoeuvre point along the route. The instruction and chime are repeated as the vehicle reaches the manoeuvre point. Voice guidance can be turned off if required, and will be muted automatically if a telephone call is in progress.

### Screen Guidance

Screen guidance is provided by means of the map display, and an overlay (the guidance screen) which shows one of the following: junction diagram, turn arrow, or turns list. Various combinations of these features can be selected, see **Display Options** on page 7-8. As the route is followed, the current street name, estimated time (if selected) and distance remaining to the end of the route are displayed.

For further information, see **Screen Types** on page 11-9.

## 4-8 Navigation System – Overview

---

### End User Licence Agreement for Ordnance Survey Data

Please read this agreement carefully before using the Navigation System.

This is a licence agreement to use the Ordnance Survey (OS) Code-Point data incorporated in the Navigation System. By using this Code-Point data you accept and agree to all the terms and conditions below.

### Ownership

The OS Code-Point data is licensed by Ordnance Survey with permission of Her Majesty's Stationery Office.  
© Crown Copyright 2002. All rights reserved.

### Licence grant

OS grants you a non-exclusive licence to use your copy of the OS Code-Point data for your personal use solely as part of the Navigation System. You may transfer the licence to a subsequent purchaser of the vehicle with which the Navigation System is supplied, provided that the purchaser agrees to abide by each of the terms of this licence.

### Limitations of use

The OS Code-Point data is restricted for use in the specific system for which it was created. Except to the extent explicitly permitted by mandatory applicable laws, you may not extract or re-utilise any part of the contents of the OS Code-Point data, not reproduce, copy, modify, adapt, translate, disassemble, decompile, or reverse engineer any portion of the OS Code-Point data.

### Limitation of liability

Ordnance Survey does not warrant or represent that any of the Code-Point data is accurate, error-free or suitable for your purposes. In no event shall OS or the supplier of the Navigation System using the OS Code-Point data be liable for any consequential, special, incidental or indirect damages for any direct or indirect loss of revenue, profits, business, data, or use, incurred by you or any third party arising out of your use of the OS Code-Point data, whether in an action in contract or tort (including negligence and breach of statutory duty) or otherwise, even if OS or the supplier of the Navigation System has been advised of the possibility of such damages. In any event, OS's liability for direct damages is limited to the price of the

copy of the OS Code-Point data. Nothing in these licence terms shall operate to exclude or limit any liability which cannot be excluded or limited by law.

THE DISCLAIMER OF WARRANTY AND LIMITATION OF LIABILITY, SET FORTH IN THIS AGREEMENT, DO NOT AFFECT OR PREJUDICE YOUR STATUTORY RIGHTS WHERE YOU HAVE ACQUIRED THE DATABASE OTHERWISE THAN IN THE COURSE OF A BUSINESS.

These licence terms are governed by English Law and are subject to the exclusive jurisdiction of the English courts.

## **End User Licence Agreement for Navigation Technologies Data**

Please read this agreement carefully before using the Navigation System.

This is a licence agreement for your copy of the Navigable Map Database, (the 'DATABASE') originally made by Navigation Technologies), used in the Navigation System. By using this DATABASE you accept and agree to all the terms and conditions below.

### **Ownership**

The DATABASE and the copyrights and intellectual property or neighbouring rights therein are owned by NAVTECH or its licensors.

### **Licence grant**

NAVTECH grants you a non-exclusive licence to use your copy of the DATABASE for your personal use or for use in your business' internal operations. This license does not include the right to grant sub-licenses.

### **Limitations of use**

The DATABASE is restricted for use in the specific system for which it was created. Except to the extent explicitly permitted by mandatory applicable laws, you may not extract or re-utilise substantial parts of the contents of the DATABASE, not reproduce, copy, modify, adapt, translate, disassemble, decompile, or reverse engineer any portion of the DATABASE.

### **Transfer**

You may not transfer the DATABASE to third parties, except together with system for which it was created, provided that you do not retain any copy of the DATABASE, and provided that the transferee agrees to all terms and conditions of this agreement.

### **Disclaimer of warranty**

NAVTECH does not warrant or make any representations regarding, either express or implied, regarding the use or results of the use of the DATABASE in terms of its correctness, accuracy, reliability, or otherwise and expressly disclaims any implied warranties of quality, performance, merchantability, fitness for a particular purpose or non-infringement.

NAVTECH does not warrant that the DATABASE is or will be error-free. No oral or written information or advice provided by NAVTECH, your supplier or any other person shall create a warranty.

### **Limitation of liability**

The price of the DATABASE does not include any consideration for assumption of risk of consequential, indirect or unlimited direct damages which may arise in connection with your use of the DATABASE. Accordingly, in no event shall NAVTECH or supplier of the navigation system using the DATABASE ('Supplier') be liable for any consequential, special, incidental or indirect damages, including without limitation, loss of revenue, data, or use, incurred by you or any third party arising out of your use of the DATABASE, whether in an action in contract or tort or based on a warranty, even if NAVTECH or the Supplier has been advised of the possibility of such damages. In any event, NAVTECH's liability for direct damages is limited to the price of your copy of the DATABASE.

## 4-10 Navigation System – Overview

---

THE DISCLAIMER OF WARRANTY AND LIMITATION OF LIABILITY, SET FORTH IN THIS AGREEMENT, DO NOT AFFECT OR PREJUDICE YOUR STATUTORY RIGHTS WHERE YOU HAVE ACQUIRED THE DATABASE OTHERWISE THAN IN THE COURSE OF A BUSINESS.

Some states and laws do not allow the exclusion of implied warranties, so the above disclaimer may not apply to you.



### **WARNING:**

**The DATABASE reflects reality as existing before you received the DATABASE and it comprises data and information from government and other sources, which may contain errors and omissions.**

**Accordingly, the DATABASE may contain inaccurate or incomplete information due to the passage of time, changing circumstances, and due to the nature of the sources used. The DATABASE does not include or reflect information on – inter alia – neighbourhood safety; law enforcement; emergency assistance; construction work; road or lane closures; vehicle or speed restrictions; road slope or grade; bridge height, weight or other limits; road or traffic conditions; special events; traffic congestion; or travel time.**

### **Government end users**

If the DATABASE is for a region of North America and is being acquired by or on behalf of the United States government or any other entity seeking or applying rights similar to those customarily claimed by the United States government, the DATABASE is licensed with 'limited rights'.

Utilization of the DATABASE is subject to the restrictions specified in the 'Rights in Technical Data and Computer Database' clause at DFARS 252.227–7013, or the equivalent clause for non-defence agencies. Manufacturer of the DATABASE of North America is Navigation Technologies Corporation, 10400 W. Higgins Road, Suite 400, Rosemont, Illinois 60018, USA.