

# Vehicle Recovery

---

## METHODS OF RECOVERY

The preferred vehicle recovery method is by using a flat bed transporter or rear suspended tow.

### Caution:

- If the vehicle has defective transmission, to prevent further damage, it must be towed with the rear wheels clear of the ground.
- Ensure that the recovery team do not tow with sling-type equipment since damage to the bodywork may result.
- Do not tow vehicle by suspending the front end.

### Vehicle failure

The removable towing eye is primarily for emergency use when towing for SHORT DISTANCES, e.g. removing the vehicle if it is causing an obstruction or for winching the vehicle onto a recovery transporter.

To prevent damage to the automatic transmission whilst the vehicle is being towed with the rear wheels on the ground, towing distance must be restricted to 0.8 kilometres (0.5 miles). Towing speed must not exceed 48 km/h (30 mph).

Always obey towing regulations. In certain countries the registration number of the towing vehicle and an ON TOW sign or warning triangle must be displayed in a prominent position at the rear of the vehicle being towed.

When being towed, the vehicle's gear selector lever must be in neutral (position **N**) with the ignition key turned to position **II** to release the steering lock and render the indicators, horn and brake lights operational.



### WARNING:

**When the engine is not running the steering and brakes will no longer be power-assisted. Therefore, be prepared for relatively heavy steering and the need for greatly increased brake pedal pressure.**

# Vehicle Recovery

---

## Transporting

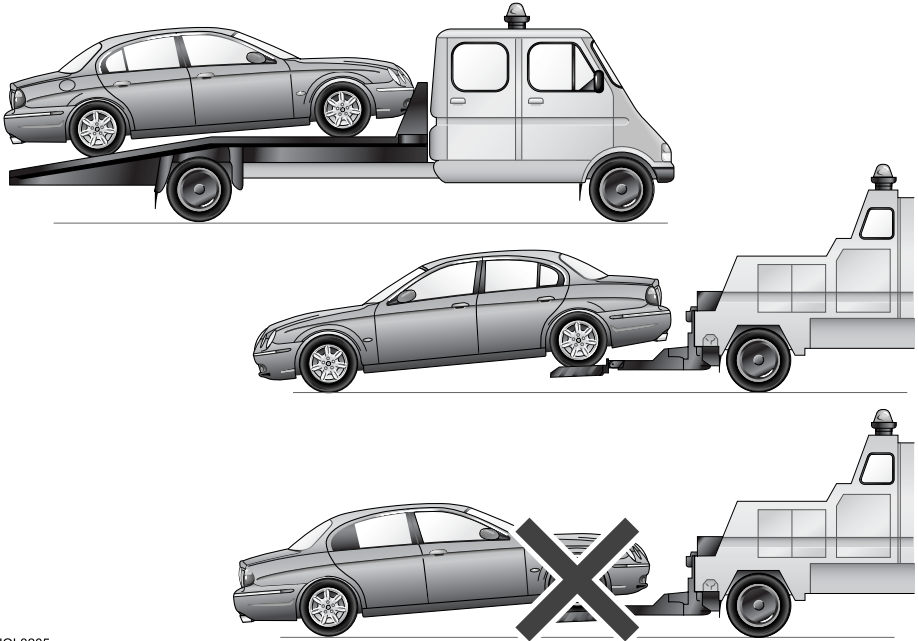

JOL3205

If the vehicle is being transported on a trailer or vehicle flat bed transporter, the parkbrake must be applied, the wheels chocked and the gear selector lever moved to position **N** or **D** but **NEVER** to **P**.

The vehicle must be securely tied down to the transporter or trailer. Use straps on the front wheels/tyres to secure the vehicle for transportation.

The towing eye is not designed for securing the vehicle during transportation.

# Vehicle Recovery

## TOWING EYE

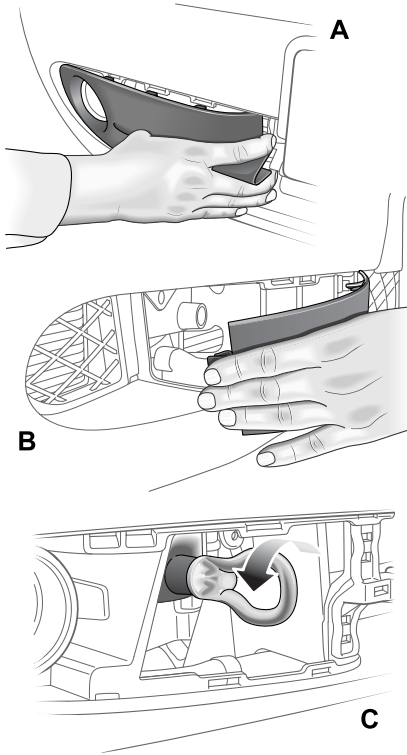

A screw-in towing eye is provided in the luggage compartment with the jack and can be fitted to the front or rear of the vehicle. The towing eye has a left-hand thread and must be screwed in an anti-clockwise direction when fitting.

### Caution:

- The towing eye is not suitable for solid bar towing.
- Care must be taken to avoid damaging the bumpers and front apron.

### Front tow point

The front towing point is located behind a plastic cover on the left-hand side of the vehicle (as viewed from the front).

To remove the cover (A), press the plastic cover to the left to unclip. Remove the cover.

On R performance vehicles, press the plastic cover (B) to the right to unclip. Remove the cover.

Screw the towing eye into the vehicle, right up to the shoulder, turning anti-clockwise (C).

### Rear tow point (D)



**WARNING:**  
Avoid body contact with a hot exhaust pipe when fitting the eye to the rear towing point.

The rear towing point is alongside the left-hand exhaust pipe.

Remove the small cover from the bumper. Remove the bung and screw the towing eye into the vehicle, right up to the shoulder, turning anti-clockwise.

JOL2870