

Inertia Switch

Locating the Inertia Switch

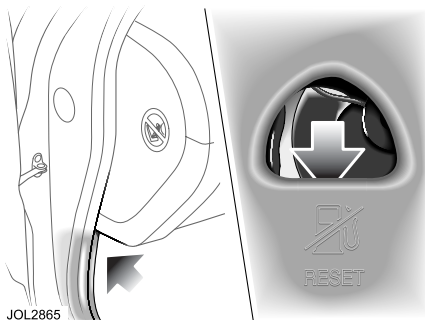

In the event of an accident, an inertia switch may trip, isolating fuel pump operation. Once the switch has tripped it must be reset before attempting to restart the engine.

The inertia switch is located behind the trim on the left-hand side of the vehicle, forward of the front door post, below the fascia. A finger access hole in the trim allows the driver to reset the switch.

Resetting the Switch



WARNING:

To avoid the possibility of fire or personal injury, do not reset the inertia switch if you see or smell fuel.

If no fuel leak is apparent, reset the inertia switch as follows:

1. Turn the ignition switch to position '0'.
2. Press down the rubber reset button on the top of the inertia switch.
3. Turn the ignition switch to position 'II', pause for a few seconds, then return the key to position '0'.
4. Make a further check for fuel leaks.

Emergency Starting

Rolling Start

If the vehicle battery is discharged, inserting the ignition key may not release the electronically controlled steering lock. Also, if the electric parkbrake was applied before the battery was discharged (e.g. vehicle unused for a long period), it will not be possible to release the parkbrake.

In this situation, a manual transmission vehicle cannot be pushed or tow started. If the parkbrake has not been applied, it could be dangerous to attempt to move the vehicle with the steering locked.

Do not push or tow start a vehicle with automatic transmission even with the steering lock and parkbrake released. With a discharged battery it will also not be possible to move the drive selector from the 'P' position.



WARNING:

A vehicle start by pushing or towing must not be attempted because it is possible that the steering lock may not be disengaged. Only jump lead starting or the fitting of a fully charged battery is recommended.

Emergency Starting Using Jump Leads

Both the booster and discharged battery should be treated with great care when using jump leads. Always use high quality leads capable of carrying the starter current of the vehicle to be started.

Before commencing, the following precautions must be taken:

- When the battery of another vehicle is being used, ensure that the vehicles do not touch. Alternatively, remove the charged battery and place near to, not on, the vehicle with the discharged battery.
- Ensure that both vehicles have all electrical services OFF, the parkbrakes applied and neutral (manual transmission) or 'P' (automatic transmission) selected.
- Where the jump leads are of a different colour, e.g. red and black, use red for positive (+). This aids identification and helps to avoid crossing positive (+) to negative (-). Take extra care to avoid crossing the polarity when using cables of the same colour.

Caution:

- **If using a jump start vehicle, under no circumstances should the vehicles come into contact with each other. This could establish an earth connection, which may cause sparks and damage.**
- **Do not run the jump start vehicle's engine when boost starting a Jaguar vehicle. If the jump start vehicle's engine is running and the jump leads are disconnected, damage to the Jaguar vehicle's electrical system will result.**
- **The booster battery must be of the 12 volt type.**

Emergency Starting

To gain access to the battery, fold the luggage compartment floor panel forward. If a space saver spare wheel is fitted it will be necessary to remove the under floor stowage tray.

Procedure for using jump leads

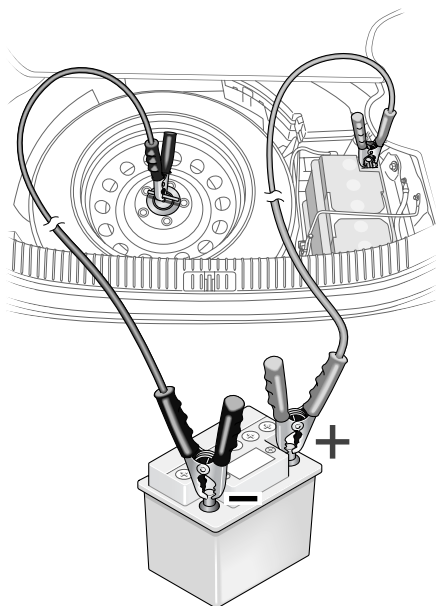

JOL2866

The following procedure must be followed exactly, being careful not to cause sparks:

1. Unclip the battery positive (+) terminal cover.
2. Attach one end of the red jump lead to the positive (+) terminal of the booster battery and the other end to the positive (+) terminal of the discharged battery. Make sure that a good connection is made.

Caution: Do not connect the negative jump lead directly to the negative (-) terminal of the discharged vehicle.

3. Attach one end of the black jump lead to the negative (-) terminal of the booster battery and the other end to an earth point on the vehicle being started. (If your Jaguar has the discharged battery use only the spare wheel locking stud, as shown.) The earth point must be at least 305 mm (12 inches) from the discharged battery. Make sure that a good connection is made.
4. When started, allow the engine to idle for five minutes before disconnecting the cables.
5. Disconnect the black jump lead from the earth point and the booster battery negative (-) terminal.
6. Disconnect the red jump lead from the positive (+) terminals of both batteries.
7. Refit the positive (+) terminal cover.
8. Refit the luggage compartment floor panels.

After starting the engine, it may be necessary to reset the electric parkbrake (refer to page 128). See also 'After battery reconnection', page 207.

Wheel Changing

Overview

Be prepared for a flat tyre. Know where equipment is stowed and read the wheel changing and jacking instructions carefully.

Pull off the road completely, clear of all traffic and park on as level, solid ground as possible. Switch on hazard warning lights and, where legally required, display the warning triangle.



WARNING:

- It can be dangerous to change a wheel when the vehicle is on a slope or soft, uneven ground
- Wheels are extremely heavy. Take care when lifting and particularly when removing and replacing a wheel in its storage position in the luggage compartment.

Spare Wheel Location

The spare wheel and jacking equipment are stored under the luggage compartment floor panel.

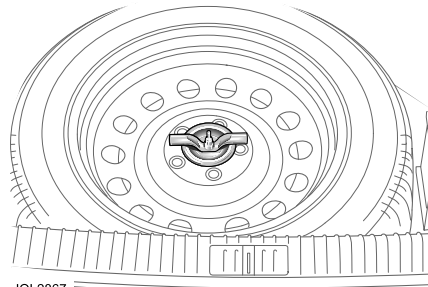
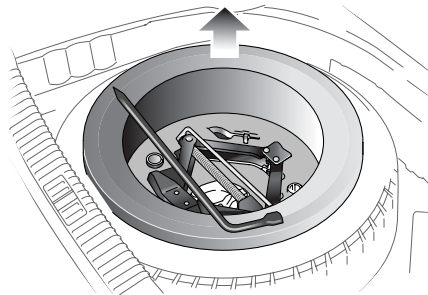
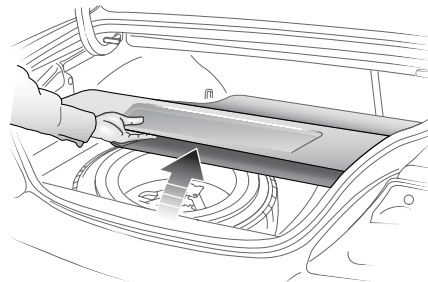

JOL2867

To remove the spare wheel, fold the luggage compartment floor panel towards the rear seats. Remove the tray containing the jacking equipment to gain access to the wheel. Unscrew the retaining nut and remove the spare wheel. Remove the jack and wheel nut wrench.

Wheel Changing

Temporary-use Spare Wheel

Observe the following warnings before using the wheel:



WARNING:

- Please note temporary-use spare wheel warning label. Adhere to instructions on the label. Failure to comply can be dangerous.
- When a temporary-use spare wheel is fitted, drive with caution and replace with the specified wheel and tyre as soon as possible.
- Do not fit more than one temporary-use spare wheel and tyre assembly at one time.
- The temporary-use spare wheel must be inflated to the correct pressure.
- Temporary-use spare wheel, maximum speed is 80 km/h (50 mph).

Note: Maintenance information for the temporary-use spare wheel is the same as given for normal tyres. See page 210.

Locking Wheel Nuts

Where Jaguar locking wheel nuts are fitted (one on each wheel), they can only be removed using the correct key socket.

The locking wheel nut comprises two grooved parts, front and rear, which must be turned together to allow the nut to be fitted or removed.

To remove the nut, the front and rear grooves must be aligned. Locate the key socket in the grooves and push it fully over both parts of the nut. Fit the wheel nut wrench over the key socket and loosen the locking wheel nut.

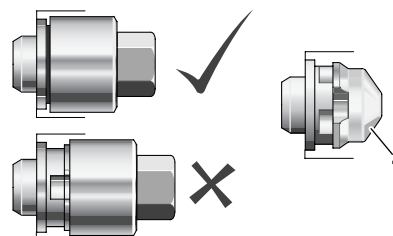
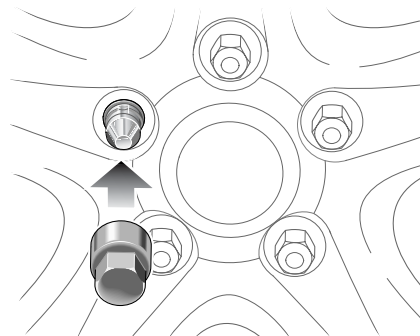

JOL2666

Attempting to remove the nut without the correct key socket (such as attempted theft) or with the socket not located over the rear part of the nut, will cause the front part (1) only to turn.

If this has happened, rotate the front part with the key socket until the grooves are re-aligned and then push the socket fully over the nut.

Should a new key socket be required, contact your Jaguar Dealer. Proof of vehicle ownership will be required.

Wheel Changing

Wheel Changing

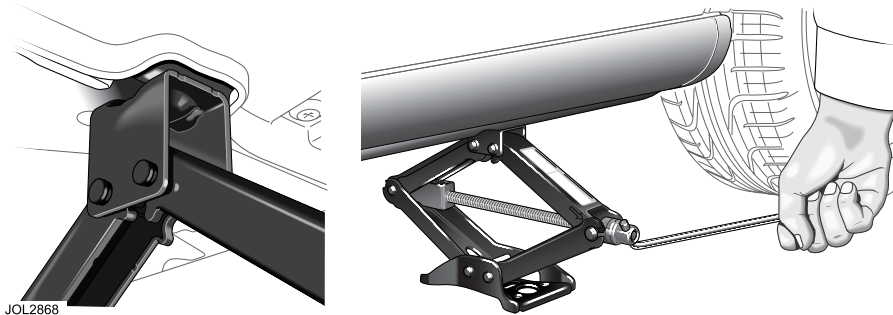

1. Ensure that all passengers are in a safe place, clear of the vehicle.
2. Apply the parkbrake and select gear position 'P' (Park) or select a low gear on a manual transmission vehicle.
3. Ensure that the jack is placed on firm and level ground.

Note: When one rear wheel is lifted off the ground the selection of a low gear on manual vehicles or automatic transmission 'P' (Park) position will not prevent the vehicle from moving and possibly slipping off the jack.



WARNING:

- Before attempting to lift the vehicle with the jack, chock the wheel diagonally opposite to the wheel being replaced to prevent the vehicle from rolling when jacked up. A wheel chock is supplied with the jacking equipment for this purpose.
- Never work under the vehicle using only the jack as a support, always use axle stands or suitable supports under the jacking points.

Before raising the vehicle slacken but do not remove the wheel nuts.

Observe the instructions printed on the jack.

Use the jack only for lifting the vehicle during wheel changing, and only use the jack which is stored in the vehicle.

Do not start or run the engine while the vehicle is only supported by a jack.

There are four jacking points, two each side of the vehicle on the underside of the floor. These provide positive location for the jack. The front jacking point is approximately 180 mm (7 inches) from the front wheel and the rear is approximately 280 mm (11 inches) forward of the rear wheel.

The simplest way to correctly locate the jacking point is to feel along the sill panel to the cut-away portion and then fit the jack to the body, not to the sill panel.

Wheel Changing

Caution: Ensure before raising the vehicle that the jack is correctly positioned to avoid any damage to the vehicle sills or sill panels. Use only the correct jacking points, never use bumpers or any other part of the body to lift the vehicle.



WARNING:

- Do not attempt to lift the vehicle unless the jack head is fully engaged in the jacking point.
- Ensure that the parkbrake is applied.

Place the jack squarely beneath the appropriate jacking point. Ensure that the jack head is fully engaged. Carefully raise the vehicle by turning the handle. Stop jacking the vehicle when the tyre just clears the ground. Minimum tyre lift gives maximum vehicle stability.

Remove the wheel nuts and the wheel.

When changing the alloy road wheels, transfer the centre badge to the replacement wheel (when a full size spare wheel is used). Using the plastic tipped end of the wheel nut wrench handle from the inside of the wheel, push the centre badge from its housing. Push the centre badge into the replacement wheel. If the temporary-use spare wheel is to be fitted, keep the centre badge safely and fit it to the repaired full size wheel when it has been refitted.

Fit the spare wheel and loosely secure with the wheel nuts.

Using the wheel nut wrench, lightly tighten the wheel nuts alternately using the sequence shown in the illustration.

Tightening the wheel nuts

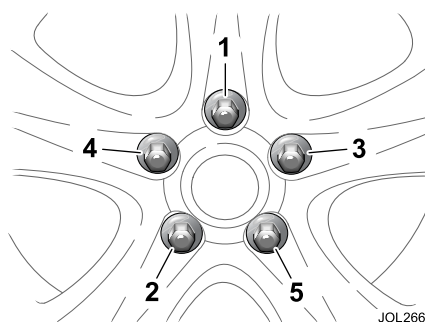

Lower the jack and tighten the wheel nuts alternately, DO NOT OVERTIGHTEN.

At the earliest opportunity have the wheel nuts tightened with a torque wrench to 125 Nm (92 lb.ft).

This torque must not be exceeded.

Stowing the equipment

Stow the replaced road wheel in the luggage compartment, position the wheel and secure with the retaining nut.

Place the storage tray with the jack and wrench over the wheel.

Reposition the luggage compartment floor panel.

Note: Examine the jack occasionally and clean and grease the threads to ensure it is always ready for an emergency.



WARNING:

When the temporary-use spare wheel has been fitted, drive with caution and replace with the specified wheel and tyre as soon as possible.

Vehicle Recovery

Methods of Recovery

The preferred vehicle recovery method is by using a flat bed transporter or rear suspended tow.

Caution:

- **If the vehicle has defective transmission, to prevent further damage, it must be towed with the rear wheels clear of the ground.**
- **Ensure that the recovery team do not tow with sling-type equipment since damage to the bodywork may result.**
- **Do not tow vehicle by suspending the front end.**

Vehicle failure

The removable towing eye is primarily for emergency use when towing for SHORT DISTANCES, e.g. removing the vehicle if it is causing an obstruction or for winching the vehicle onto a recovery transporter.

To prevent damage to the automatic transmission whilst the vehicle is being towed with the rear wheels on the ground, towing distance must be restricted to 0.8 kilometres (0.5 miles). Towing speed must not exceed 48 km/h (30 mph).

Always obey towing regulations. In certain countries the registration number of the towing vehicle and an 'ON TOW' sign or warning triangle must be displayed in a prominent position at the rear of the vehicle being towed.

When being towed, the vehicle's gear selector lever must be in neutral (position 'N') with the ignition key turned to position 'II' to release the steering lock and render the indicators, horn and brake lights operational.



WARNING:

When the engine is not running the steering and brakes will no longer be power-assisted. Therefore, be prepared for relatively heavy steering and the need for greatly increased brake pedal pressure.

Vehicle Recovery

Transporting

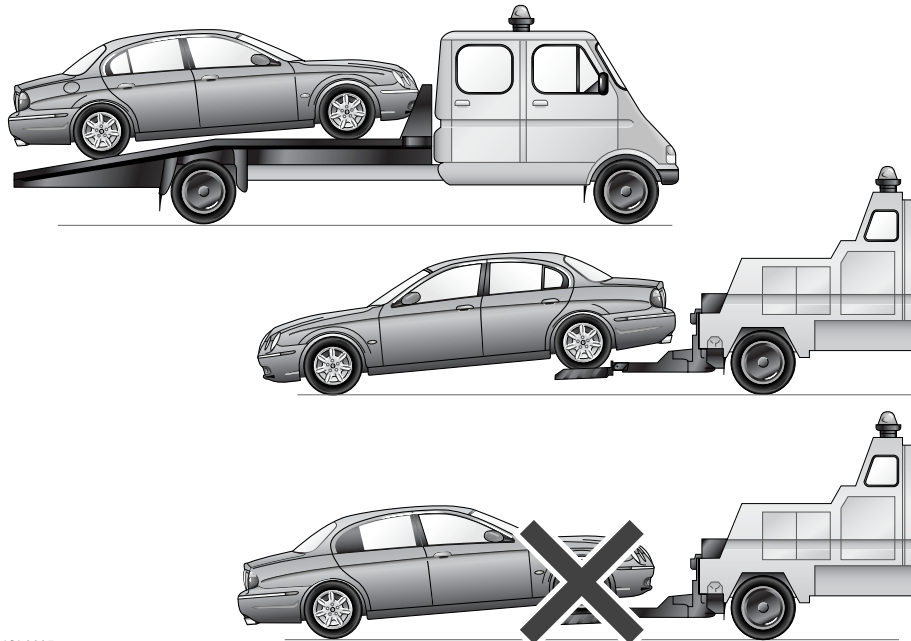

JOL3205

If the vehicle is being transported on a trailer or vehicle flat bed transporter, the parkbrake must be applied, the wheels chocked and the gear selector lever moved to position 'N' or 'D' but NEVER to 'P'.

The vehicle must be securely tied down to the transporter or trailer. Use straps on the front wheels/tyres to secure the vehicle for transportation.

The towing eye is not designed for securing the vehicle during transportation.

Vehicle Recovery

Towing Eye

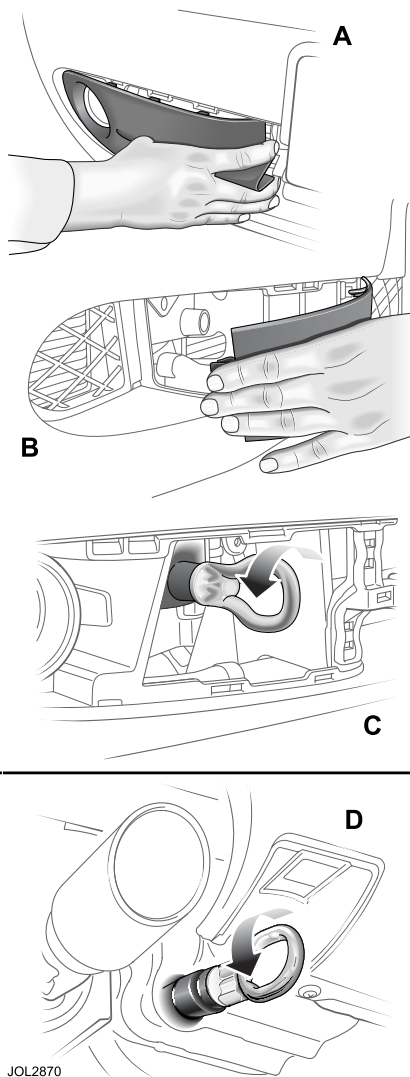

JOL2870

A screw-in towing eye is provided in the luggage compartment with the jack and can be fitted to the front or rear of the vehicle. The towing eye has a left-hand thread and must be screwed in an anti-clockwise direction when fitting.

Caution:

- The towing eye is not suitable for 'solid bar' towing.
- Care must be taken to avoid damaging the bumpers and front apron.

Front tow point

The front towing point is located behind a plastic cover on the left-hand side of the vehicle (as viewed from the front).

To remove the cover (A), press the plastic cover to the left to unclip. Remove the cover.

On 'R' performance vehicles, press the plastic cover (B) to the right to unclip. Remove the cover.

Screw the towing eye into the vehicle, right up to the shoulder, turning anti-clockwise (C).

Rear tow point (D)



WARNING:

Avoid body contact with a hot exhaust pipe when fitting the eye to the rear towing point.

The rear towing point is alongside the left-hand exhaust pipe.

Remove the small cover from the bumper. Remove the bung and screw the towing eye into the vehicle, right up to the shoulder, turning anti-clockwise.

Bulb Renewal

Overview

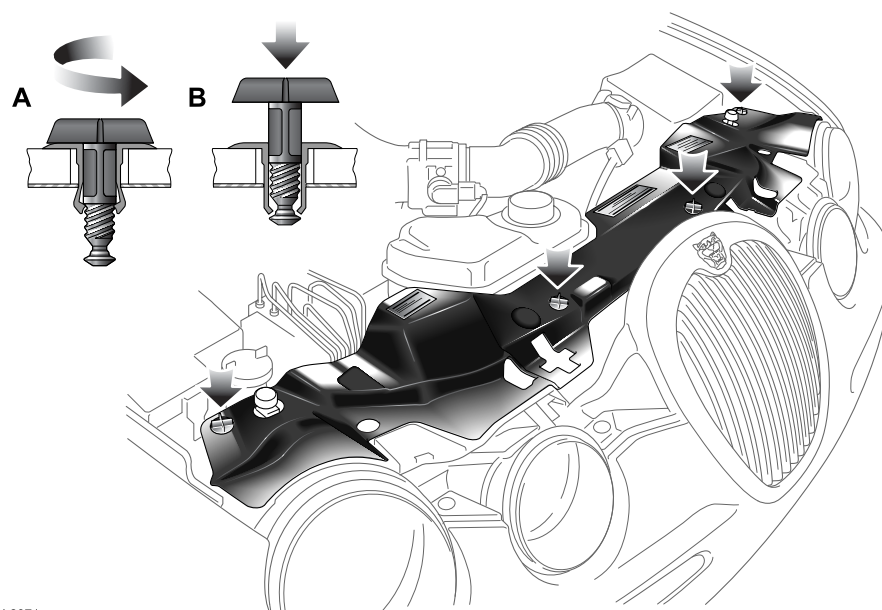

JOL2871

It is important that only Jaguar bulbs of the type specified are used when renewing bulbs.

Before renewing bulbs, switch off the ignition and light switches.

Top cover

To gain access to the headlight units, the top cover must be removed.

Turn the fasteners **(A)** approximately one and a half turns anti-clockwise and then remove the top cover.

After changing the defective bulb, refit the cover and push the fasteners **(B)** in place to retain the cover.

Bulb Renewal

Headlight – Bulb Renewal

Halogen bulbs are used in the main beam (inner headlight) positions.

Either halogen bulbs or the optional High Intensity Discharge (HID) Xenon light system are fitted in the dipped beam (outer) headlight positions.

Where HID lighting is fitted, refer to your dealer if the headlight fails to operate.

Caution: Halogen bulbs will be damaged if touched by hand or contaminated with oil or grease. It is important to use clean gloves or cloth when handling a bulb which is to be used again. A contaminated bulb may be cleaned with methylated spirit before refitting.

Dipped beam (outer) headlight

Open the bonnet.

Remove the top cover as shown on page 175.

Turn the circular cover (1) anti-clockwise and remove.

Press the spring clip (2) towards the bulb and downwards to release the bulb.

Remove the bulb/connector (3) from the headlight assembly. Pull the connector from the bulb.

Attach the connector to the new bulb, type H7 for dipped beam, and fit to the headlight. The bulb will only correctly fit in one position.

Engage the spring clips to retain the bulb and then fit the circular cover.

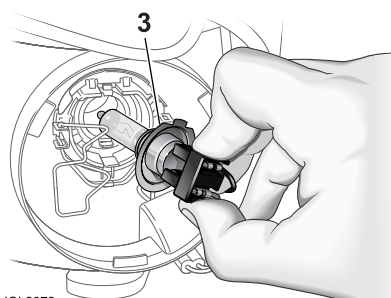
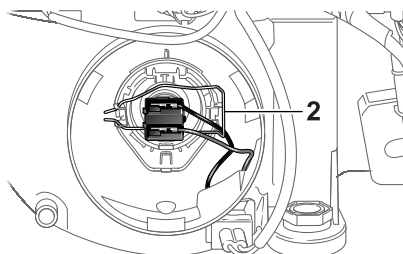
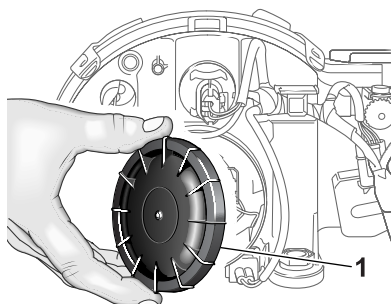

JOL2872

Refit the top cover and close the bonnet.

It is advisable to have the headlight aim checked by a Jaguar Dealer after bulb renewal.

Note: High Intensity Discharge (HID) Xenon light units, type D2S 35W, are not renewable, contact your Jaguar Dealer if the headlight fails to operate.

Bulb Renewal

Main beam (inner) headlight

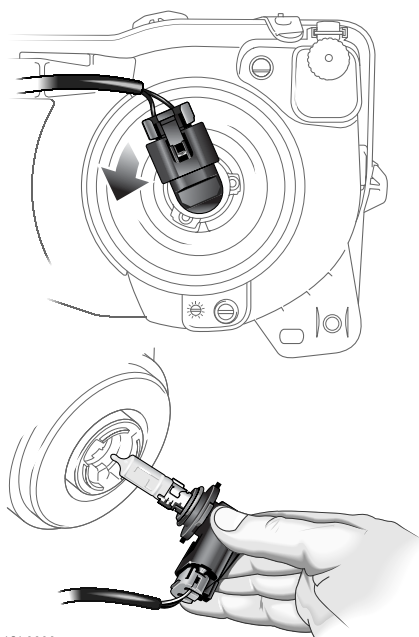

JOL3206

Open the bonnet.

Remove the top cover as shown on page 175.

Turn the bulb holder a quarter turn anti-clockwise and remove the bulb and holder from the light unit.

Fit a new bulb to the holder, type HB3 for main beam.

Fit the holder to the light unit, the bulb will only correctly fit in one position.

Refit the top cover and close the bonnet.

Front Parking (Side) Light – Bulb Renewal

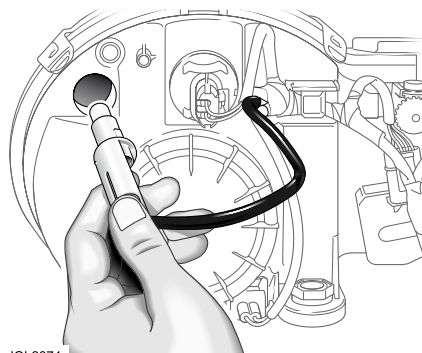

JOL2874

Open the bonnet.

Remove the top cover as shown on page 175.

The front parking lights are contained within the outer headlight units.

Rotate the bulb holder anti-clockwise and remove from the headlight.

Pull the capless bulb from the holder and fit a new one of the correct type, W5W.

Reposition the bulb holder in the headlight unit and turn clockwise.

Refit the top cover and close the bonnet.

Bulb Renewal

Front Direction Indicator – Bulb Renewal

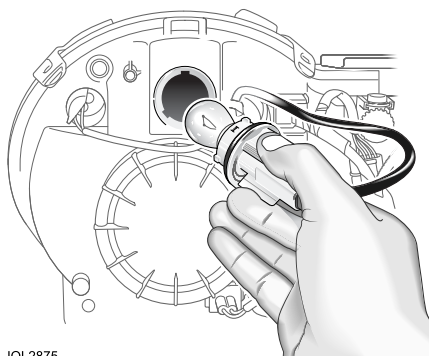

JOL2875

Remove the top cover as shown on page 175.

The bulb is contained within the outer headlight. Turn the holder a quarter turn anti-clockwise and remove the bulb and holder.

Remove the bulb and fit a new one of the correct type, PY21W.

Fit the holder to the light unit, it will only fit in one position.

Refit the top cover and close the bonnet.

Number Plate Light – Bulb Renewal

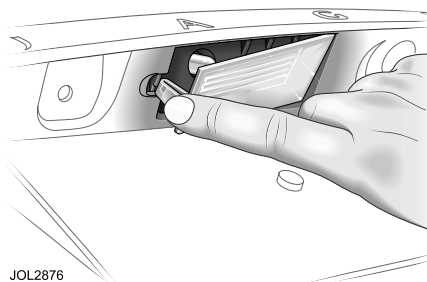

JOL2876

Push the lens clip sideways and remove the lens from the vehicle.

Remove the bulb and fit a new one of the correct type, W5W.

Refit the lens by pressing it firmly into the recess until it clicks into place.

Front Fog Light – Bulb Renewal

It is recommended that the front fog light bulb is renewed by a Jaguar Dealer.

Bulb Renewal

Side Repeater Indicator – Bulb Renewal

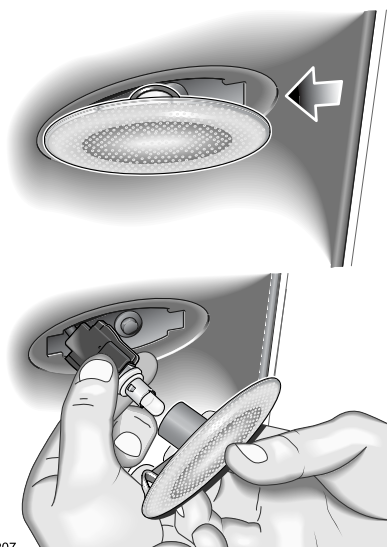

JOL3207

Remove the light unit from the front wing panel by pressing the unit forwards or rearwards to compress the spring clip and remove the complete unit.

Twist the bulb anti-clockwise and remove.

Fit a new bulb of the correct type, W5W.

Press the unit into the recess until it clicks into place.

Rear Light Assembly – Bulb Renewal

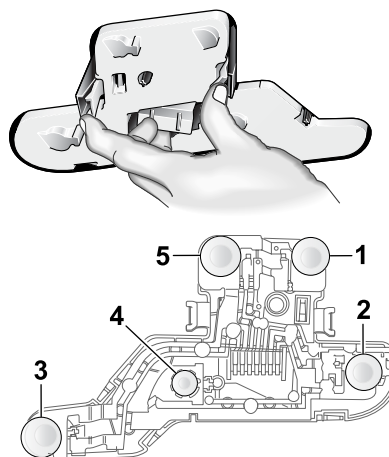

JOL3261

The rear light assembly has the following bulbs:

1. Reverse light, type P21W.
2. Stop/tail light, type P21/4W.
3. Fog light, type P21W.
4. Tail light, type R5W.
5. Direction indicator, type PY21W.

Ensure that the lights and ignition switch are OFF before removing any bulbs.

Open the luggage compartment, release the side carpet retaining clip and unclip the rear light bulb carrier.

Remove the faulty bulb and fit a new one of the correct type, as illustrated on the bulb holder. Fitment of the correct type is essential.

Refit the bulb carrier assembly, ensuring that the clips are correctly secured.

Refit the carpet.

Fuses

Fuses

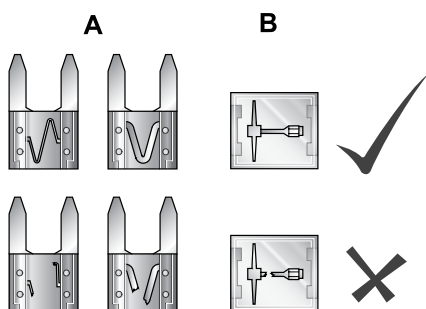
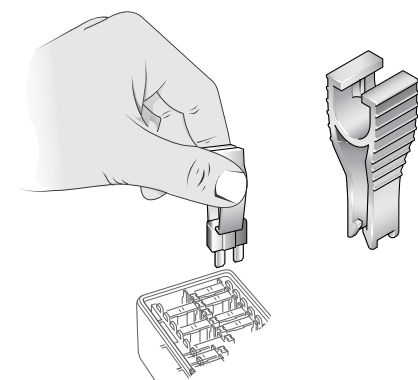

JOL3208

Fuse failure is identified by an inoperative circuit.

Do not fit a new fuse if the wiring is damaged; contact a Jaguar Dealer. After renewing a fuse have the circuit checked by a Jaguar Dealer.

Two types of fuses are fitted in the fuse boxes, a mini-type (A) and a cartridge-type (B).

A special tool for removing and replacing mini-fuses is provided in the engine compartment fuse box, together with spare fuses.

Use only the spare fuses supplied. If a spare fuse is used, renew it with a Jaguar approved fuse of the same amperage rating.

Checking and Renewing a Blown Fuse

It is highly recommended that only the mini-type fuses are replaced by the owner. All other fuses and relays should be replaced by a Jaguar Dealer or roadside assistance.

Make sure the new fuse is the correct rating (amperage).

Fuses are colour coded according to the amperage and the rating is also marked on each fuse.

The colour code is as follows:

Tan	5 amp
Brown	7.5 amp
Red	10 amp
Blue	15 amp
Yellow	20 amp
Clear	25 amp
Green	30 amp
Bright Orange	40 amp

Mini-fuse replacement

Push the tool on to the suspect mini-fuse and withdraw it.

If the wire in the fuse is broken, the fuse has blown.

Fit a new fuse using the tool.

Fuses

Cartridge fuse replacement

It is advisable to have these fuses changed by a Jaguar Dealer when blown.

Pull the suspected blown fuse from its holder.

If the wire in the fuse is broken, the fuse has blown.

Push a new fuse into the holder.



WARNING:

- Do not fit a fuse of a different amperage from that removed. The electrical circuits may become overloaded with the subsequent possibility of a fire.
- No attempt should be made to repair a fuse that has blown as this may cause a fire hazard or serious damage elsewhere in the electrical circuit.

Fuse Box Locations

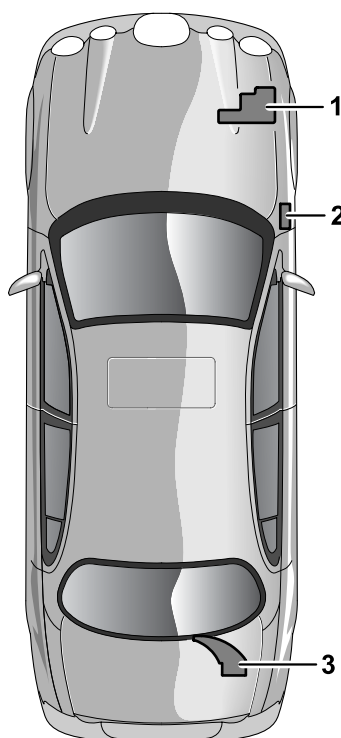

JOL3209

There are three separate fuse boxes fitted to the vehicle, each one containing fuses protecting a different group of circuits.

They are located in:

1. The engine compartment.
2. The passenger compartment.
3. The luggage compartment.

Caution: When a fuse box lid is removed, take care to protect the box from moisture, and refit the lid at the earliest opportunity.

Fuses

Engine compartment fuse box

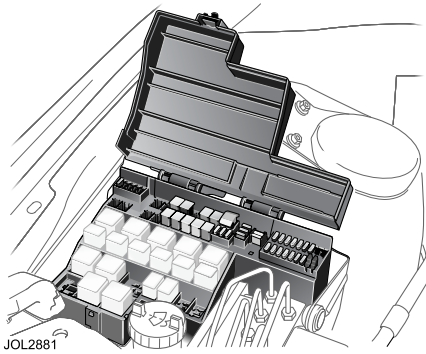

The fuse box is located in the engine compartment on the right-hand side adjacent to the windscreen wash reservoir.

Caution: When a fuse box lid is removed, take care to protect the box from moisture, and refit the lid at the earliest opportunity.

Remove the fuse box lid by pressing the retaining lugs and lifting.

When refitting, press the fuse box lid in the area of the retaining lugs until the lid engages.

Passenger compartment fuse box

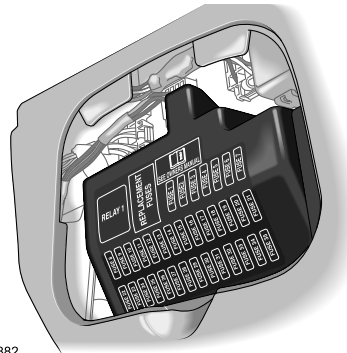

The passenger compartment fuse box is located on the right-hand side trim panel in the footwell.

Remove the fuse box lid by pressing the retaining lugs and lifting.

When removing and replacing mini-fuses, use the special tool provided in the engine compartment fuse box lid, together with spare fuses.

When refitting, press the fuse box lid in the area of the retaining lugs until the lid engages.

Fuses

Luggage compartment fuse box

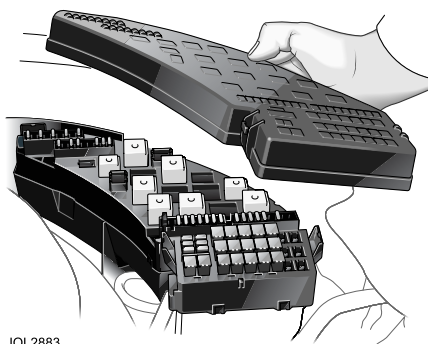

JOL2883

A fuse box is located in the luggage compartment, situated forward of the battery.

Fold the luggage compartment floor panel to gain access to the fuse box. Remove the fuse box lid by pulling the retaining clips and pulling the lid upwards.

When removing and replacing mini-fuses, use the special tool provided in the engine compartment fuse box lid, together with spare fuses.

Reposition the lid and press down until the retaining clips engage.

Refit the floor panel.

Fuse and Relay Positions

See illustration on following page:

- A. Engine compartment fuse box.
- B. Passenger compartment fuse box.
- C. Luggage compartment fuse box.
- D. Fuse removal tool.
- E. Spare fuses.

Fuses

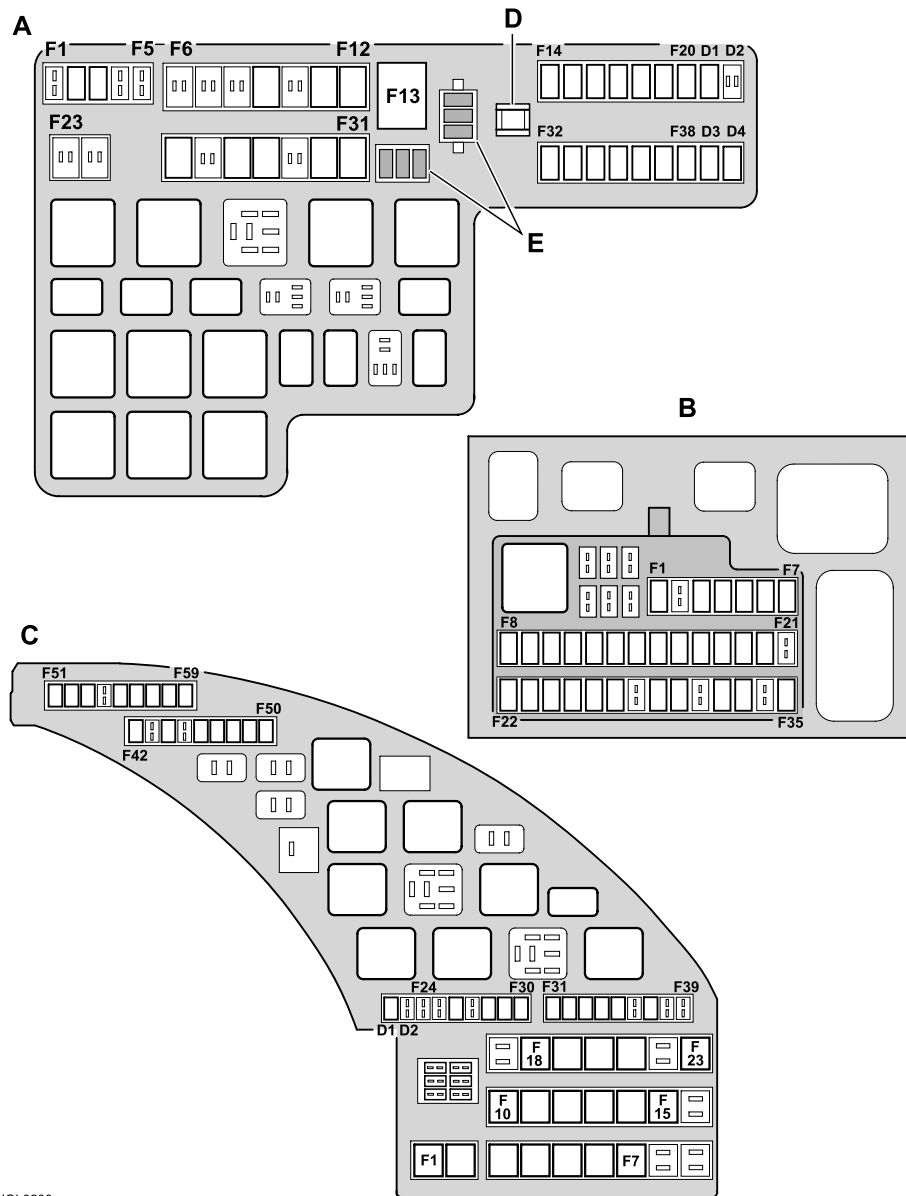

JOL3230

Fuses

Engine Compartment Fuse Box (A) - Fuses

Fuse No	Rating (amps)	Circuit
F1		Not used.
F2	5A	Engine management system engine control module (battery supply) (Diesel only).
F3	20A	Auxiliary fuel fired heater(Diesel only).
F4		Not used.
F5		Not used.
F6		Not used.
F7		Not used.
F8		Not used.
F9	50A	Petrol- Heated oxygen sensors, throttle, ignition, engine management system relays. Diesel - Engine management system relay
F10		Not used.
F11	40A	Headlight powerwash.
F12	20A	Wipers.
F13	80A	Cooling fan.
F14	15A	Right-hand dipped beam high intensity discharge (HID) light.
F15	15A	Front fog light.
F16	15A	Horns.
F17	15A	Fuel injectors (Petrol only).
F18	20A	Throttle motor (Petrol only).
F19	10A	Petrol - Ignition coil on plugs supply, capacitor, HEGO Relay coil. Diesel - pressure control valve, volume control valve
F20	30A	Right-hand oxygen sensor heaters(Petrol only); engine management system engine control unit (Diesel only).
F21/ D1	5A	Rain sense module.
F22/ D2		Not used.
F23		Not used.
F24		Not used.
F25	40A	Right-hand windscreen heater.
F26		Not used.
F27	30A	Starter motor solenoid.
F28	30A	ABS pump motor.

Fuses

Fuse No	Rating (amps)	Circuit
F29		Not used.
F30	40A	Left-hand windscreen heater.
F31	30A	ABS module (ABS valves).
F32	10A	Air compressor clutch, auxiliary coolant pump.
F33	15A	Engine control module and transmission control module battery supply.
F34	15A	Left-hand dipped beam high intensity discharge (HID) light.
F35	30A	Left-hand oxygen sensor heaters (Petrol only).
F36	15A	Intercooler pump (supercharged model).
F37	15A	Air flow meter, purge valve(Petrol only), inlet manifold tuning valves (V6 only), EGR valve (V8 only), air filter solenoid (V8 S/C only), MAF sensors, VGT, port deact valve (Diesel only), canister close valve.
F38	10A	Engine control module, ignition supply (Petrol only), glowplug module (Diesel only), cooling fan module, air conditioner clutch relay.
D3		Ignition relay(Petrol only).
D4		Engine management control relay (Petrol only).

Passenger Compartment Fuse Box (B) - Fuses

Fuse No	Rating (amps)	Circuit
F1	5A	Engine control module/crankshaft sensor.
F2		Not used.
F3	5A	ABS/Dynamic stability control module, ACC module.
F4	5A	Inertia switch (engine management system, fuel pump relay, ignition relay, rear electronics module), instrument cluster.
F5	10A	Restraint control module, airbag occupant sensor, passenger airbag de-activation light.
F6	10A	OBDII connector.
F7	5A	Driver's door module, battery backed sounder, road pricing (Singapore), security LED.
F8	5A	Front right turn indicator, sidemarker, park, repeater light.
F9	10A	Right-hand dipped beam, left-hand HID relay coil.
F10	5A	Front left turn indicator, sidemarker, park, repeater light.
F11	10A	Left-hand main beam.
F12	15A	Screenwash pump.
F13	5A	Instrument cluster.

Fuses

Fuse No	Rating (amps)	Circuit
F14	10A	Climate control system, two stage adaptive damping control module.
F15	5A	Ignition switch feed (RUN) to alternator, 'J'-gate, transmission control module.
F16	10A	Passenger/driver heated seat modules, electrochromic mirror, rain sense module, headlight levelling/HID, tyre pressure module.
F17	5A	Instrument cluster (airbag warning light, alternator warning light, seatbelt chime).
F18	20A	Radio head unit, touch-screen/display unit.
F19	15A	Steering column tilt and reach motors.
F20	10A	Logic supply to instrument cluster, climate control system, front electronic module, rear electronic module, electric parkbrake.
F21		Not used.
F22	10A	Driver's door module battery supply (driver's door mirror, locks).
F23	10A	Right-hand main beam.
F24	5A	Passive anti-theft system.
F25	10A	Left-hand dipped beam, right-hand HID relay coil.
F26	5A	Electric parkbrake switch illumination, AM/FM antenna amplifier, sunblind motor, cigar lighter and power point relay.
F27	10A	Radio head unit, touch-screen/display unit, navigation module, VICS (Japan), centre console switchpack, voice control, phone transceiver.
F28		Not used.
F29	5A	Reversing aid module, telephone transceiver, front electronic module, voice control.
F30	10A	Front electronic module power.
F31		Not used.
F32	10A	Accessory relay and socket.
F33	10A	Front electronic module (instrument dimming, fuel/luggage compartment switchpack.)
F34		Not used.
F35	5A	Brake on/off switch, bottom of clutch switch.

Fuses

Luggage Compartment Fuse Box (C) - Fuses

Fuse No	Rating (amps)	Circuit
F1	40A	Passenger compartment fusebox - battery supply.
F2	30A	Cigar lighter and power point relay.
F3	20A	Ignition switch.
F4	20A	Left-hand rear window raise/lower.
F5	20A	Driver's window raise/lower.
F6	20A	Front passenger's window raise/lower.
F7	20A	Right-hand rear window raise/lower.
F8		Not used.
F9		Not used.
F10	30A	Fan motor.
F11	30A	Passenger seat.
F12	30A	Switch system power 1 relay.
F13	30A	Switch system power 2 relay.
F14	30A	Switch system power 3 relay.
F15	30A	Driver's seat.
F16		Not used.
F17		Not used.
F18	30A	Driver's seat.
F19	30A	Passenger's seat.
F20	30A	Switch system power 4 relay.
F21	30A	Heated rear window.
F22		Not used.
F23	30A	Fuel pumps.
D1		Fuel pump relay (Petrol only).
D2		Not used.
F24	5A	Tyre pressure module.
F25	5A	CD player.
F26	15A	Adaptive damping.
F27		Not used.
F28	30A	Remote audio power amplifier.
F29	10A	Telephone, Navigation, VICS (Japan only).
F30	5A	Alternator sense (V8 S/C only and diesel).
F31	20A	Sunroof control module.
F32	10A	Driver's seat.
F33	5A	Transit relay.

Fuses

Fuse No	Rating (amps)	Circuit
F34	20A	Left/right-hand heater seat module.
F35	30A	Electric parkbrake.
F36		Not used.
F37	10A	Passenger seat.
F38		Not used.
F39		Not used.
F40		Not used.
F41		Not used.
F42	10A	Driver/passenger heated door mirrors.
F43		Not used.
F44	10A	Left-hand rear reverse light, direction indicator, side marker, trailer tow relay and module.
F45		Not used.
F46	10A	Luggage compartment lid and interior lights, fuel filler flap solenoid.
F47	15A	Rear electronic module, fuel pump driver (Petrol only), fuel pump lift (Diesel only).
F48	10A	Right-hand rear reverse light, direction indicator, side marker, number plate light.
F49	15A	Secondary fuel pump module (S/C only).
F50	5A	Transit relay.
F51	5A	ACC.
F52	5A	Electric parkbrake.
F53	10A	Right-hand rear stop, tail and fog lights, high mounted stop light.
F54		Not used.
F55	10A	Foorwell lights, roof courtesy lights, map lights, visor light, puddle light, glove compartment light, garage door opener.
F56	15A	Cigar lighter.
F57	10A	Left-hand rear stop, tail and fog lights.
F58	20A	Power point.
F59	15A	Rear electronic module, rear and passenger door locks, boot solenoid.

Fire Extinguisher

Dealer Fitted Fire Extinguisher

Many countries make it compulsory to carry a fire extinguisher. Your Jaguar Dealer can supply and fit one.

Factory Fitted Fire Extinguisher (Where fitted)

Some countries have a factory fitted fire extinguisher which contains 2 kg (4.4 lbs) of BC powder pressurised with nitrogen to a working pressure of 180 psi (12 bar) at 20°C (68°F).

This extinguisher can be used on liquid fires, electrical equipment fires and, if no explosion risk, gasoline fires.



WARNING:

- **Do not test the fire extinguisher prior to use. Partial discharge will render the extinguisher inoperative.**
- **Do not use the fire extinguisher closer than 2.4 m (8 feet) to the base of a liquid fire as the force may splatter the burning liquid to the surrounding area.**

Operating the fire extinguisher

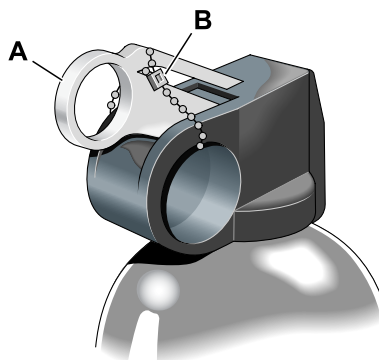

JOL3026

1. Unclip and remove the extinguisher from the bracket.
2. Put your finger through the yellow safety wedge ring (A) and pull hard to remove the wedge. The operating lever will be exposed.
3. Hold the extinguisher upright and aim at the base of the fire.
4. Press the lever down firmly.
5. Release the lever to stop the flow of powder.

Maintenance

Every six months:

- Remove the extinguisher from its bracket and check that the nozzle is clear.
- Check that the safety wedge strap (B) is secure.

Check the pressure gauge on the base of the extinguisher. If the gauge is in the red area report it to your Jaguar Dealer immediately as the extinguisher may not work in an emergency.

Maintenance

General Maintenance	193
Bonnet Release	194
Regular Checks	195
Checking and Top-up	199
Battery	205
Wiper Blades	209
Tyres	210
Vehicle Care	214
Electrical Accessories	217



