

AUDIO/VIDEO CONTROLS

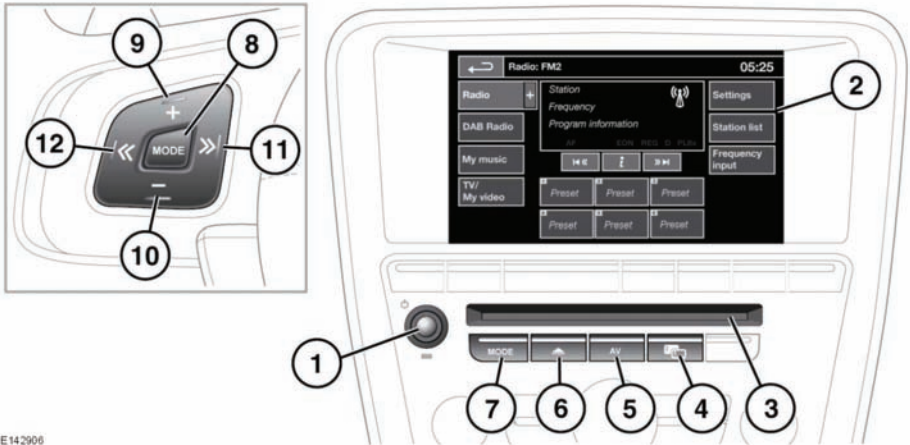

E142906



In the interest of safety, only operate, adjust or view the system when it is safe to do so.



Sustained exposure to high sound levels (greater than 85 decibels) can damage your hearing.

1. On/off and volume control:

- Press to switch the system on/off.
- Rotate to adjust volume level (displayed on the touch screen).

Note: The audio system operates with the ignition on or off but will switch off with the ignition and need to be switched on again.

2. Touch screen.

3. CD/DVD load and eject slot.

4. Press to select Dual view or Audio settings menu. See **115, DUAL VIEW CONTROLS** or **96, AUDIO SETTINGS**.

5. **AV**: Press to access audio/video menu.

6. **Eject**: Press to eject a CD/DVD.

7. **MODE**: Press repeatedly to scroll through all audio/video sources.

8. Steering wheel controls, **MODE**:

- Short press to scroll through all audio/video sources.
- Long press to scroll through audio/video source sub selections, e.g. In My music: iPod, Bluetooth®, stored CD and CD etc.

9. Press to increase volume.

10. Press to decrease volume.

11. Seek up:

- Short press to select the next radio preset, next preset TV channel, or next track on chosen audio source.
- Long press to seek to the next radio station or to select the next TV channel on the channel list.

12. Seek down:

- Short press to skip/move to the previous radio preset or previous preset TV channel, or previous track on list.
- Long press to seek to the previous radio station or to select the previous TV channel on the channel list.