

# Starting the engine



If the brake pedal is applied when the engine **START/STOP** button is pressed, the engine will start.

## ROLLING RE-START

A rolling restart can be initiated by selecting Neutral (**N**) and pressing the engine **START/STOP** button.

## KEYLESS START BACKUP

If the vehicle has been unlocked using the emergency key blade or the Smart Key is not detected by the vehicle, it will be necessary to use the keyless start backup to disarm the alarm and start the engine.

The keyless start backup can only be used when the message **Smart Key Not Found - Refer to Handbook** is displayed in the Message centre.

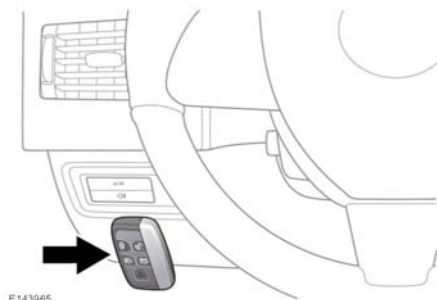

1. Position the Smart Key flat against the fascia below the auxiliary switch pack in the position shown
2. Firmly depress the brake pedal.
3. Press and release the engine **START/STOP** button.

Once the engine has started, the brake pedal can be released if it is safe to do so.

If the Smart Key is not recognised, or the engine still fails to start, consult a Jaguar Dealer/Authorised Repairer.

## IF THE ENGINE FAILS TO START

**Note:** If the engine fails to crank when the engine **START/STOP** button is pressed and there has been a recent collision, the fuel system inertia switch may have been tripped. Seek qualified assistance.

Make sure that the brake pedal is not depressed. Switch on the ignition and check the instrument panel for warning lights and the Message centre for warning messages. See

## 58, WARNING AND INFORMATION MESSAGES

Seek qualified assistance if necessary.

To reset the immobiliser and alarm system use the valid Smart Key to lock and unlock the vehicle.

**Note:** The following information applies to petrol engine vehicles only.

If the engine persistently fails to start.

1. Ensure the brake pedal is not depressed and that a valid Smart Key is inside the vehicle.
2. Ensure that Park (**P**) or Neutral (**N**) is selected.
3. Press and hold the engine **START/STOP** button until the warning lamps illuminate.
4. Slowly depress the accelerator pedal fully and hold it in the fully depressed position.
5. Press and release the engine **START/STOP** button. The engine will begin to crank.
6. Release the accelerator pedal when the engine starts.

If the engine still fails to start, or fails to crank, consult a Jaguar Dealer/Authorised Repairer.

## ENGINE BLOCK HEATERS



The fitting of an engine block heater does not eliminate the need for antifreeze.

Engines are more difficult to start when the ambient temperature is very low. In geographical areas where temperatures below 14°F (-10°C) are experienced frequently, it is advisable to fit an engine block heater. The block heater will have an insulated connector at the front of the vehicle which is connected to a mains supply using a suitable extension cable. The heater can remain in use overnight, if required. Typically, an engine block heater will use between 400W and 1000W per hour.

For further information, consult your Dealer/Authorized Repairer.