

## Occupant protection

### Seat belts

The use of front and rear seat belts is mandatory in most countries. Using seat belts saves lives. They should be worn by all occupants whenever the vehicle is in use, for maximum protection.

Lap/shoulder inertia reel seat belts are provided for both front occupants and three rear seat positions.

The inertia operating mechanism of the seat belts allows the wearers to move their upper bodies to reach various controls. The seat belts lock automatically with accelerated body movement or in the event of emergency braking.

The seat belt assemblies incorporate additional safety devices. All have belt pretensioners and the front belts also have force limiters. These devices provide increased protection in the event of a severe frontal impact.

The pretensioners operate in conjunction with the airbags as part of the Advanced Restraints Technology System (see page 3-3).

All passenger seat belt mechanisms incorporate an automatic locking device to allow child seats to be secured safely. See **Child safety** on page 3-12.

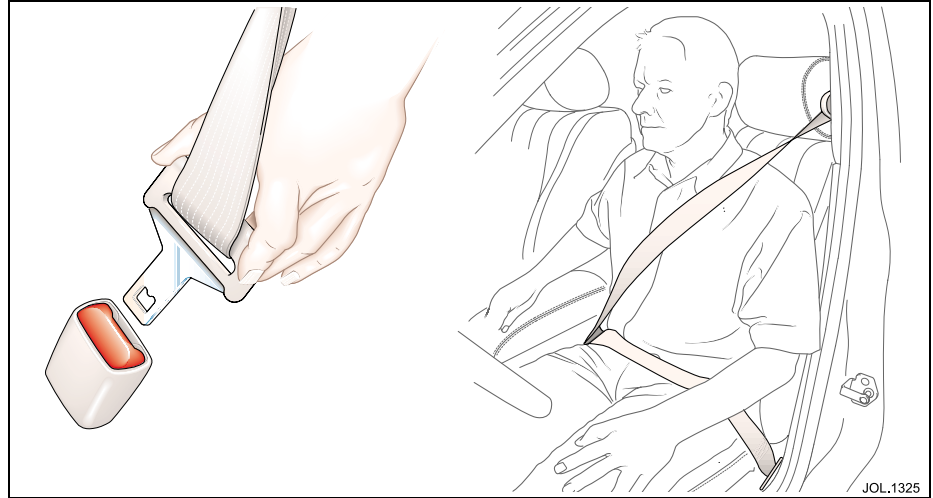

### Seat belt fitting



**WARNING:**

**Do not adjust the seat belt while driving.**

Draw the tongue of the seat belt over the shoulder, across the chest and push it into the buckle unit slot. A positive 'click' indicates that it is safely locked.

The use of comfort clips or devices that would create slackness in the seat belt system are not recommended.

Ensure that the webbing is midway between the neck and the edge of the shoulder. Correct tension is controlled by automatic retraction of the reel.

When the ignition is switched to position 'II', a chime sounds for six seconds and a warning light is illuminated on the instrument panel for 60 seconds if the driver's seat belt remains unfastened.

**Note:** If the vehicle is parked on unlevel ground, the seat belt mechanism may lock. This is not a fault, gently ease the belt from its attachment to unlock it.

## 3-2 Before driving

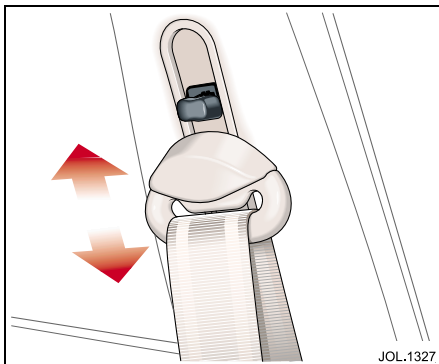

### Front belt height adjustment

To adjust the front seat belt heights, press the locking button and slide the anchorage so that the seat belt webbing passes over the shoulder without pulling against the neck. Release the button and check that the anchorage point is locked.

Always check the anchorage point after the seat has been adjusted to ensure that the belt is correctly positioned.

### Inertia reel mechanism check

**Static test:** Whilst seated, fasten the seat belt and grip the shoulder belt at approximately shoulder level with the opposite hand. Pull the belt sharply downwards, the belt should lock.

**Road test:** The following road test must be carried out only under maximum safe road conditions.

With the seat belt correctly fitted to the driver and passenger(s), drive the vehicle at 5 mph (8 km/h) and, ensuring that it is safe to do so, brake sharply.

The seat belt(s) should lock automatically, holding both driver and passenger(s) securely in position.

It is important when braking that the reactions of both driver and passenger(s) are normal, that is, the body must not be thrown forward in anticipation, thus causing a snatching action of the belt which would operate the locking mechanism.

If the belt fails to lock on either test, consult a Jaguar Dealer.



### WARNING:

1. **Seat belts are designed to bear upon the bony structure of the body. The lap section of the belt must be worn low across the front of the pelvis and NOT across the abdominal area. Always ensure that the webbing is midway between the neck and the edge of the shoulder.**
2. **Care should be taken to avoid contamination of the webbing with polishes, oils and chemicals, and particularly battery acid. Cleaning may safely be carried out using mild soap and water. If webbing becomes frayed, contaminated or damaged, discard it and fit a new seat belt.**
3. **It is essential to renew the entire assembly after it has been worn in a severe impact even if damage to the assembly is not obvious.**
4. **Belts should not be worn with the webbing twisted.**
5. **Each seat belt assembly must only be used by one occupant; it is dangerous to put a seat belt around a child being carried on the occupant's lap.**
6. **No modifications or additions should be made by the user which will prevent the seat belt adjusting devices from operating.**
7. **Should the seat belt not retract and remain at its static length, consult your nearest Jaguar Dealer immediately.**

## Airbags

In order to provide optimum protection this vehicle is equipped with front and side airbags. They are used in conjunction with the seat belts to help protect occupants from upper body (thorax) and head injuries.

- The driver front airbag is located in the centre of the steering wheel.
- The front passenger airbag is located in the fascia panel immediately in front of the passenger seat.
- Thorax side airbags are fitted within the outboard bolsters of both front seats, and are identified by labels.
- A curtain airbag is fitted on each side, above the front and rear doors.

An alert label on the front face of the driver's and passenger's sun visor directs you to read the warning label on the rear face of each sun visor.

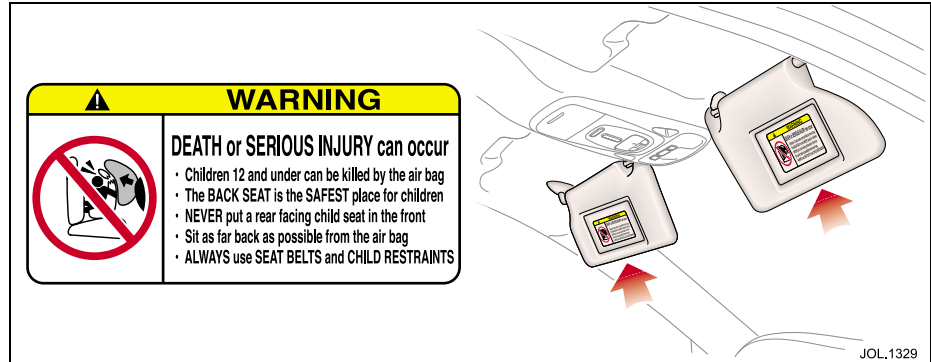

The warning label contains the following statement:



**WARNING:**

**DEATH or SERIOUS INJURY can occur.**

- **Children 12 and under can be killed by the airbag.**
- **The BACK SEAT is the SAFEST place for children.**
- **NEVER put a rear facing child seat in the front.**
- **Sit as far back as possible from the airbag.**
- **ALWAYS use SEAT BELTS and CHILD RESTRAINTS.**

## Advanced restraint technology system

The airbags and seat belt pretensioners are electrically controlled by an advanced restraints technology system.

Various sensors determine the direction and severity of an impact and the presence and position of front seat occupants. The system analyses this information then deploys the appropriate airbags only e.g. the side airbags where the impact is on that side only.

Airbags are not deployed in a rear impact.

## 3-4 Before driving

---

### Airbag deployment

To do their life-saving job, airbags must inflate rapidly and with considerable force. There is therefore a risk of death or serious injuries such as fractures, facial and eye injuries or internal injuries, particularly to occupants who are not properly restrained by seats belt or sitting correctly when the airbag deploys.

The risk of injury from a deploying airbag is greatest close to the trim covering the airbag.

The whole sequence of events from sensing the impact to full inflation of the bag takes place in a fraction of a second.

The noise and gas associated with the deployment of the airbags is not injurious to health.

After airbag deployment, it is normal to notice a smoke-like, powdery residue or smell the burnt propellant. This may consist of cornstarch, talcum powder or sodium compounds that result from the combustion process that inflates the airbag.

Small amounts of other chemicals may be present which may irritate the skin and eyes, but none of the residue is toxic.

While the system is designed to help reduce serious injuries, it may also cause minor burns, abrasions, swelling or temporary hearing loss.



#### **WARNING:**

- 1. No objects whatsoever should be attached to the centre cover of the steering wheel, the passenger fascia panel, the sides of the front seats or the interior trim immediately above the door openings. Do not put anything on or over the airbag inflation area. Placing objects on or over the airbag inflation area may cause those objects to be propelled by the airbag into your face and torso causing serious injury.**
- 2. Safety experts recommend a minimum distance of at least 10 inches (254 mm) between an occupant's chest and a front airbag.**
- 3. Children 12 years old and younger can be killed or seriously injured by the airbag. The rear seat is the safest place for children.**
- 4. Do not try to put an adult seat belt around two children.**
- 5. Several airbag system components get hot after inflation. Do not touch them after they have deployed.**
- 6. If an airbag is inflated, the airbag will not function again and must be renewed immediately. If a new airbag is not fitted, the unrepaired area will increase the risk of injury in a collision.**

## Airbag fault warning light

The airbag warning light in the driver's instrument cluster will be lit for approximately six seconds when the ignition is turned on.

If the light remains on or flashes, it indicates a fault within the airbag electrical circuits. Report the fault to a Jaguar Dealer immediately. It is safe to drive the vehicle; however, in an accident the airbags may not operate.

Airbag warning light information is shown in Section 4.

## Airbag disposal



### **WARNING:**

**Do not attempt to service, repair or modify the airbag system or its fuses. All work on the airbag system, including renewal after deployment and renewal at the end of its service life, must be carried out by an authorised Jaguar Dealer.**

In the event of the vehicle being dismantled, airbag module removal and disposal **MUST** be made by a qualified person. Instructions can be obtained from an authorised Jaguar Dealer.

## 3-6 Before driving

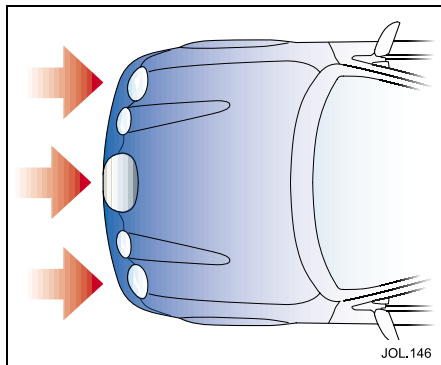

### Front protection

With a front impact of sufficient force, the restraints system will trigger the front airbag(s) and seat belt pretensioners, which immediately tighten the seat belts.

For front occupants, the seat belt then slackens with increasing chest load, allowing the head and chest to more gradually come into contact with the inflated airbag. The airbag absorbs the remaining energy of the impact and then deflates rapidly via vent holes.

Front airbags are designed to inflate in frontal and near frontal collisions, not low speed impacts, roll-over, side-impact or rear-impact.

Where the airbags are not deployed, protection is provided by the seat belts.

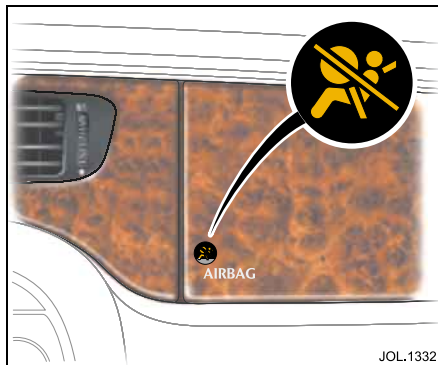

### Occupancy sensing

Both front airbags use a dual inflation technology which means that, if activated, the bag(s) will deploy at either a normal or reduced level of inflation, depending on crash severity. The lower inflation level is also selected if the restraint system senses that the driver is close to the steering wheel.

The front passenger seat is monitored by ultra-sonic sensors (see illustration opposite) and a seat weight sensor to determine the presence, weight and position of the front passenger. In certain conditions, e.g. where no passenger is present, the appropriate airbags will be de-activated. In a collision these airbags would not be deployed.

### Airbag de-activation warning light

The AIRBAG warning light on the passenger fascia is associated with the deployment conditions for front seat passenger airbags only.

- If the seat is empty, the front airbag will not be activated and the light will not be lit.
- If the seat is occupied by, for example, a small child, the front airbag will not be activated and the AIRBAG warning light will be illuminated.
- If the seat is occupied by a larger child or adult, the front airbag will be activated and the warning light will not be illuminated.
- If the passenger adopts a posture (e.g. leaning very far forward) which could cause injury from an inflating airbag, the front passenger airbag will not be activated and the AIRBAG warning light will be illuminated.

**Note:** Whenever the AIRBAG warning light on the passenger fascia is illuminated, the front passenger airbag will not be deployed in the event of an impact.

**Note:** The occupancy sensing system is designed to confirm that a front passenger is properly seated as recommended:

- Always sit centrally in the seat, remaining in contact with the seat back which for comfort should be rearwards of the vertical position.
- Adjust the seat to be as far back from the fascia as practical.
- Always wear seatbelts.

The seat adjustment controls are described on page 3-20.



**WARNING:**

**It is important that the passenger position sensors (see illustration) are not obscured in any way which could affect airbag deployment, e.g. fitting non-approved accessories.**

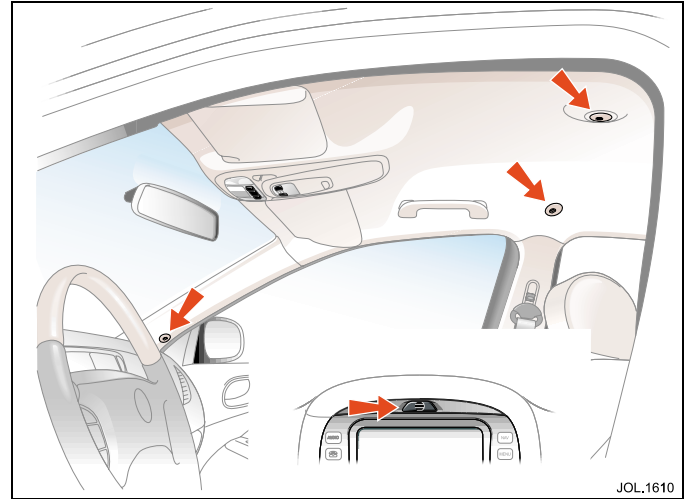

## 3-8 Before driving

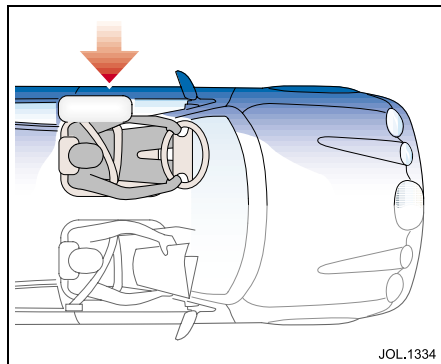

### Side protection

The side protection system utilizes four airbags: Two mounted in the front seats, and two curtain airbags located just above the front and rear door openings under the headlining trim.

When the seat mounted thorax airbag inflates upon a vehicle side impact, it breaks through the seat bolster stitching, protecting the side of the rib cage of the driver or front seat passenger.

When the curtain airbag inflates upon a vehicle side impact, it breaks through the headlining and deploys downwards, giving head protection to the front and rear seat occupants on the impact side.

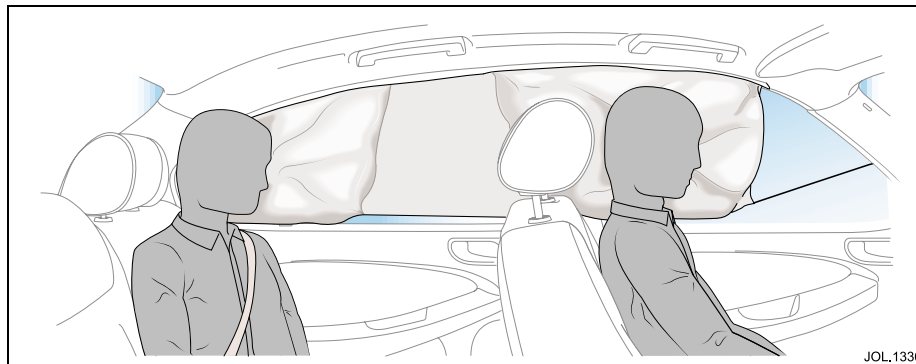

The curtain airbag on the front passenger side is always deployed in a side impact even if the front passenger seat airbags are de-activated. This is to maintain protection for a rear occupant.

Seat mounted thorax and curtain airbags are designed to inflate in a side impact collision, not rollover, rear-impact, frontal or near-frontal collisions, unless the collision causes sufficient lateral deceleration.

The airbags, in combination with the seat belts, can help reduce the risk of severe injuries in the event of a significant side impact collision.



### **WARNING:**

**To ensure that the side airbags are fully effective:**

**DO NOT sit too close to, or lean against the door trim. The side airbag could injure you as it deploys from the side of the seat.**

**DO NOT lean out of the window aperture.**

**Only use JAGUAR APPROVED accessories (e.g. seat covers).**

**Due to the function of the CURTAIN AIRBAG deployment, CONSULT your Jaguar Dealer prior to installing any ACCESSORIES in the upper environment/pillar trim area (e.g. HANDS-FREE TELEPHONE KITS).**



## Rear impact protection

Both front seats have active, energy absorbent backrests which, with correctly positioned headrests, reduce the risk of neck and spinal injury ('whiplash') in the event of a rear impact.

When activated, the seat backrests automatically move back and recline, altering the occupants' posture and reducing relative motion between the body and head.

The degree of backrest movement in a rear collision depends on the angle, speed and nature of the colliding vehicle.

After activation, the whiplash protection mechanism will not work again and the seat must be serviced by a Jaguar Dealer to restore the protective function.

**Note:** The amount of backrest movement depends on the severity of the impact and for a minor collision there may be no apparent change to the seat even where the protective system has been activated. After any rear collision, therefore, the seat must always be inspected by an authorised dealer.

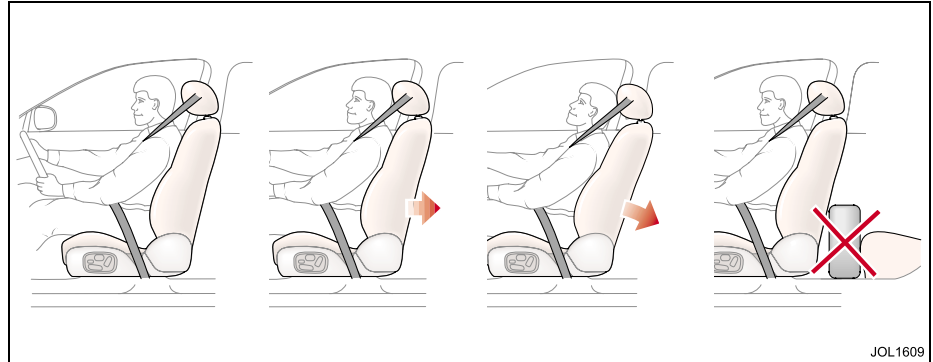

### WARNING:

1. For optimum protection, the driver and passenger should sit in the centre of the seat with the head as close as possible to the head restraint.
2. Do not wedge objects (e.g. luggage) between the front seat backrest and the rear seat cushion.
3. After a rear collision, the front seats must be inspected by a Jaguar Dealer even where there is no apparent damage or change to the seat.
4. Do not attempt to service or tamper with the seat recliner mechanism.

# 3-10 Before driving

**Wrong**  
Unbelted and too close

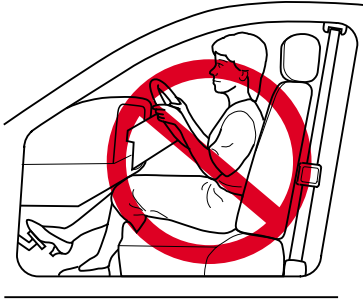

**Use seat belts**

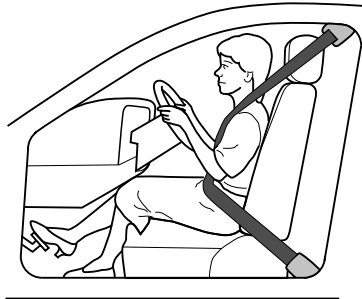

**If adjustable pedals fitted, move pedals towards seat**

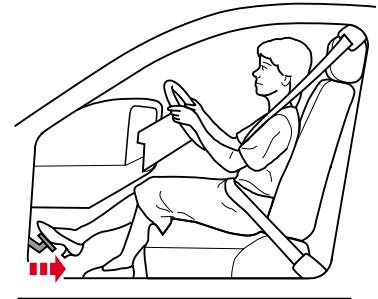

**Move seat rearwards and recline seat back**

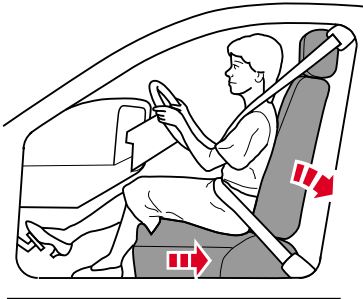

**Tilt wheel down/forwards**

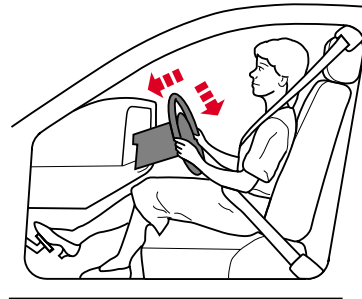

**Correct**  
\*Belted and 10 inches (254 mm) or more away



## Driving position



### **WARNING:**

**Driver and front seat passenger should always move their seats as far rearwards as is practical.**

Ideally, drivers should sit with at least 10 inches (254 mm) between the centre of their breastbone and the cover of the steering wheel airbag.

Since the risk zone at the time of deployment is the first 2 to 3 inches (54 mm – 75 mm) from the airbag cover, sitting back 10 inches (254 mm) provides a clear margin of safety. Very few drivers are unable to achieve and maintain that safety gap.

The vast majority of drivers who do not now sit that far back can change their position and achieve that distance.

- If adjustable pedals are fitted, move them towards the seat.
- Move your seat back as far as you can while still comfortably reaching the pedals.
- Recline the back of your seat one or two notches from the upright position. If reclining the back of your seat makes it hard to see the road, raise the seat.
- Tilt the steering wheel/column downwards so as to point the airbag at your chest instead of your head and neck. Adjust the steering wheel/column fore/aft so that it extends towards the driver as little as possible, ensuring that the airbag has plenty of room to deploy.
- Sit in the centre of the seat with the head as close to the head restraint as possible.

**Note:** Seat, steering wheel and pedal adjustment controls are described elsewhere in this section.

## 3-12 Before driving



### Child safety

JAGUAR CARS LTD. STRONGLY RECOMMEND THAT AT ALL TIMES CHILDREN SHOULD BE CARRIED IN THE REAR SEATS.



#### **WARNING:**

**Children must be restrained by a child safety restraint that is suitable for their weight and size.**

In many countries legislation governs how and where children should be carried when travelling in a vehicle. It is the responsibility of the driver to comply with all regulations in force in the country where the vehicle is being used.



#### **WARNING:**

**DO NOT install a rearward-facing child seat in the front passenger seat position since deployment of the passenger fascia airbag could cause death or serious injury to the child.**

**This is emphasised by the label displayed on the end of the fascia on the front passenger side (see above). If however, you have no alternative but to place a child in the front passenger seat, use only a forward facing child seat with the passenger seat set fully rearward and in its lowest position. Always follow the fitting instructions supplied with the appropriate child restraint system.**

Holding a baby or child in a person's arms is **not** a substitute for a child restraint system. Do not use a seat belt to restrain more than one person.

In an accident, a baby or child held in a person's arms can be crushed between the vehicle's interior and a restrained person.

The child can also be injured by hitting the interior or by being thrown from the vehicle during a sudden manoeuvre or impact.

Injury can also be caused if the baby or child is allowed to ride on the seat unrestrained. Other occupants should also be properly restrained to help reduce the chance of injuring the child.

Do not allow children to stand in the space between the seats, or on the passenger seats.



### **WARNING:**

- 1. Do not try to put an adult seat belt around two children.**
- 2. Choose a child seat that sits securely on the seat cushion and against the seat back.**

### **Choosing a suitable child seat**

Before you buy a child seat, it is important to note that your child's weight, rather than age, determines the type of seat that is required.

**Jaguar recommends that a rear-facing seat with a harness is used for as long as your infant's development allows.** Do not use a forward-facing seat until your child is able to sit up unaided. Up to the age of 2, a child's spine and neck are not sufficiently developed to avoid injury in a frontal impact.

**Always use the top tether to secure a forward facing child seat where possible (refer to page 3-18).**

When choosing a child seat, it is also important to consider how you plan to use it. For longer journeys, a reclining seat may offer added comfort and support for a sleeping child, while a lightweight design may be easier to lift in and out of the vehicle. It is also worth noting that some children are more suited to a harness-style seat than a booster seat during their toddler years.

Because child seats vary in shape, certain designs may be more stable when mounted on the outer rear seating positions, rather than in the centre. Always check that the child seat can be mounted securely in the required position: if in doubt, speak to your Jaguar Dealer.

We strongly advise that you do not buy or use a second-hand child seat. The seat may have been used inappropriately, or involved in an accident. In such circumstances, the seat may not protect your child.

### **LATCH seats**

LATCH (Lower Anchors and Tethers for CHildren) child seats have two rigid or webbing mounted attachments that can connect to two anchors provided at specific seating positions in your vehicle. This eliminates the need to use seat belts to secure this type of child seat. For forward facing child seats, the top tether strap must also be attached to the anchor point located on the parcel shelf.

The vehicle has LATCH anchors to install a child seat in either of the rear outboard seating positions. Refer to page 3-16 for more details.

## 3-14 Before driving

---

### Securing child restraints with an adult seat belt

All passenger seat belts (not the driver's) have an automatic locking device for use with child seats.

If engaged, this device allows the belt to be retracted (tightened) but not pulled out. When used to secure a child seat, therefore, the belt will automatically lock at any point to which it has retracted.

Always ensure that child restraint assemblies are fitted in strict accordance with the child restraint manufacturer's instructions. Keep the fitting instructions for future reference.

The following checks should always be carried out:

- Fit the child seat in the correct position and secure with the seat belt in accordance with the manufacturer's instructions. If necessary, remove the headrest to accommodate a larger child seat.
- Pull the seat belt all the way out to engage the locking device.
- To fix the seat firmly, retract the belt back onto the reel; a ratchet operation will be felt as the belt retracts. Continue to pay the belt back onto the reel until it fits snugly around the child seat.

- Make sure the child seat is fitted firmly to the car seat. There should not be excessive forward or sideways movement.
- Regularly check and refit the child seat, to ensure there is no slack in the installation.
- The seat belt must not be twisted and the buckle must not rest on the child seat frame, as it may snap open in an accident.
- Never modify the seat, or install it differently to the instructions.

The above is a guide only. Depending on the features of a particular child seat, e.g. forward or rearward facing, engage the locking device before or after attaching the belt, as convenient.

Unbuckling the belt and releasing the child seat will allow the belt to resume its normal operation.

Always secure an unoccupied child seat safely. In an accident, an unsecured child seat may pose a risk to the vehicle's occupants.

### Safe use of child restraints

Ensure there is no slack in the webbing and the restraint fits the child snugly across the rib cage and hips. These are the parts of the body most able to take the force of an impact.

- Ensure the path and position of an integral harness across the shoulders is appropriate for your child's development – consult the manufacturer's instructions.
- The lap strap should pass across the top of the child's thighs, bearing on the pelvis, not the abdominal area.
- Adjust the harness every time, so that one or two fingers only can be inserted between the child and harness. Different clothing on a child can make a difference to the correct fitting of the harness.
- Make sure the harness webbing is not twisted.
- Never modify the seat harness or buckles, as this may affect the quick release mechanism.
- Always secure your child correctly, even for the shortest journey.
- Follow the seat manufacturer's instructions for harness adjustments.

### Booster seats

If a booster seat is used, position the lap section of the adult seat belt over the child's pelvis. The diagonal seat belt should rest on the child's shoulder, not the neck.



#### **WARNING:**

**The top tether must always be used to secure forward-facing child seats. Refer to page 3-18.**

### Check list – non-LATCH child restraints

Follow the check list each time your child travels in the vehicle:

- **Always attach the top tether when installing a forward-facing seat.**
- Carefully follow the instructions provided by the manufacturer of the restraint system.
- Always use the appropriate child restraints and adjust harnesses for every child, every trip.
- Avoid dressing your child in bulky clothing and do not place any objects between the child and the restraint system.
- Regularly check the fit of your child seat and replace seats or harnesses that show signs of wear.
- Ensure that you have removed all slack from the adult seat belt.
- No child seat is completely child-proof. Encourage your child not to play with the buckle or harness.
- Never leave a child unsupervised in the vehicle.
- Activate the rear door child safety locks (refer to Section 2).
- Ensure your child does not exit the vehicle from the side where there is traffic.
- Set your child a good example – always wear your seat belt.

## 3-16 Before driving

### LATCH child restraint system

The LATCH system allows LATCH-compatible child seats to be secured directly and easily to the vehicle body without the use of adult seat belts.

Many injuries to children in accidents are caused by the incorrect fitting and tensioning of the adult seat belts, which are normally used to secure child seats. The LATCH system reduces the likelihood of incorrect fitting and is also quicker and simpler to use.

The LATCH system uses two anchorage loops and a top tether bracket fixed to the vehicle body. The LATCH child seats lock onto the anchorage loops using either two straps with clips, or two extendable legs. The child seats are also fitted with a strap that clips onto the top tether bracket.

The anchorage loops are accessible through two trimmed apertures at the back of the rear seat cushion. Pull back the Velcro fastened flap to uncover the apertures.

**Note:** To ensure a LATCH child seat is installed safely, read all the information provided on pages 3-16 to 3-19.

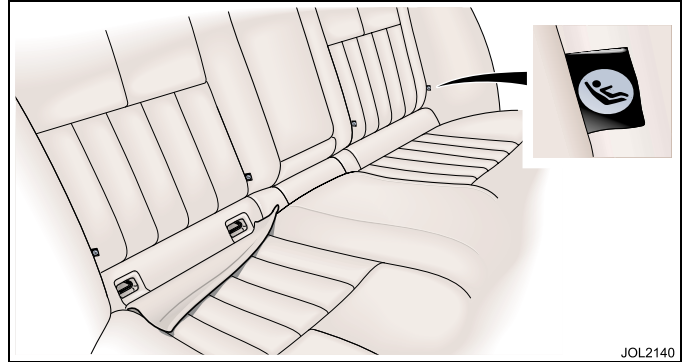



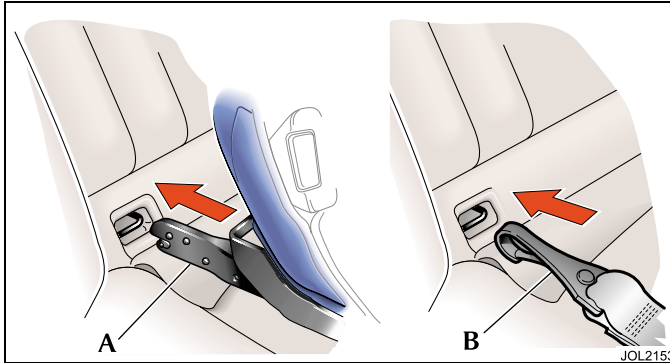

## Installing a LATCH seat

Consult your Jaguar Dealer to obtain a LATCH compatible seat.

**Caution:** When fitting a LATCH child seat, the seat manufacturer's instructions must always be followed. The following is a guide only.

LATCH seats can only be installed in the rear outboard seating positions. If necessary, remove the headrest.

**LATCH seat with anchorage legs (A)** – Fit the seat as follows:

1. Make sure the adult seat belts and buckles do not become trapped behind the child seat.
2. Make sure there is nothing obstructing the seat mounting mechanism at the anchorage points.
3. Make sure you do NOT trap the top tether strap behind the child seat.

4. Fully extend the two anchorage legs on the child seat (see manufacturer's instructions).
5. Locate the slots on the ends of the legs onto the two LATCH loops, then push the seat assembly rearwards until the legs are positively engaged (a trigger operates to lock the anchorage legs onto the loops).
6. Slide the seat rearwards along the legs until it is locked firmly against the vehicle seat back. Confirm that it is securely locked in position.
7. As a final check, firmly pull both sides of the seat to confirm that it is correctly fixed in position.

**LATCH seat with tether straps (B)** – Clip the flexible lower straps to the two LATCH loops. Adjust the length of each strap until the seat is held firmly against the vehicle seat back.



**WARNING:**

**The top tether must always be used to secure forward-facing child seats.**

## 3-18 Before driving

### Child restraint top tether anchorages and brackets

The top of the child seat is connected by a short strap to the top tether bracket to prevent the seat from rotating about the lower anchorages. The top tether brackets are positioned on the rear parcel shelf, under access covers, at the centre-line of each rear seating position.

Pass the top tether strap under the vehicle rear head restraint to connect to the top tether bracket on the parcel shelf. Adjust the length of the top tether strap to hold the top of the child seat against the vehicle seat back.

Make sure the child seat is securely fitted, and follow the check list on page 3-19.



#### **WARNING:**

- 1. Do not install a LATCH child seat with flexible lower attachments in the vehicle centre seat position. The anchorage loops are only provided to install a compatible child seat in the vehicle outboard seat positions.**
- 2. Child restraint anchorages are designed to withstand only those loads imposed by correctly fitted child seats. Under no circumstances are they to be used for adult seat belts or for attaching other items or equipment to the vehicle.**

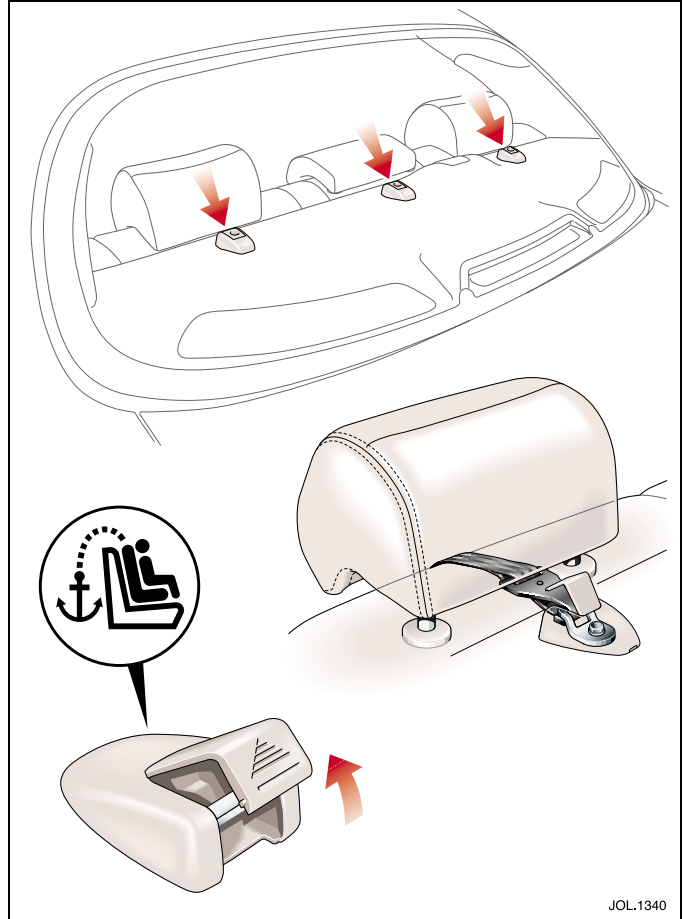

### Check list – LATCH child restraints

Follow the check list each time your child travels in the vehicle:

- **Always attach the top tether when installing a forward-facing seat.**
- Carefully follow the instructions supplied with the child seat.
- Always give the seat a final pull to ensure the lower anchors are secure, even if the seat has indicators to show that the seat connectors are latched.
- Always use the appropriate child restraints and adjust harnesses for every child, every trip.
- Make sure you use a seat with the correct weight range for your child.
- Avoid dressing your child in bulky clothing and do not place any objects between the child and the restraint system.
- Regularly check the fit of your child seat and replace seats or harnesses that show signs of wear.
- No child seat is completely child-proof. Encourage your child not to play with the buckle or harness.
- Never leave a child unsupervised in the vehicle.
- Activate the rear door child safety locks (refer to Section 2).
- Ensure your child does not exit the vehicle from the side where there is traffic.
- Set your child a good example – always wear your seat belt.

### Clock

The position of the digital clock depends on the equipment fitted to the vehicle.

If a touch-screen is fitted to the vehicle, the clock will be incorporated in the touch-screen display. Refer to Section 1 of this handbook for instructions on how to adjust the time.

If the vehicle is not equipped with a touch-screen, the clock is included in the audio display. Refer to the Audio System Handbook for instructions on how to adjust the time.

With either type of clock, the time can also be displayed by the message centre (refer to Section 4 of this handbook). The clock displayed within the message centre cannot be adjusted separately: it always shows the same time as the main clock.

## 3-20 Before driving

### Seat adjustment



#### WARNING:

1. Do not make adjustments when the vehicle is moving.
2. Front passengers must not ride with the seat fully reclined.

#### Front seat adjustment

The front seats are adjusted electrically by switches on the side of the seat cushion. Adjustment can be made with or without the ignition key inserted.

The number of seat adjustments varies with the vehicle specification but all options are given here. If a seat movement is not specified for your vehicle, the control switch will either not be fitted or will not include that seat function (switch movement will be inhibited).

Seat adjustments for two people may be stored and recalled by the driver position memory system. See **Memory setting** on page 3-28.

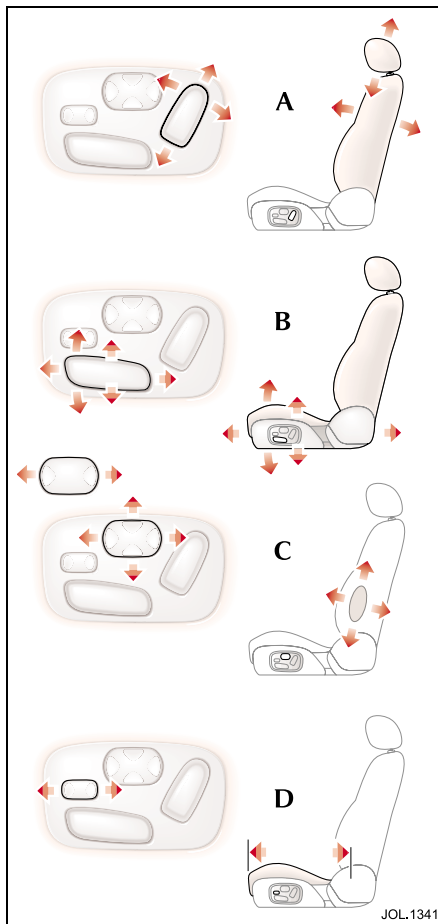

The full range of seat adjustments are:

**A** – Backrest angle (recline) and, if specified, headrest height.

**B** – Seat fore and aft position and, if specified, cushion height and front tilt:

- Move the switch forward or rearward to change the seat fore and aft position.
- Move the centre or rear of the switch up or down to adjust cushion height.
- Move the front of the switch up or down to tilt the front of the cushion.

**C** – If specified, provides adjustable lumbar support in the lower backrest. Either of two options may be fitted:

- **2-way or 4-way switch:** Press the front or back of the switch to increase/decrease lumbar support.
- **4-way switch only:** Press the top or bottom of the switch to adjust lumbar support upwards or downwards.

**D** – If specified, varies the cushion length. Moving the control will change the distance between the front of the cushion and the backrest.

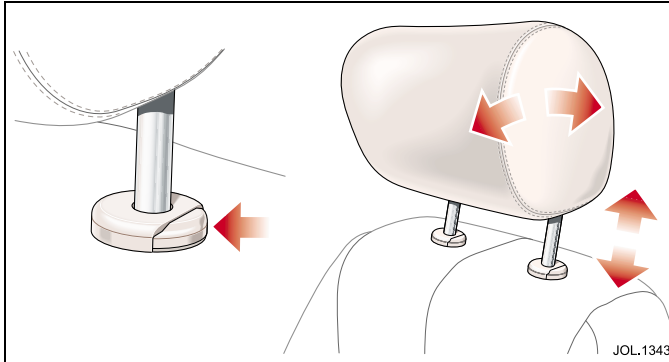

## Manual head restraint adjustment



### **WARNING:**

**Adjust the head restraint so that it is just behind your head and never behind your neck.**

Where electrically adjusted headrests are not fitted (see **Seat adjustment** on page 3-20), the front head restraints are manually adjustable:

- **To lower:** Press the button in the escutcheon and push the headrest into the seat back to the required height.
- **To raise:** Pull the headrest upwards.
- Swivel the head restraint forwards or backwards until it is comfortably positioned behind your head.

**Rear head restraints** – All rear head restraints are adjustable for height only.

**Note:** All headrests may be removed e.g. to fit a large child seat. Hold the escutcheon button down and pull out the headrest.

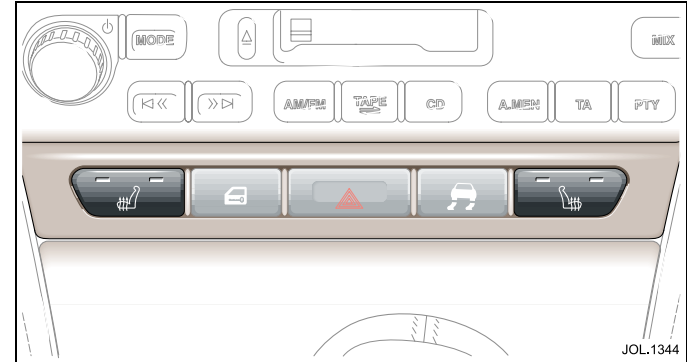

## Front seat heaters

The optional heated front seats incorporate heaters in the backrests and cushions and have two heat settings. Each seat has a heater switch on the centre console. With the ignition switch in position 'II', press a switch to select the heat setting:

- A first press selects the higher temperature setting, indicated by two red lights on the switch.
- A second press selects the lower temperature setting, indicated by one red light.
- A third press turns the seat heater off; both indicator lights off.

The heater will automatically switch OFF after 10 minutes or if the ignition is turned OFF or a fault is detected.

The heater will maintain a pre-set temperature while it is switched on. Storage of the vehicle in a heated garage, body heat or warm ambient temperatures may prevent operation of the seat heater.

## 3-22 Before driving

### Steering column adjustment



#### **WARNING:**

**Do not adjust the steering column whilst driving.**

The steering column can be adjusted for tilt and reach by operating the rotary/joystick control switch (A) on the left side of the steering column.

1. Turn the switch to the 'COLUMN' or 'AUTO' position.
2. Move the switch forwards or backwards to adjust reach.
3. Move the switch up or down to adjust tilt.

Two column positions may be stored and recalled by the driver position memory system. See **Memory setting** on page 3-28.

#### **Entry/exit mode**

Entry/exit mode provides automatic movement of the steering column and driver's seat to allow easier entry to or exit from the vehicle.

Entry/exit mode is selected by setting the steering column adjustment switch to the 'AUTO' position (B).

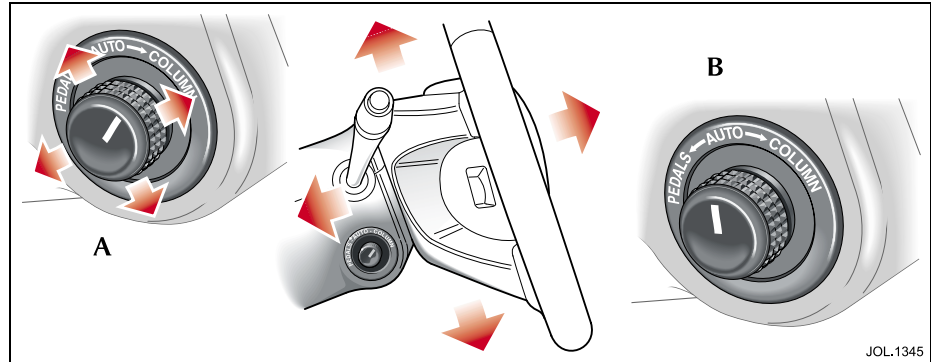

**Exit** – If the ignition key is in position '0' and the driver's door is opened or if the ignition key is removed, the steering column will move to the uppermost tilt position and the seat will move slightly rearwards.

**Entry** – When the key is next inserted in the ignition switch and the door is closed, the steering column and seat will return to their previous positions. If, however, the memorised driver position has been changed (using the door MEMORY switch or another key transmitter), the steering wheel and seat will move to the new position.

**Caution:** Do not use steering wheel mounted security devices since movement of the steering wheel in entry/exit mode could result in damage to the vehicle (e.g. the windscreen) or possible injury to the occupant.

#### **Notes on entry/exit mode operation**

1. If the adjustment switch is moved away from 'AUTO' whilst the steering column is tilted away, the steering column will move back to its memorised position when the key is next inserted in the ignition and entry/exit mode is then cancelled.
2. If the adjustment switch is moved during entry/exit operation, steering column movement will stop.

## Pedal Adjustment



### WARNING:

**Do not adjust the pedals whilst driving.**

This optional facility enables the pedals to be moved towards or away from the driver's seat, providing extra adjustment for the driving position. All pedals move together (no individual pedal adjustment) and are electrically controlled from the combined steering column/pedal adjust switch on the left side of the steering column housing. The adjustment can be made with or without the ignition key inserted.

To adjust the position of the pedals, turn the switch to 'PEDALS', then push it forwards or rearwards to cause a corresponding movement of the pedal assembly.

Two pedal positions may be stored and recalled by the driver position memory system. See **Memory setting** on page 3-28.

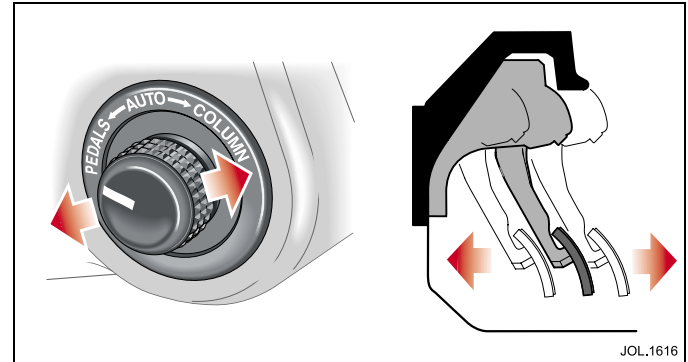

## 3-24 Before driving

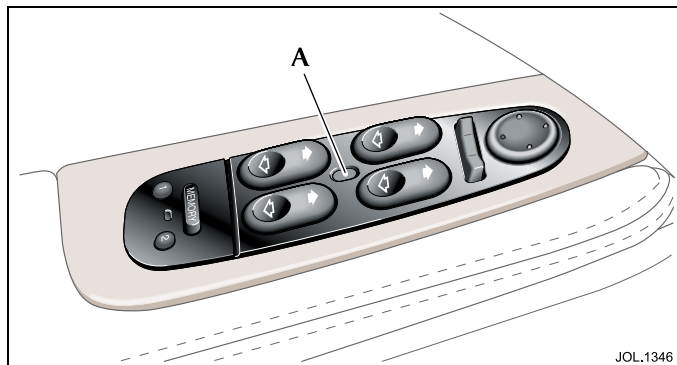

### Window operation

The front and rear door windows are electrically operated.

Switches on the driver's door control all door windows.

Passengers are provided with a switch to control their door window only.

These switches will only operate the windows when the ignition switch is in position 'I' or 'II'.



#### **WARNING:**

- 1. When raising windows ensure all occupants are clear.**
- 2. When leaving the vehicle take the ignition keys to prevent misuse of the window switches by remaining occupants, especially children.**

### Raise/lower

To lower a window, press and hold the rear of the switch until the desired position is reached, then release.

To raise a window, press and hold the front of the switch until the desired position is reached, then release.

If the switches are held for longer than 6 seconds, for example, when attempting to overcome frozen or jammed windows, the window drive will be switched off for a few seconds to protect the window drive motors.

### One-touch operation

Each window has a 'one-touch' facility enabling the occupant to fully open or close the window in one quick movement.

Press the switch briefly to close or open the window in one movement. Window travel can be stopped at any time by pressing the switch again.

### Immobilising the rear windows

The rear windows can be immobilised from the driver's door controls to prevent passengers from operating their windows.

To immobilise the rear windows, press button (A) down to the latched position i.e. flush with the bezel.

To enable rear window operation, press button (A) again so that it is in the raised position with the white band showing.



## Window anti-trap protection

Each electrically operated window has an anti-trap protection feature. If the upward movement of the window detects an obstacle the anti-trap system will immediately stop the window closing, then move it downwards for a short distance.



### **WARNING:**

**If the battery is disconnected or discharged the window anti-trap feature is lost. When the battery is reconnected or recharged the window anti-trap system must be reset.**

### **To reset the electrically operated windows anti-trap system**

- Fully close the window, hold the switch in the close position for two seconds and then release the switch. Wait for two seconds, do not open the window.
- Again, select the same window to close, holding the switch for a further two seconds.
- Check to confirm the operation by opening the window and then use one touch operation to close the window.
- Repeat for the remaining electrically operated windows.

### **To override the anti-trap protection**

The anti-trap system will also stop the window closing if a blockage or resistance occurs e.g. in the window guide channels. Typically this might be due to icing in winter but could also be caused by damage or misalignment of the guide channels or seals.

To override the anti-trap action:

- After the initial attempt to close the window, operate the close switch a second time.
- When the window has reversed from the blockage, operate the switch (within 10 seconds) until the window stops again (it will not reverse on the third attempt).
- Immediately operate the close switch again. The window will now move up a short distance with increased force to override the blockage.
- Repeat the override action until the window has closed. Each time the window stops, the switch must be operated immediately to initiate further override action.

If this procedure fails to move the blockage, the anti-trap feature will be lost and must be reset (see first column) after the blockage has been cleared.

### **Thermal overload**

If the windows are repeatedly opened and closed (e.g. by a child), a protection system will de-activate window operation for a short period to avoid overheating of the window motors.

## 3-26 Before driving

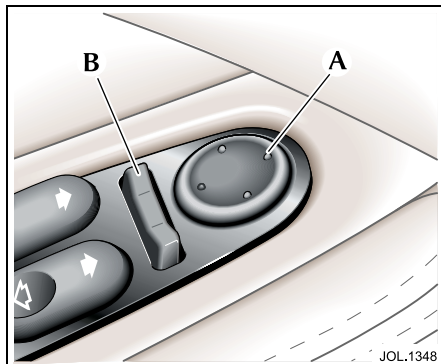

### Mirrors

#### Door rear view mirrors

Both door mirrors are adjusted from the driver's door switchpack.

The four-way adjustment button (A) moves the mirrors to the required position. The selector switch (B) selects the mirror to be moved, left for the left-hand side mirror and right for the right-hand side mirror. When the selector switch is in the centre position, adjustment to either mirror is inhibited.

The mirror housings are designed to pivot against the vehicle upon impact.

To return the mirror to its normal position, manually reposition the housing until it locks into place.

#### Door mirrors – power foldback

To assist parking by reducing the overall vehicle width, an optional facility enables the door mirrors to be folded back.

Set mirror selector switch (B) to the centre position.

To fold the mirrors inwards, briefly press the rear of button (A). Press the rear of button (A) again to return the mirrors to their normal driving position.

- Do not attempt to reposition power fold mirrors manually. Always use the button.
- If a door mirror is knocked out of position the mirror head will be loose. To re-engage the mechanism, power the mirror to the foldback position, then outwards to the drive position.

**Caution:** If door mirrors have been folded against the vehicle due to an impact:

- **Reposition power foldback mirrors using the door switches.**
- **Reposition non-power foldback mirrors manually.**

#### Mirror heating

The door mirrors have heating elements which work when the rear screen heater is switched ON. The mirror heater will clear all ice from the mirror surface.

**Caution:** Do not use a scraper to remove ice from the mirrors as this will damage the surface.

#### Electrochromic door mirrors

Electrochromic door mirrors are only fitted together with an electrochromic rear view interior mirror. The switches on the interior mirror control the electrochromic function for both door and interior mirrors (see following section).

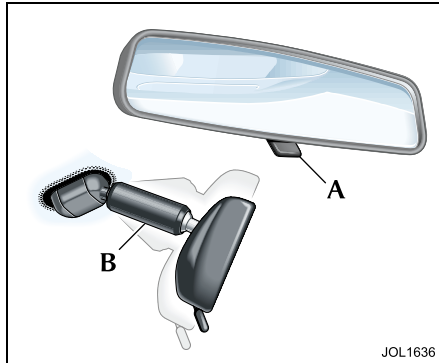

## Interior rear view mirror

Interior mirrors are either the manual dip or electrochromic type.

### Manual dip mirror

The interior rear view mirror can be dipped to prevent glare from a following vehicle's headlamps by pulling lever (A). Pushing the lever returns the mirror to its daytime setting.

**Adjusting the mirror** – The mirror is mounted on an adjustable arm (B) which can be angled to change the mirror height and lateral position.

Hold the arm and move to the desired position and then readjust the mirror itself.



## Interior rear view mirror – electrochromic

The interior rear view mirror is of the electrochromic type, and is operated by two buttons at the base of the mirror.

When switched on, the mirror darkens automatically to prevent glare from a following vehicle's headlamps, and clears when light levels return to normal or when reverse gear is selected.

Where electrochromic door mirrors are fitted, they are operated in conjunction with the interior mirror by the same buttons and function in the same manner.

**To operate:** To switch on, press the AUTO button. An LED will illuminate to indicate that electrochromic operation is selected. Press the OFF button to switch off electrochromic operation.

### Note:

1. Should a mirror assembly become detached from the windscreen, it must be refitted by a Jaguar Dealer.
2. Ensure that the windscreen in front of the mirror is kept clean. Where fitted, the moisture sensor for wiper operation is located to the front of the mirror casing. Any dirt may affect the operation of this sensor.

## 3-28 Before driving

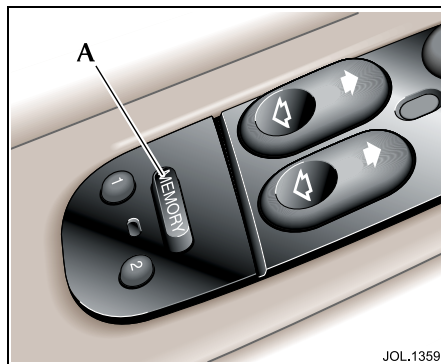

### Memory setting

This optional facility enables the position of the driver's seat, steering column, pedals and exterior rear view mirrors to be memorised and recalled. Two different driving position profiles can be entered in the memory.

A key does not have to be in the ignition switch for seat, mirror, steering column or pedals adjustments, nor for memory setting.

### Setting a driving position

To store a driving position in the memory:

1. Adjust the seat, steering column, pedals and exterior rear view mirrors to the desired positions.
2. Push the MEMORY button (A) and the red LED in the switchpack will illuminate for a five second period.
3. While the red LED is illuminated, push button '1', or '2' to memorise the configuration. The LED will go out and a chime will indicate that the setting procedure is complete. Additionally, if the ignition is on (position 'II'), the message centre will display a message that the settings have been saved.

By repeating these three steps and pressing the unused button ('1' or '2'), a further driving position can be stored in the memory.

To set a new driving position, adjust to the desired position and perform steps 2 and 3. The previous memory will be erased and the new position will be set.

### Recalling a memorised position from the door switchpack

The gear selector lever in automatic transmission vehicles must be in 'P', and for manual transmission vehicles the parkbrake must be applied.

Press and release the appropriate memory button ('1' or '2'). The seat, steering column, pedals and door mirrors will move automatically to the memorised position.

## Memory recall using a key-ring transmitter

The key-ring transmitter will recall a memory position when the unlock button is pressed when set as follows:

1. Adjust the seat, steering column, pedals and exterior rear view mirrors to the desired positions.
2. Press the MEMORY button: The red LED will illuminate for a five second period.
3. Press any button on the key-ring transmitter and then press button '1' or '2'. Both button presses must occur while the red LED is illuminated.
4. Repeat for the other transmitter, pressing the remaining memory button.

To cancel key-ring transmitter memory recall:

1. Press the MEMORY button: The red LED will illuminate for a five second period.
2. Press any button on the key-ring transmitter (except the panic button, if fitted) then press the MEMORY button again. Both button presses must occur while the red LED is illuminated.

## Driving position memory system operating tips

- When making adjustments to a set driving position, reset the new position in the same memory channel.
- A driving position will only be memorised during the five second period when the red memory LED is illuminated.
- Previous memory is erased when a new driving position is entered.

## 3-30 Before driving

### Luggage compartment

**!** **WARNING:**

1. Locate heavy loads in the luggage compartment towards the front of the vehicle and secure them to stop them sliding. Loose items can be a hazard.
2. Do not drive with the luggage compartment lid open as exhaust fumes can be drawn into the passenger compartment.

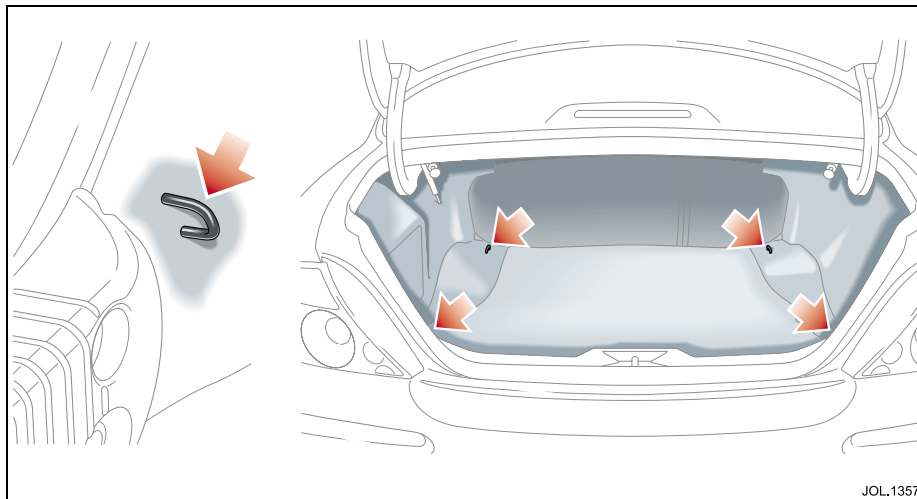

### Luggage tie-down loops

Four metal loops are positioned in the luggage compartment for attaching straps to secure loads and prevent them from sliding over the luggage floor.

These loops are not to be used for securing passengers or animals nor as anchorages for child restraints.

A range of Jaguar storage accessories, including a luggage retaining net, are available from your Dealer.

It is advisable to distribute luggage weight evenly over the entire luggage floor area, particularly to prevent permanent damage to the seat trim when a seat has been folded down.

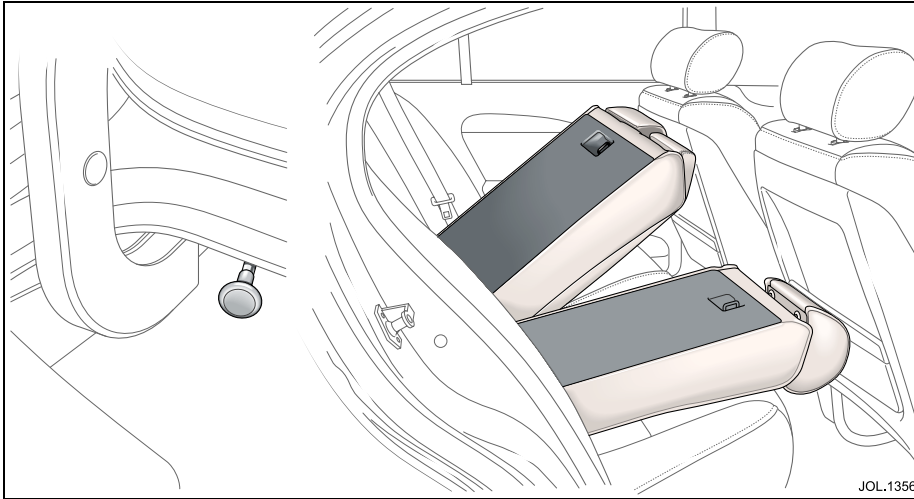

## Rear seat back fold down

To provide a longer luggage compartment area, the backs of the rear seat on most models can be folded down in two parts to give a 60/40 width split.

Release handles for each seat back are in the luggage compartment under the parcel shelf.

Pull the selected side handle to release the seat back and then fold it onto the seat cushion.

Ensure when folding the seat back down that the armrest is stowed and that there is sufficient clearance between the seat back, including the headrest, and the back of the front seat.

When returning the seat back to the upright position ensure that the seat belts are routed correctly and are not trapped by the seat back. Press the seat back firmly and check that it is locked securely into place.

## 3-32 Before driving

### Ski hatch

A two-door hatch is fitted to the rear seat on some models, providing an opening between the passenger and luggage compartments. This allows space for skis or similar objects to be stowed in the vehicle. Both doors have a single catch.

The inner door is accessible after folding down the armrest. To open the door, pull the leather flap forward, press the catch (A) downwards and gently lower the door on to the armrest.

A bag for retaining the skis can now be pulled from the receptacle into the passenger compartment, and the strap (C) loosened ready to accept the skis.

The other door is accessible from inside the luggage compartment and is opened by pushing the catch (B) and lowering the door.

Push the skis into the bag from the luggage compartment and then secure the skis using the strap provided on the bag. Clip the strap connector (D) to the centre rear seat belt buckle.

